

ROUTE NO.	SECTION	COUNTY	TOTAL SHEETS	SHEET NO.
FA.I. 80 (50-2)HBR	LA SALLE	460	204	
STA 242+00			TO STA 245+00	
FED. ROAD DIST. NO. 3	ILLINOIS	FED. AID PROJECT-		

CONTRACT NO. 86603

RAMP G

DATE	BY
REVISIONS	
1. CHECKED	
2. PLOTTED	
3. TEMPLATE	
4. AREAS CHECKED	
5. FINAL SURVEY	
6. NOTE BOOK	
7. NO.	

DATE	BY
REVISIONS	
1. CHECKED	
2. PLOTTED	
3. TEMPLATE	
4. AREAS CHECKED	
5. ORIGINAL SURVEY	
6. NOTE BOOK	
7. NO.	

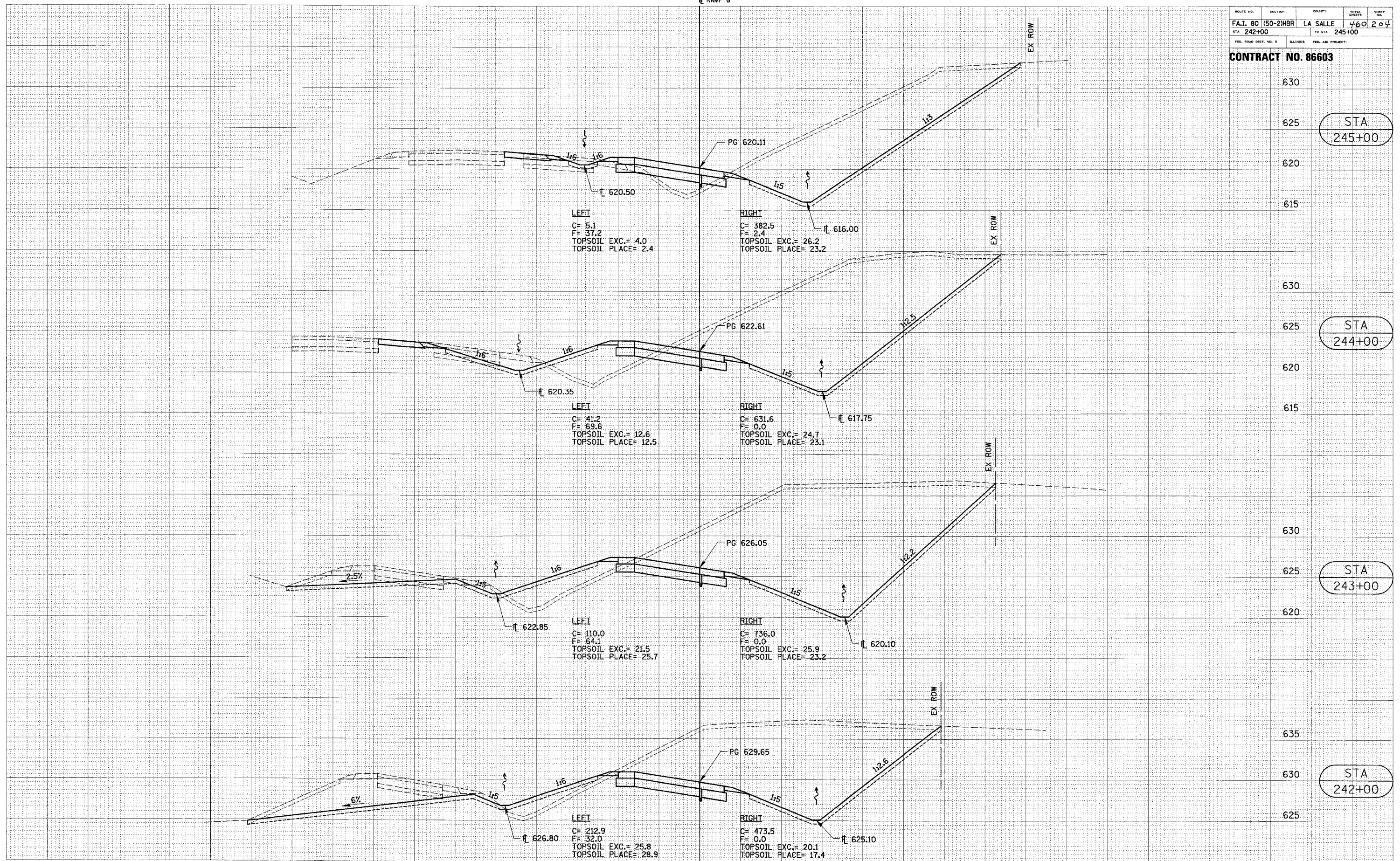

CROSS SECTIONS (RAMP G)

STA 245+00

STA 244+00

STA 243+00

STA 242+00