

STATE NO.	DISTRICT	COUNTY	SECTION	SHEET NO.
**		LASALLE	13	2
REL. ROAD DIST. NO. 7				
PLAN NO. PROJECT- ***				

** 03-00609-00-BR
 *** BRM-5044(9)
CONTRACT NO. 87294

GENERAL NOTES

- ALL ELEVATIONS SHOWN IN THE PLANS ARE BASED ON USGS MEAN SEA LEVEL DATUM.
- FOR STABILIZATION, ALL TYPE III BARRICADES SHALL REQUIRE A MINIMUM OF FOUR (4) SAND BAGS PER BARRICADE.
- SEEDING WILL NOT BE PERMITTED AT ANY TIME WHEN THE GROUND IS FROZEN, WET OR IN AN UNTILLABLE CONDITION. AREAS TO BE SEEDED SHALL BE DETERMINED.
- ANY REFERENCE TO A STANDARD IN THESE PLANS SHALL BE INTERPRETED TO MEAN THE EDITION AS INDICATED BY THE SUBNUMBER LISTED IN THE INDEX OF SHEETS OR THE COPY OF THE STANDARD INCLUDED IN THESE PLANS.
- THE THICKNESS OF BITUMINOUS MIXTURES SHOWN ON THE PLANS IS THE NOMINAL THICKNESS. DEVIATIONS FROM THE NOMINAL THICKNESS WILL BE PERMITTED WHEN SUCH DEVIATIONS OCCUR DUE TO IRREGULARITIES IN THE EXISTING SURFACE OR BASE ON WHICH THE BITUMINOUS MIXTURE IS PLACED.
- THE ENGINEER WILL BE THE SOLE JUDGE CONCERNING CURING TIME FOR THE VARIOUS BITUMINOUS LIFTS.
- WHERE SECTION OR SUBSECTION MONUMENTS ARE ENCOUNTERED, THE ENGINEER SHALL BE NOTIFIED BEFORE SUCH MONUMENTS ARE REMOVED. THE CONTRACTOR SHALL PROTECT AND CAREFULLY PRESERVE ALL MONUMENTS UNTIL AN AUTHORIZED SURVEY OR AGENT HAS WITNESSED OR OTHERWISE REFERENCED THEIR LOCATION. THE CONTRACTOR SHALL BE RESPONSIBLE FOR HAVING AN AUTHORIZED SURVEYOR REESTABLISH ANY SECTION OR SUBSECTION MONUMENTS DESTROYED BY HIS OPERATIONS.
- ABANDONED UNDERGROUND UTILITIES THAT CONFLICT WITH CONSTRUCTION SHALL BE DISPOSED OF OUTSIDE THE LIMITS OF THE RIGHT OF WAY ACCORDING TO ARTICLE 202.03 OF THE STANDARD SPECIFICATIONS AND AS DIRECTED BY THE ENGINEER. THIS WORK WILL NOT BE PAID FOR SEPARATELY, BUT SHALL BE INCLUDED IN THE COST OF EARTH EXCAVATION.
- THE FOLLOWING RATES OF APPLICATION HAVE BEEN USED IN CALCULATING PLAN QUANTITIES:

GRANULAR MATERIALS	2.05	TONS / CU YD
BITUMINOUS MAT PRIME COAT	0.08	GAL / SQ YD
	0.375	GAL / SQ YD
BITUMINOUS CONCRETE SURF CSE	112	LBS / SQ YD / IN
LEVEL BINDER (MACHINE METHOD)	112	LBS / SQ YD / IN
NITROGEN FERTILIZER NUTRIENT	90	LBS / ACRE (SEEDING)
PHOSPHOROUS FERTILIZER NUTRIENT	90	LBS / ACRE (SEEDING)
POTASSIUM FERTILIZER NUTRIENT	90	LBS / ACRE (SEEDING)

- UTILITIES WHO MAY BE WITHIN THE LIMITS OF THE IMPROVEMENT ARE:
- | UTILITY | FINAL PLANS SENT | RELOCATION STATUS |
|-----------------|------------------|---|
| CITY OF MENDOTA | 10/15/04 | TO BE RELOCATED AS PART OF THIS PROJECT |
| COMED | 10/15/04 | TO BE RELOCATED PRIOR TO CONSTRUCTION |
| NICOR | 10/15/04 | TO BE RELOCATED PRIOR TO CONSTRUCTION |
| VERIZON | 10/15/04 | TO BE RELOCATED PRIOR TO CONSTRUCTION |
- ONLY THOSE TREES DESIGNATED BY THE ENGINEER OR LISTED IN THE TREE REMOVAL SCHEDULE SHALL BE REMOVED. THE CONTRACTOR SHALL PROTECT ALL REMAINING TREES FROM DAMAGE DUE TO HIS OPERATIONS.
 - AGGREGATE (PRIME COAT): FA20 MAY BE USED IN ADDITION TO THE GRADATIONS LISTED IN THE 2ND PARAGRAPH OF ARTICLE 1003.03(c).
 - THE FINISHED EARTHWORK SHALL HAVE A VEGETATIVE SUSTAINING SOIL COVERING THE TOP 4 INCHES IN AREA TO BE SEEDED. THE VEGETATIVE SUSTAINING SOIL WILL NOT BE PAID FOR SEPARATELY BUT SHALL BE INCLUDED IN THE COST OF EMBANKMENT.

	SURFACE COURSE SUPERPAVE	BINDER COURSE SUPERPAVE
PG GRADE	PG58-22	PG58-22
MAX % RAP ALLOWABLE	0%	0%
DESIGN AIR VOIDS	4.0% @ N50	4.0% @ N50
MIXTURE COMPOSITION	IL-19.0	IL-19.0
FRICTION AGGREGATE	MIXTURE C	--

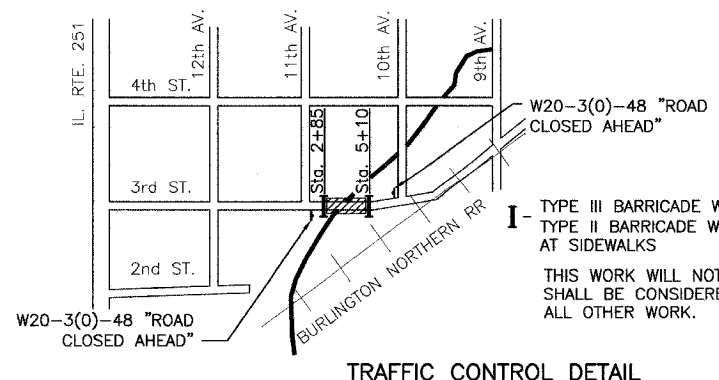
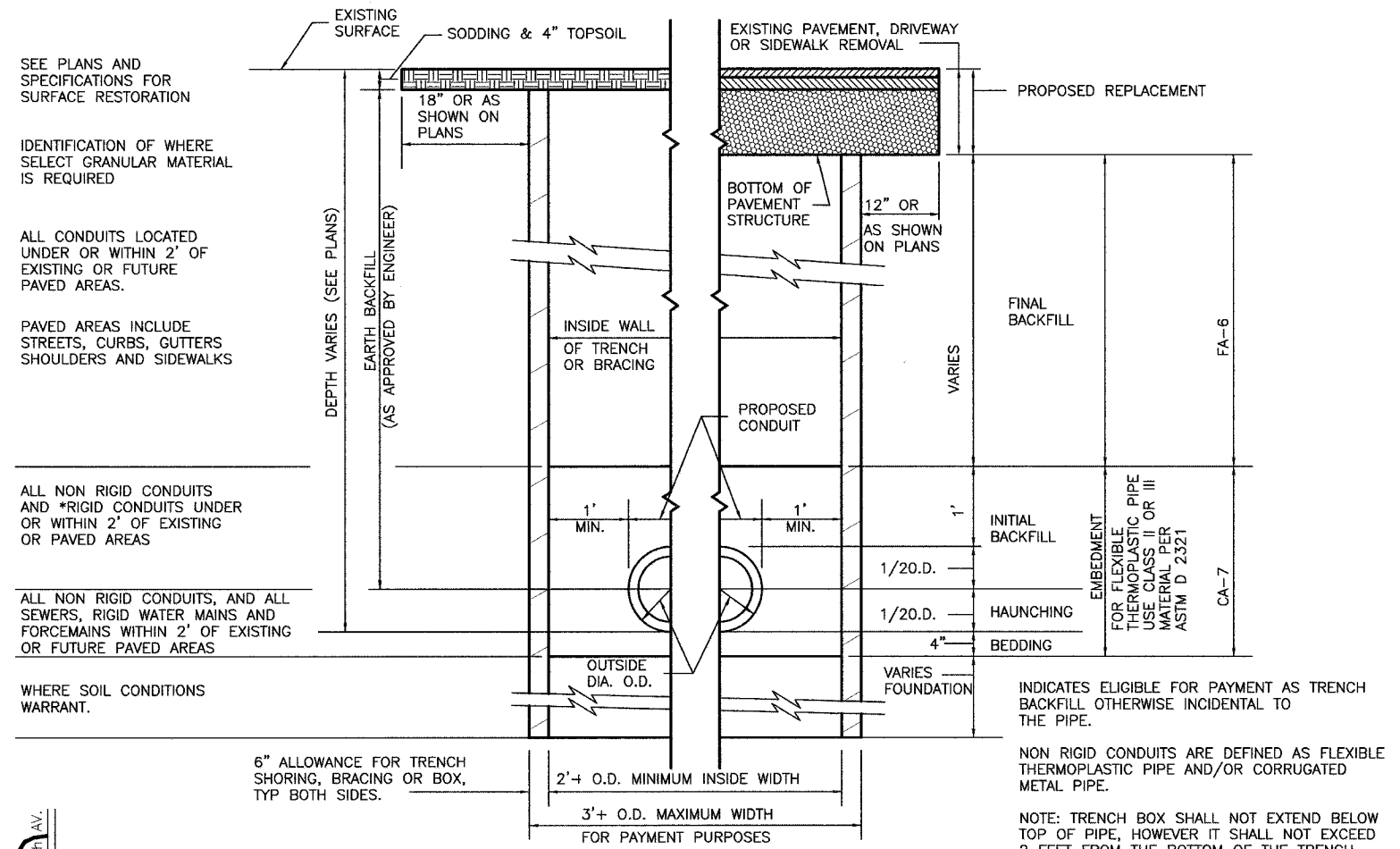
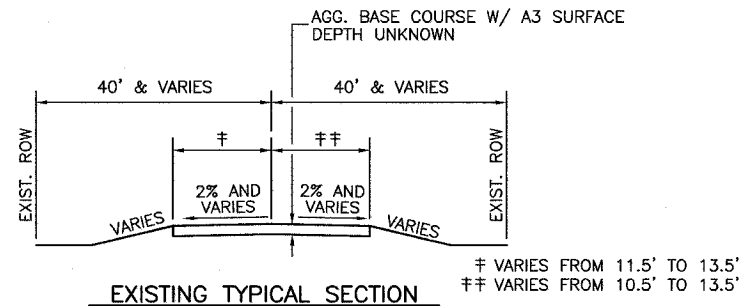
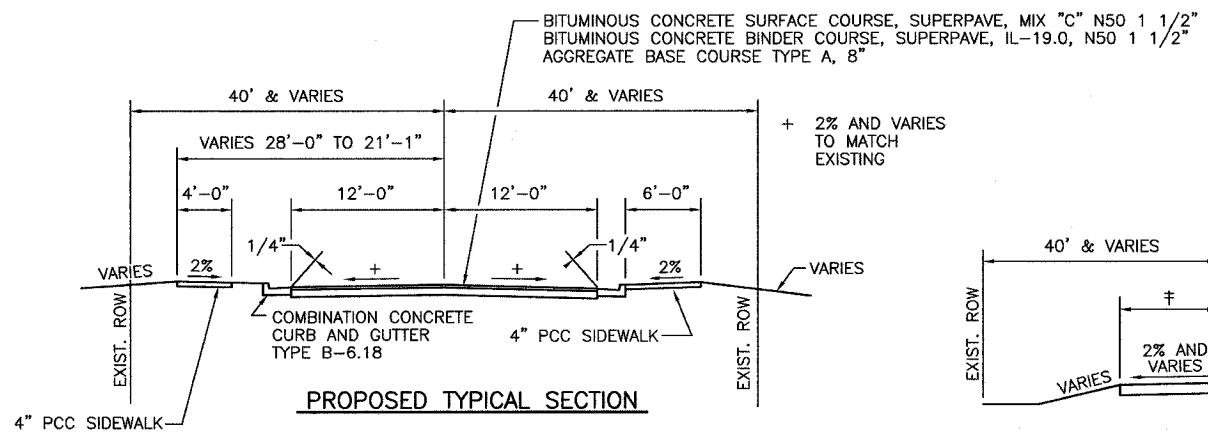

GENERAL NOTES AND TYPICAL SECTIONS
3RD STREET
OVER MENDOTA CREEK
SECTION 03-00609-00-BR
LASALLE COUNTY
STA. 3+97.85
SN 050-7015