

Contract # 91231

RTE. NO.	SECTION	COUNTY	TOTAL SHEETS	SHEET NO.
TR 408	97-21117-00-BR	SHELBY	12	1

INDEX OF SHEETS

- 1 COVER SHEET
- 2 SUMMARY OF QUANTITIES, TYPICAL CROSS SECTIONS, AND GENERAL NOTES
- 3 PLAN AND PROFILE
- 4-7 STRUCTURE PLANS
- 8-11 CROSS SECTIONS HIGHWAY STANDARDS
- 12 EROSION CONTROL PLAN STANDARDS

000001-04 ABBREVIATIONS AND SYMBOLS

280001-02 EROSION CONTROL SYSTEMS, TEMPORARY

515001-02 NAME PLATE FOR BRIDGES

702001-05 TRAFFIC CONTROL DEVICES

BLR-21-6 TYPICAL APPLICATION OF TRAFFIC CONTROL DEVICES FOR CONSTRUCTION ON RURAL LOCAL HIGHWAYS

SEE PROPOSAL FOR BORING LOG DATA.

**STATE OF ILLINOIS
SHELBY COUNTY HIGHWAY DEPARTMENT**

**PLANS FOR PROPOSED IMPROVEMENT
SIGEL TOWNSHIP**

TOWNSHIP ROAD 408 / SECTION 97-21117-00-BR

REHABILITATION AND REPLACEMENT BRIDGE PROGRAM

PROJECT NUMBER BR-OS-173(108)

JOB NUMBER C-95-026-01

RANGE 6 E., 3RD. P.M.

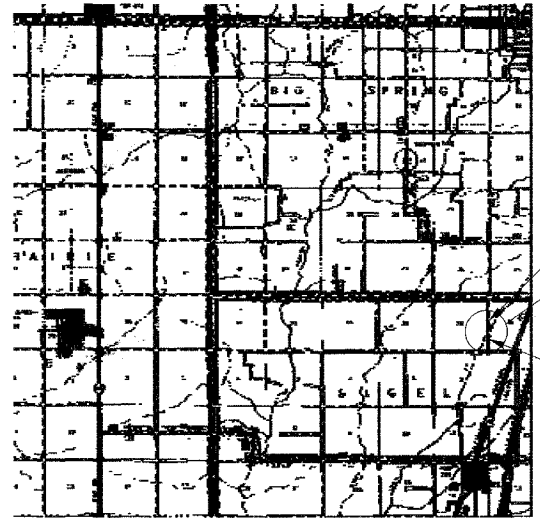

IMPROVEMENT ENDS
STA. 10+100.000

STA. 10+000.000
SPECIAL BRIDGE DESIGN
SINGLE SPAN P.P.C. DECK
BEAM DEPTH - 686 mm
BEAM LENGTH - 17.890m
SKEW = 20°00'00" R.F.
STRUCTURE NO. 0873504

IMPROVEMENT BEGINS
STA. 9+870.000

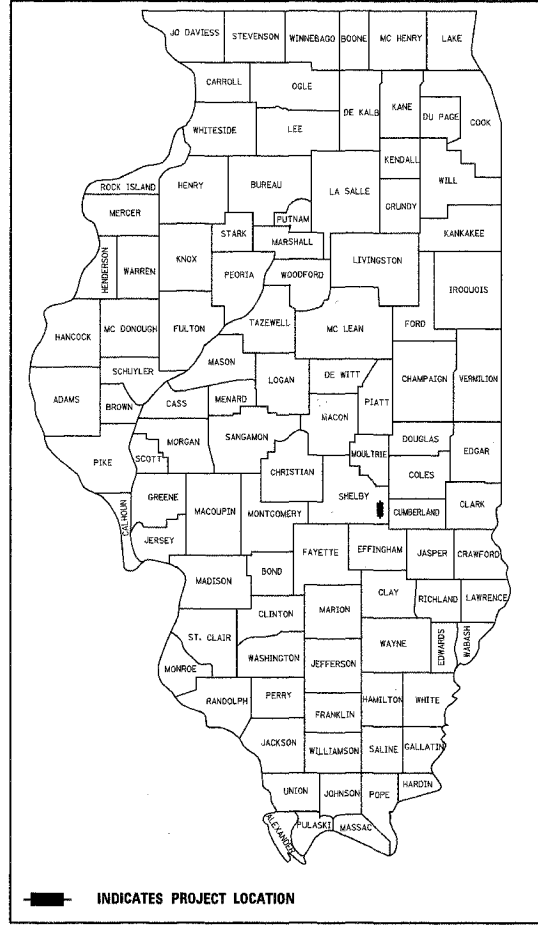

LOCATION MAP

APPROXIMATE SCALE: 1cm = 0.633 km
NET LENGTH OF LOCATION : 220.000 METERS = 0.220 KILOMETERS

SCALES

PLAN 1 : 500
PROFILE HORIZONTAL 1 : 500
PROFILE VERTICAL 1 : 100

FUNCTIONAL CLASSIFICATION

LOCAL ROAD DESIGN (CURRENT A.D.T. 0-250)
A.D.T. < 150

PLANS UPDATED BY:

S. Alan Spesard
S. ALAN SPESARD
C.O. ENG. 10-19-04
EXPIRES 11-2005

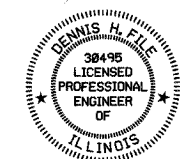

Dennis H. Fite
DENNIS H. FITE
ILLINOIS PROFESSIONAL ENGINEER NO. 062-030495 EXPIRES 11-30-03

APPROVED: Oct 19, 2004
 Eugene Wack
Sigel Township Road Commissioner

APPROVED: oct 20, 2004
 S. Alan Spesard
Shelby County Engineer

APPROVED: 11/1, 2004
 David A. Gaud
District Engineer of Local Roads & Streets

APPROVED: Nov 4, 2004
 S. Alan Spesard
District Engineer

STATE OF ILLINOIS
DEPARTMENT OF TRANSPORTATION

CONTRACT NO: 91231

FOR JOINT UTILITY LOCATION INFORMATION FOR EXCAVATORS CALL TOLL FREE 1-800-892-0123



April 8, 2003
C:\comp\cover.dgn