

RTE.	SECTION	COUNTY	TOTAL SHEETS	SHEET NO.
C.H. 11	*	MENARD	44+3	1
PROJECT Sr-565(110)			47	
* 98-00047-00-RS				

STATE OF ILLINOIS
DEPARTMENT OF TRANSPORTATION

PLANS FOR PROPOSED
SURFACE TRANSPORTATION PROGRAM-RURAL
F.A.S. ROUTE 565 - QUARRY ROAD (C.H. 11)
PROJECT SR-565(110)
SECTION 98-00047-00-RS
MENARD COUNTY
JOB NO. C-96-211-00

INDEX OF SHEETS

- 1 - TITLE SHEET
- 2 - SUMMARY OF QUANTITIES, SCHEDULES & TYPICAL SECTIONS
- 3 - INTERSECTION DETAILS,
- 4 - ENTRANCE DETAILS, SCHEDULES & TYPICAL SECTIONS
- 5 - SCHEDULES
- 6 - BRIDGE REHABILITATION DETAILS
- 7 - 13 - CROSS ROAD CULVERT DETAILS
- 14 - 23 - PLAN & PROFILE
- 24 - 44 - CROSS SECTIONS

STANDARDS

- STANDARD 280001-02
- STANDARD 420001-05
- STANDARD 420101-02
- STANDARD 420401-05
- STANDARD 542101
- STANDARD 542201
- STANDARD 602306
- STANDARD 630001-05
- STANDARD 630101-05
- STANDARD 630301-03
- STANDARD 631026-02
- STANDARD 635006-02
- STANDARD 666001
- STANDARD 701006-02
- STANDARD 701011-01
- STANDARD 701201-02
- STANDARD 701301-02
- STANDARD 701306-01
- STANDARD 701311-02
- STANDARD 701501-03
- STANDARD 702001-05
- STANDARD 780001-01
- STANDARD BLR 21-6
- STANDARD BLR 23-1
- STANDARD BLR 24-1
- STANDARD 606201

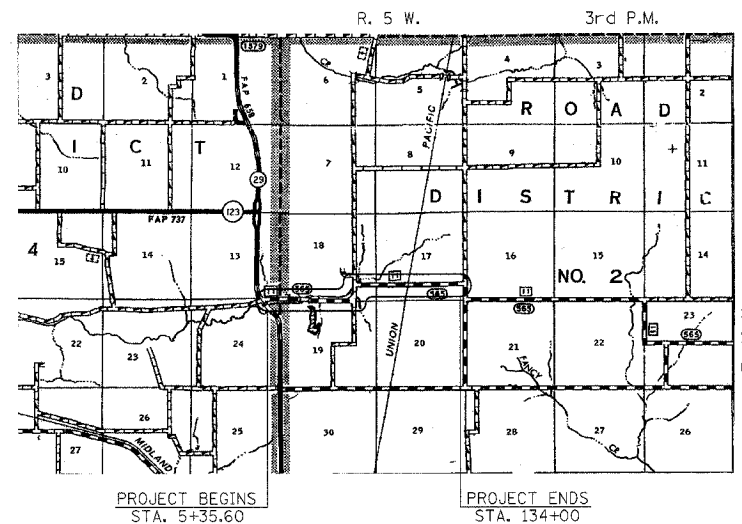
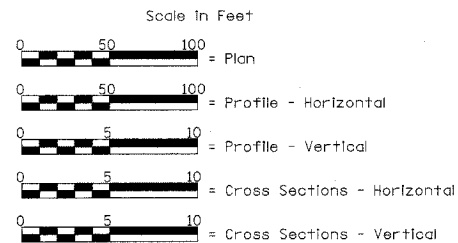

PROJECT DESCRIPTION: 2281.15' NEW P.C.C. PAVEMENT AND 10490.25' OF 8" BITUMINOUS OVERLAY 22'-0" WIDE WITH 4'-0" BITUMINOUS OR AGGREGATE SHOULDERS. TWO NEW 'T' INTERSECTIONS, CULVERT REHABILITATION, CULVERT REPLACEMENT AND OTHER INCIDENTAL ROADWAY ITEMS OF WORK.

LOCATION PLAN

Length of Section - 12864.40 Feet = 2.436 Miles

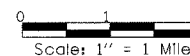

Design Class: Major Collector (Non-Urban)

A.D.T. = 900 (1999) } C.H. 11 EAST OF IL. 29
A.D.T. = 1035 (2013)

A.D.T. = 500 (1999) } C.H. 11 (EAST OF QUARRY TO T.R. 158)
A.D.T. = 575 (2013)

A.D.T. = 300 (1999) } C.H. 11 (T.R. 158 TO T.R. 164)
A.D.T. = 345 (2013)

50 M.P.H. Design Speed
3R GUIDELINES

CONTRACT NO. 93370

FOR J.U.L.I.E. NOTIFICATION PURPOSES THIS PROJECT IS LOCATED IN 'NORTH ATHENS' TOWNSHIP

TOLL FREE
"JOINT UTILITY LOCATION INFORMATION FOR EXCAVATORS"
(J.U.L.I.E.) TELEPHONE NUMBER
1-800-892-0123

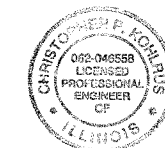

Christopher P. Kohlman 2/3/04
EXPIRATION DATE: 11/30/05

STATE OF ILLINOIS
DEPARTMENT OF TRANSPORTATION

APPROVED: Feb 2 2004
Thomson R. Cannon
COUNTY ENGINEER

PASSED: Aug 07 2004
William E. Martens, III
DISTRICT ENGINEER OF LOCAL ROADS & STREETS

APPROVED: MAR 9 2004
W.P. Jung
DISTRICT CONSTRUCTION ENGINEER

APPROVED: March 17 2004
Curt W. Reed
DISTRICT ENGINEER

FILE NAME: MCATTIS (REV. 1/21/04)