

RTE.	SECTION	COUNTY	TOTAL SHEETS	SHEET NO.
C.H. 11	*	MENARD	44	30
PROJECT 98-00047-00-R5				

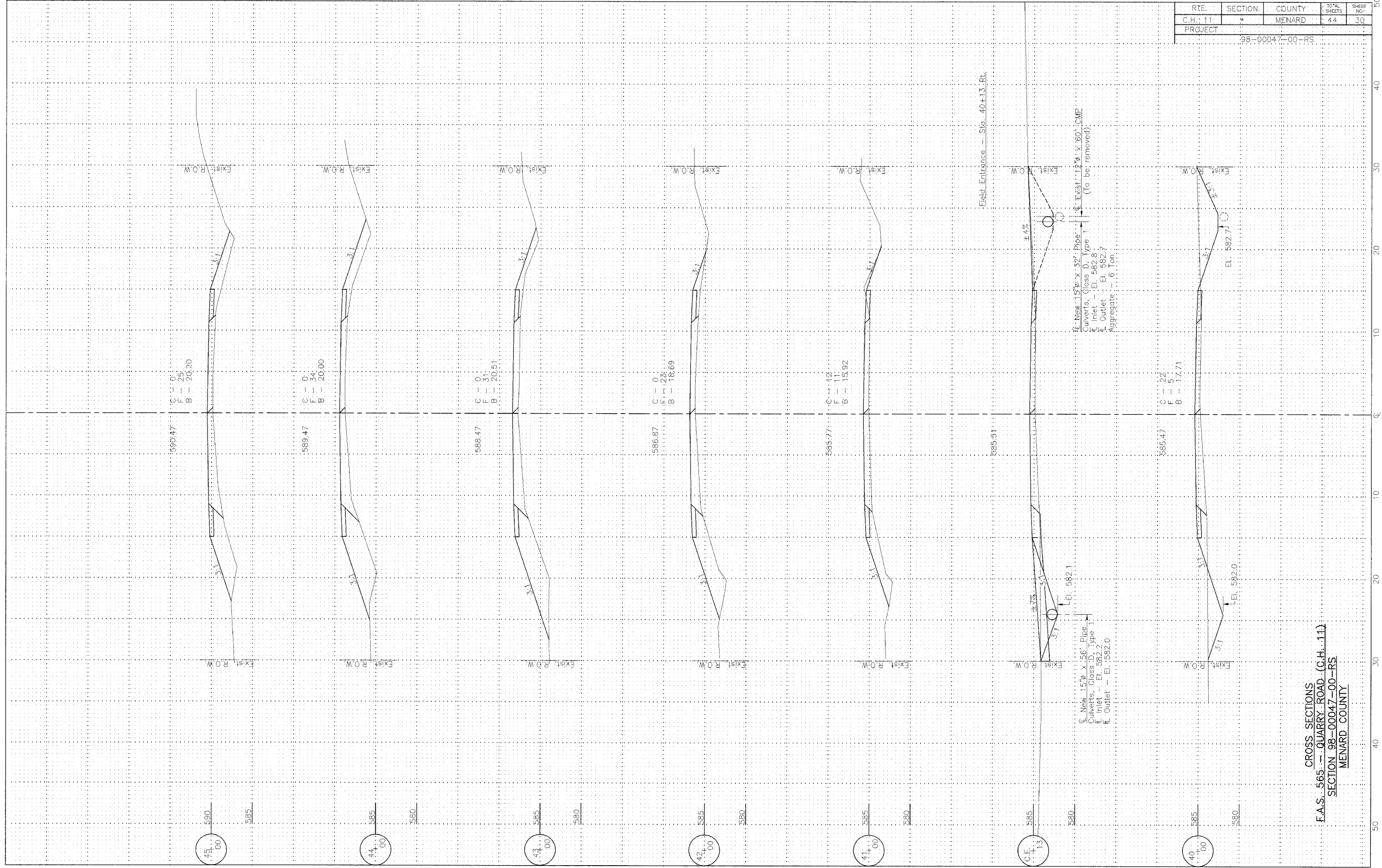

C. New 15" x 32" Pipe
 Culverts, Class D, Type 1
 L Inlet - El. 582.8
 L Outlet - El. 582.7
 Aggregate - 6 Ton

C. New 15" x 56" Pipe
 Culverts, Class D, Type 1
 L Inlet - El. 582.2
 L Outlet - El. 582.0

CROSS SECTIONS
 F.A.S. 565 - QUARRY ROAD (C.H. 11)
 SECTION 98-00047-00-R5
 MENARD COUNTY