

RTE.	SECTION	COUNTY	TOTAL SHEETS	SHEET NO.
C.H. 11	*	MENARD	44	40
PROJECT SR-565(110)				
98-00047-00-RS				

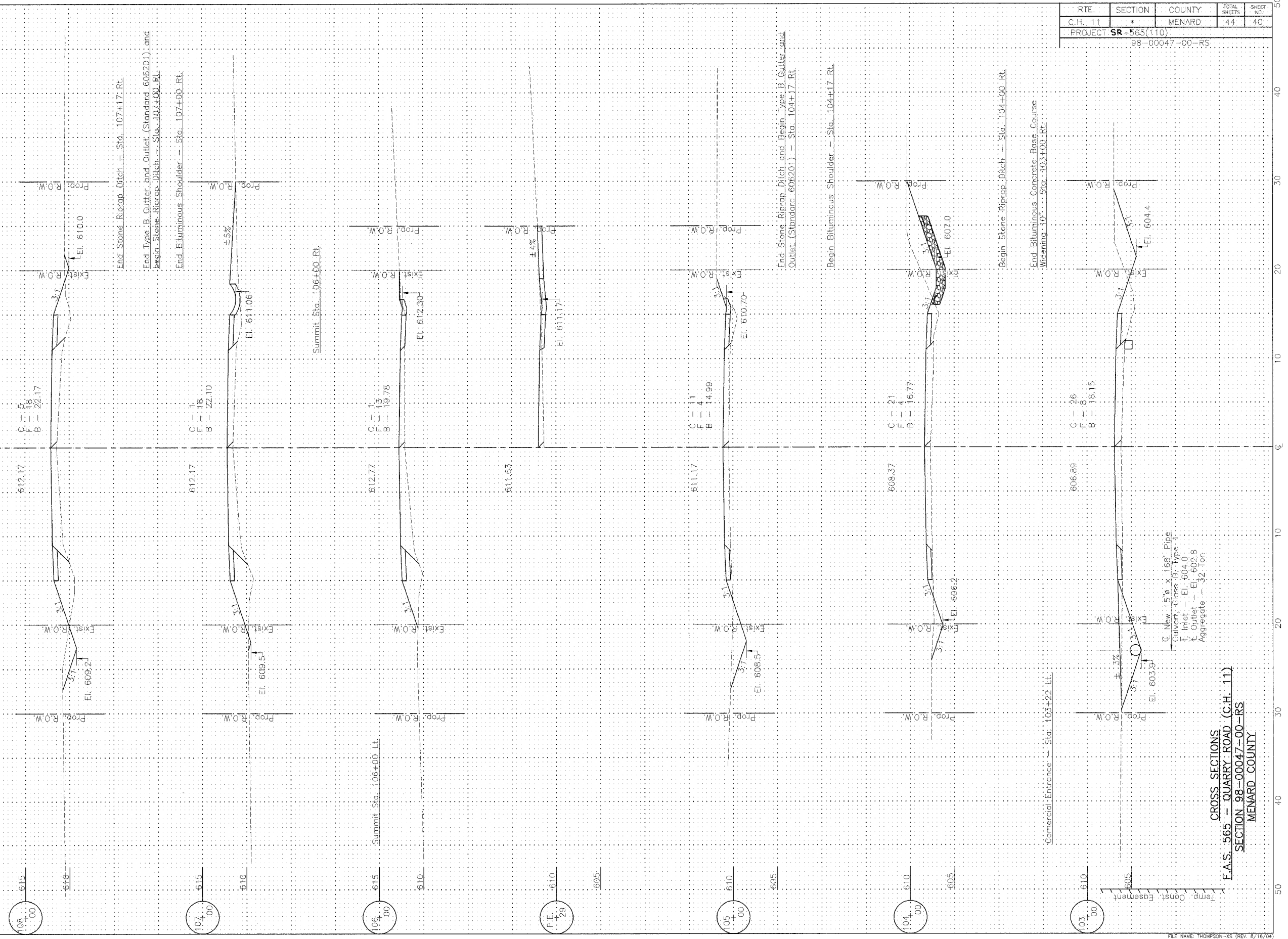

CROSS SECTIONS
 F.A.S. 565 - QUARRY ROAD (C.H. 11)
 SECTION 98-00047-00-RS
 MENARD COUNTY

- ⊕ New 15" x 168" Pipe
- ⊕ Culvert - Class II, Type I
- ⊕ Inlet - El. 604.0
- ⊕ Outlet - El. 602.8
- ⊕ Aggregate - 3/2 Ton