

RTE.	SECTION	COUNTY	TOTAL SHEETS	SHEET NO.
C.H. 11	*	MENARD	44	43
PROJECT SR-565(110)				
98-00047-00-R5				

Summit Sta. 128+00 Lt. & Rt.

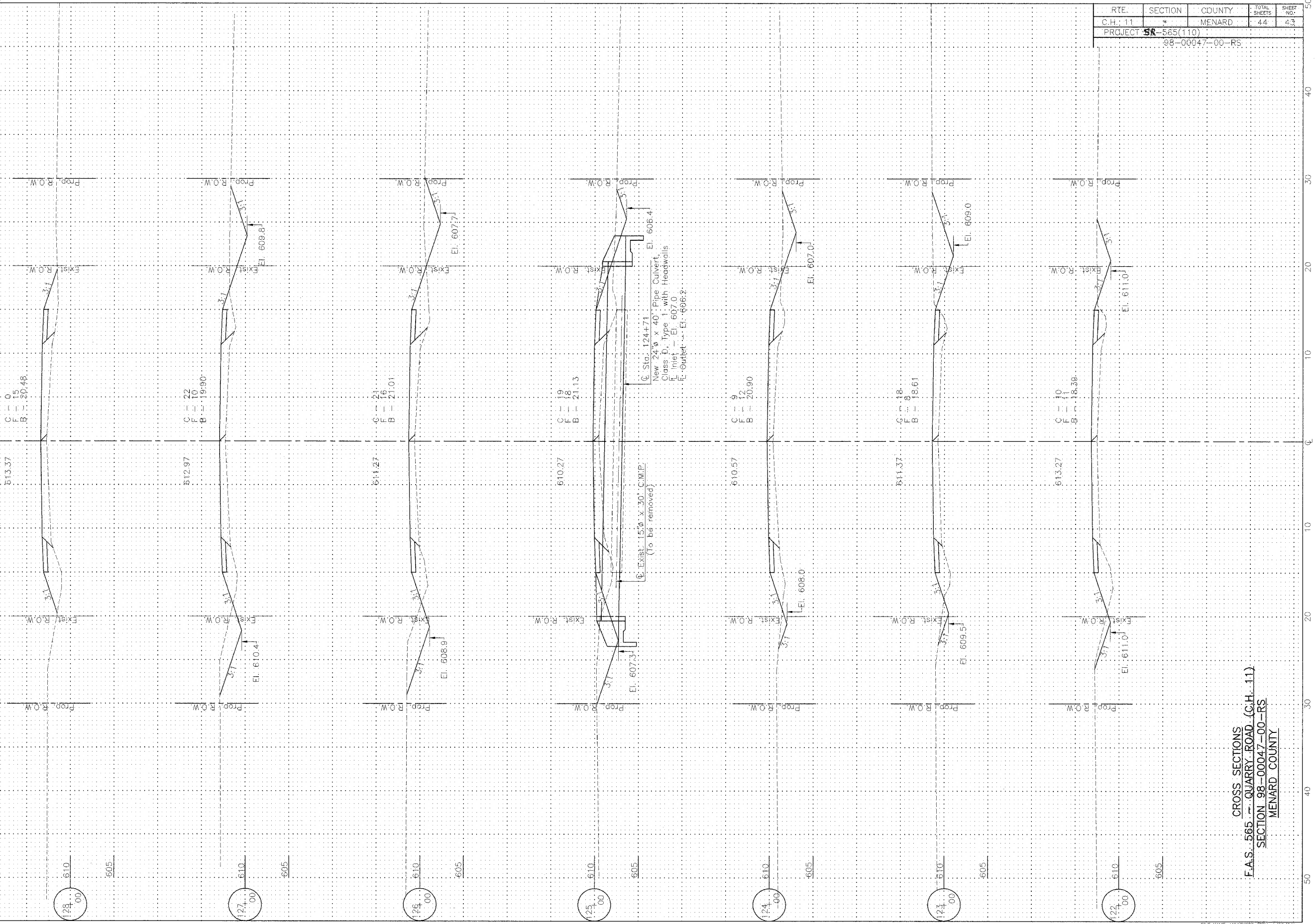

CROSS SECTIONS
 F.A.S. 565 - QUARRY ROAD (C.H. 11)
 SECTION 98-00047-00-R5
 MENARD COUNTY