

F.A.P. RTE.	SECTION	COUNTY	TOTAL SHEETS	SHEET NO.
774		EFFINGHAM	344	54
FED. ROAD DIST. NO. 7		ILLINOIS	FED. AID PROJECT	
107WRS-1, 107BY, 107BY-1 & 107B-2		CONTRACT NO. 94827		

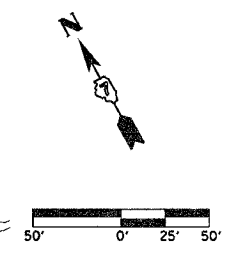
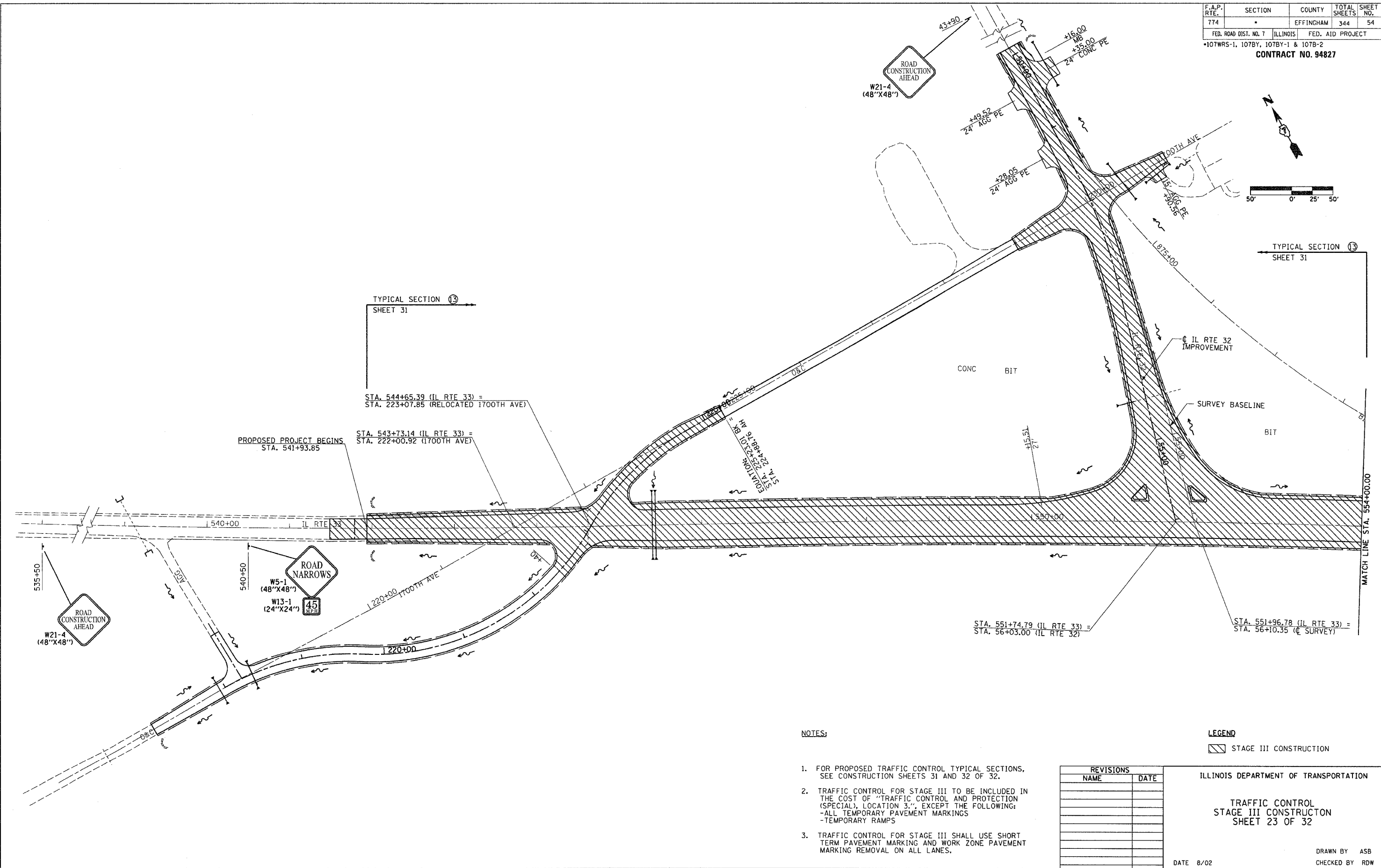

TYPICAL SECTION 13  
SHEET 31

STA. 544+65.39 (IL RTE 33) =  
STA. 223+07.85 (RELOCATED 1700TH AVE)

PROPOSED PROJECT BEGINS  
STA. 541+93.85

STA. 543+73.14 (IL RTE 33) =  
STA. 222+00.92 (1700TH AVE)

STA. 551+74.79 (IL RTE 33) =  
STA. 56+03.00 (IL RTE 32)

STA. 551+96.78 (IL RTE 33) =  
STA. 56+10.35 (C SURVEY)

NOTES:

- FOR PROPOSED TRAFFIC CONTROL TYPICAL SECTIONS, SEE CONSTRUCTION SHEETS 31 AND 32 OF 32.
- TRAFFIC CONTROL FOR STAGE III TO BE INCLUDED IN THE COST OF "TRAFFIC CONTROL AND PROTECTION (SPECIAL), LOCATION 3.", EXCEPT THE FOLLOWING:  
-ALL TEMPORARY PAVEMENT MARKINGS  
-TEMPORARY RAMPS
- TRAFFIC CONTROL FOR STAGE III SHALL USE SHORT TERM PAVEMENT MARKING AND WORK ZONE PAVEMENT MARKING REMOVAL ON ALL LANES.

LEGEND

▨ STAGE III CONSTRUCTION

REVISIONS	
NAME	DATE

ILLINOIS DEPARTMENT OF TRANSPORTATION

TRAFFIC CONTROL  
STAGE III CONSTRUCTION  
SHEET 23 OF 32

DATE 8/02  
DRAWN BY ASB  
CHECKED BY RDW