

FAP RTE.	SECTION	COUNTY	TOTAL SHEETS	SHEET NO.
774	*	EFFINGHAM	344	146C
FED. ROAD DIST. NO. 7		ILLINOIS	FED. AID PROJECT NO.	

CONTRACT NO. 94827  
 \* 107WRS-1, 104BY, 107BY-1, 107B-2

\$USER\$  
 \$DATE\$  
 \*DGN-SPEC\*

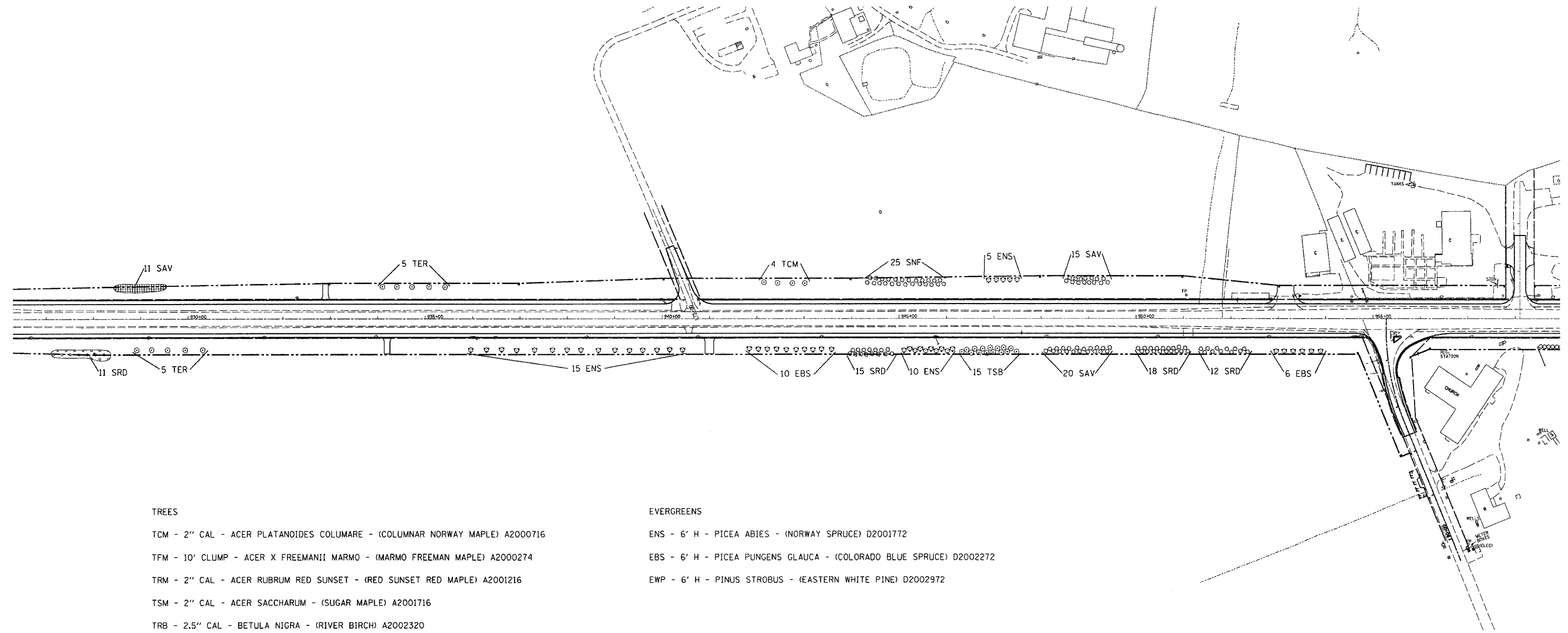



TREES

- TCM - 2" CAL - ACER PLATANOIDES COLUMARE - (COLUMNAR NORWAY MAPLE) A2000716
- TFM - 10' CLUMP - ACER X FREEMANII MARMO - (MARMO FREEMAN MAPLE) A2000274
- TRM - 2" CAL - ACER RUBRUM RED SUNSET - (RED SUNSET RED MAPLE) A2001216
- TSM - 2" CAL - ACER SACCHARUM - (SUGAR MAPLE) A2001716
- TRB - 2.5" CAL - BETULA NIGRA - (RIVER BIRCH) A2002320
- TNC - 2" CAL - CATALPA SPECIOSA - (NORTHERN CATALPA) A2002816
- TSB - 5' CLUMP - AMELANCHIER LAEVIS - (ALLEGHENY SERVICEBERRY) B2000964
- TER - 2" CAL - CERCIC CANADENSIS - (EASTERN REDBUD) B2001116
- TBC - 2" CAL - TAXODIUM DISTICHUM - (COMMON BALD CYPRESS) A2007616

EVERGREENS

- ENS - 6' H - PICEA ABIES - (NORWAY SPRUCE) D2001772
- EBS - 6' H - PICEA PUNGENS GLAUCA - (COLORADO BLUE SPRUCE) D2002272
- EWP - 6' H - PINUS STROBUS - (EASTERN WHITE PINE) D2002972

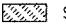
SHRUBS

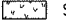
-  SRD - 3' H - CORNUS SERICEA - (REDOSIER DOGWOOD) C2C01636
-  SNF - 3' H - FORSYTHIA NORTHERN SUN - (NORTHERN SUN BORDERFORSYTHIA) C2C03036
-  SAV - 2.5' H - VIBERNUM DENTATUM MORTON - (NORTHERN BURGUNDY ARROWWOOD VIBERNUM) C2C11830
-  SPJ - 3' W - JUNIPERUS CHINENSIS PFITZER ANA COMPACT - (COMPACT PFITZER JUNIPER) D2000536

REVISIONS	
NAME	DATE

ILLINOIS DEPARTMENT OF TRANSPORTATION  
**LANDSCAPING PLAN**  
**SHEET 3 OF 7**  
 SCALE: VERT.     DRAWN BY DIST 7  
           HORIZ.     CHECKED BY DIST 7  
 DATE