

STATE OF ILLINOIS DEPARTMENT OF TRANSPORTATION DIVISION OF HIGHWAYS PLANS FOR PROPOSED BRIDGE REPLACEMENT AND REHABILITATION PROGRAM

ROUTE NO. F.A.S. 2821	SECTION 98-16119 -00-BR	COUNTY WAYNE	SHEET 13	SHEET 1
FED. ROAD DIST. NO.		ILLINOIS FED. AID PROJECT-		
CONTRACT NO. 95415				

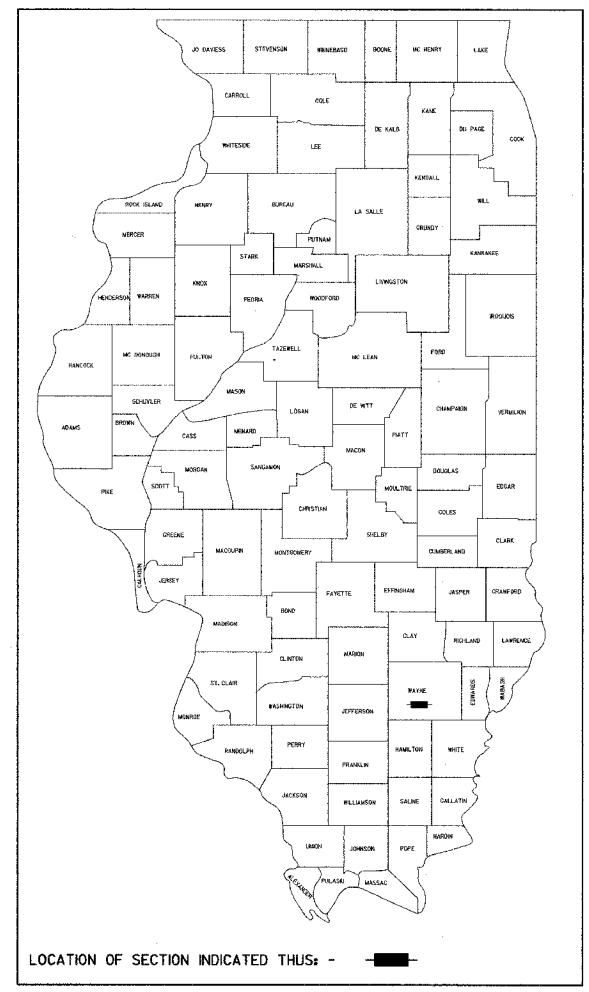

- INDEX OF SHEETS**
1. COVER SHEET
 2. SUMMARY OF QUANTITIES AND TYPICAL CROSS SECTIONS
 3. PLAN AND PROFILE
 - 4.-6. STATION CROSS SECTIONS
 - 7.-12. BRIDGE PLANS
 13. BORINGS
- HIGHWAY STANDARDS:**
- 000001-04 STANDARD SYMBOLS, ABBREVIATIONS AND PATTERNS
 - 515001-02 NAME PLATE FOR BRIDGES
 - 630301-03 SHOULDER WIDENING FOR TYPE 1, (SPECIAL) GUARDRAIL TERMINALS
 - 631026-02 TRAFFIC BARRIER TERMINAL, TYPE 5 & 5A
 - 702001-05 TRAFFIC CONTROL DEVICES
 - BLR 21-6 TYPICAL APPLICATION OF TRAFFIC CONTROL DEVICES FOR CONSTRUCTION ON RURAL LOCAL HIGHWAYS

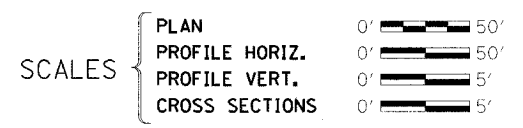

PROJECT BROS-0191(047) SECTION 98-16119-00-BR MASSILON ROAD DISTRICT WAYNE COUNTY F.A.S. 2821 / TR 283 JOB NO. C-97-068-04

UTILITIES
WABASH TELEPHONE
P.O. BOX 299
LOUISVILLE, ILLINOIS 62858

STA. 9+91 - SPECIAL BRIDGE DESIGN
PRECAST PRESTRESSED CONCRETE DECK BEAM
BRIDGE. THREE SPANS: 20'-0", 36'-0", 20'-0"
24'-0" RDWY. SKEW = 35°
EXIST. STR. NO. 096-3367
PROP. STR. NO. 096-3435

IMPROVEMENT BEGINS
STATION 6+50

IMPROVEMENT ENDS
STATION 13+50

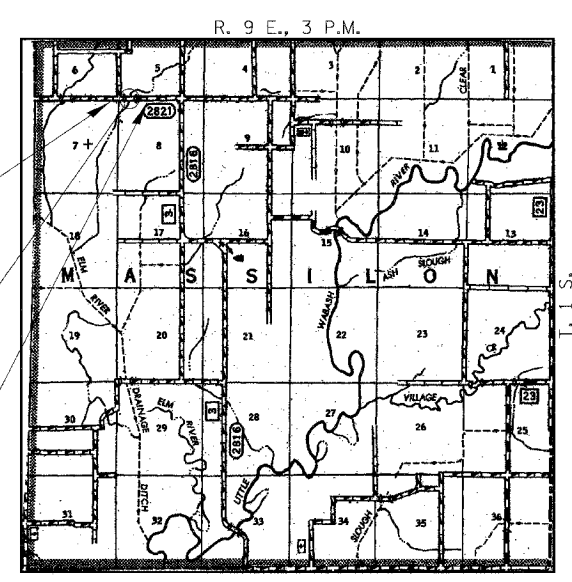

LAYOUT
APPROXIMATE SCALE: 0 1 MILE
NET LENGTH OF SECTION = 700 FEET = 0.133 MILES

THE ACCEPTANCE OF THIS PROJECT IS BASED ON THE MINIMUM DESIGN CRITERIA FOR A FEDERAL AID BRRP TYPE IMPROVEMENT.
Maureen E. Kastl
DISTRICT ENGINEER OF LOCAL ROADS & STREETS

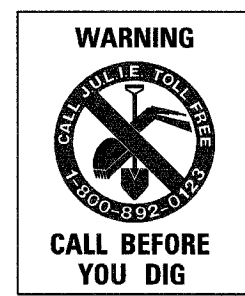

APPROVED October 7 2004
Carol Bunnage
ROAD DISTRICT COMMISSIONER

APPROVED October 6 2004
Arthur J. Kolbach
COUNTY ENGINEER

PASSED 10-9 2004
Maureen E. Kastl
STREETS

APPROVED October 11 2004
Steve E. Smith
DISTRICT ENGINEER
STATE OF ILLINOIS
DEPARTMENT OF TRANSPORTATION

DESIGN FUNCTIONAL CLASSIFICATION:
MAJOR COLLECTOR 0-250 ADT
DESIGN TRAFFIC: 75 ADT
DESIGN SPEED: 40 M.P.H.

CONTRACT NO. 95415

DATE: October 3, 2004
By: *Steve Magon*
LICENSE EXPIRES: NOVEMBER 30, 2005

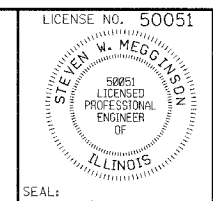

Rice, Berry and Associates
A Division of Hampton, Lenzini and Renwick, Inc.
Civil & Structural Engineers
801 S. Durkin Drive
Springfield, Illinois 62704
217-546-3400
608 1/2 Eastgate Dr.
Carbondale, Illinois 62901
618-457-1116