

STATE OF ILLINOIS
DEPARTMENT OF TRANSPORTATION
DIVISION OF HIGHWAYS

**PROPOSED
HIGHWAY PLANS**

F.A.S. ROUTE 1887 (OLD IL 13)
SECTION 6B-1

PROJECT: *BRS-1887(104)*
WILLIAMSON COUNTY
C-99-039-04

**STRUCTURE REPLACEMENT OVER BRANCH OF
CRAB ORCHARD CREEK**

F.A.S. RTE.	SECTION	COUNTY	TOTAL SHEETS	SHEET NO.
1887	6B-1	WILLIAMSON	27	1

CONTRACT NUMBER 98655

FOR INDEX OF SHEETS, SEE SHEET NO. 2

D-99-022-02



PROPOSED SECTION 6B-1 ENDS
STA 263+25

PROPOSED SECTION 6B-1 BEGINS
STA 262+55

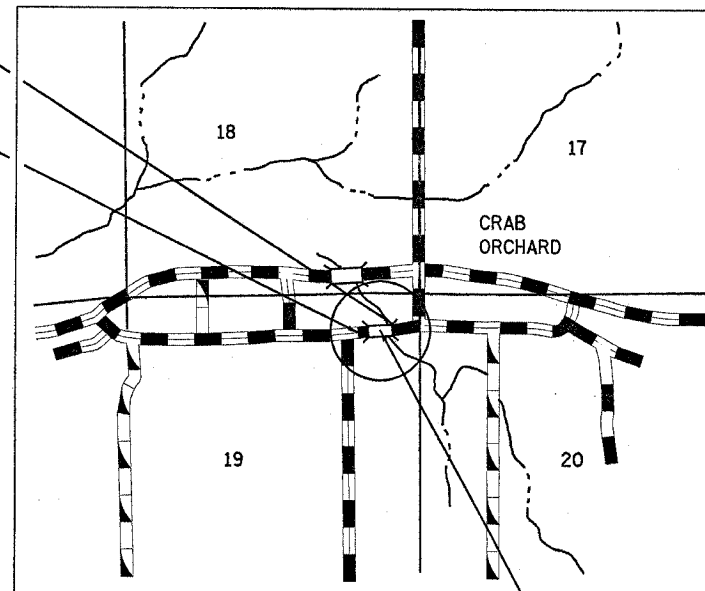

PROPOSED BOX CULVERT
OVER BRANCH OF CRAB ORCHARD CREEK
STRUCTURE NO. 100-2021
TRIPLE BARREL 8' X 7' X 34'-8" BOX CULVERT;
CENTERLINE STR STA 262+90
EXISTING SN 100-0048

TRAFFIC DATA

2004 ADT = 850
8.2% TRUCKS
POSTED SPEED 55 MPH

TOWNSHIP: CRAB ORCHARD



FULL SIZE PLANS HAVE BEEN PREPARED USING STANDARD
ENGINEERING SCALES. REDUCED SIZED PLANS WILL NOT
CONFORM TO STANDARD SCALES. IN MAKING MEASUREMENTS
ON REDUCED PLANS, THE ABOVE SCALES MAY BE USED.

J.U.L.I.E.
JOINT UTILITY LOCATION INFORMATION FOR EXCAVATION
1-800-892-0123 OR WWW.JULIE1CALL.COM

CONTRACT NO. 98655

SECTION 6B-1

ROADWAY LENGTH = 43.5 FT
BOX CULVERT LENGTH = 26.5 FT
NET LENGTH OF PROJECT = 70 FT
GROSS LENGTH OF PROJECT = 70 FT

STATE OF ILLINOIS
DEPARTMENT OF TRANSPORTATION
DIVISION OF HIGHWAYS

SUBMITTED *November 12, 2004*

Thomas A. Jaraman
DISTRICT ENGINEER

December 10, 2004
Mike Hine
ENGINEER OF DESIGN AND ENVIRONMENT

December 10, 2004
Victor Mader
DIRECTOR, DIVISION OF HIGHWAYS

**PRINTED BY THE AUTHORITY
OF THE STATE OF ILLINOIS**

(618) 549-2171
 Thursday, October 28, 2004 @ 10:21:44 AM
 c:\pro\peia\98655\98655.dwg LV-2-83

PROJECT ENGINEER: DAVID PICHE
 DESIGNER: DAVID WEBSTER