

F.A.P. RTE.	SECTION	COUNTY	TOTAL SHEETS	SHEET NO.
1887	6B-1	WILLIAMSON	27	17
STA. 262+55		TO STA. 263+25		
FED. ROAD DIST. NO. 7		ILLINOIS		FED. AID PROJECT

CONTRACT NUMBER 98655

NOTE: GUARDRAIL, BITUMINOUS SHOULDER, AND FORESLOPE GRADING ON THE LEFT SIDE CONTINUES AROUND INTERSECTION TO THE NORTH ON PAULTON ROAD. (SEE PAULTON ROAD CROSS-SECTIONS)

DATE	
BY	
FINAL SURVEY	
REVISIONS	
PLATE	
NO. DATE	
AREAS CHECKED	
NO.	

DATE	
BY	
ORIGINAL SURVEY	
REVISIONS	
PLATE	
NO. DATE	
AREAS CHECKED	
NO.	

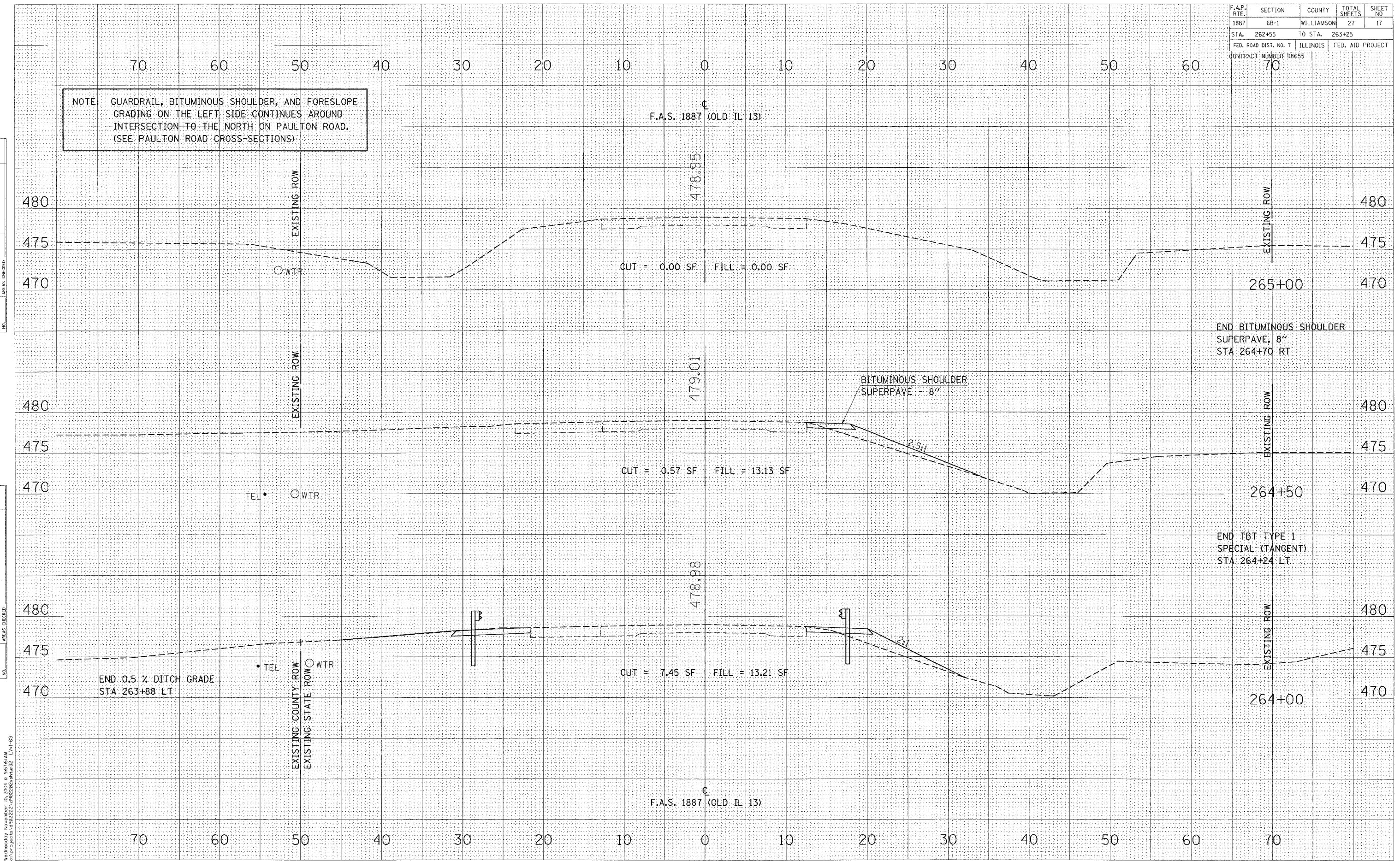

Wednesday November 10, 2010 9:55:53 AM
 C:\pawgen\10112209\10112209.dwg L1-1-03