

PR. SIDEWALK  
 STA. 98+41.11 TO STA. 99+75.62 RT.  
 STA. 98+00.00 TO STA. 99+63.39 LT.  
 STA. 100+24.31 TO STA. 101+00.00 LT.  
 STA. 100+66.49 TO STA. 102+22.47 RT.

PR. SINGLE FACE CONCRETE BARRIER  
 STA. 98+00.00 TO 99+34.01 LT.  
 STA. 100+55.10 TO 101+00.00 LT.

PR. TRAFFIC BARRIER TERMINAL TYPE 6  
 STA. 97+56.85 TO STA. 98+00.06 LT  
 STA. 99+16.66 TO STA. 99+60.47 RT  
 STA. 100+66.05 TO STA. 101+09.80 RT  
 STA. 100+99.50 TO STA. 101+43.15 LT

PR. TRAFFIC BARRIER TERMINAL TYPE 1, SPECIAL (TANGENT)  
 STA. 95+19.64 TO STA. 95+69.59 LT  
 STA. 98+54.11 TO STA. 99+04.16 RT  
 STA. 101+22.30 TO STA. 101+72.30 RT  
 STA. 101+93.05 TO STA. 102+43.00 LT

PR. STEEL PLATE BEAM GUARD RAIL, TYPE A, 6 FOOT POSTS  
 STA. 95+69.59 TO STA. 97+56.85 LT  
 STA. 99+04.16 TO STA. 99+16.66 RT  
 STA. 101+09.80 TO STA. 101+22.30 RT  
 STA. 101+43.15 TO STA. 101+93.05 LT

NOTE:  
 BLOCKOUTS REQUIRED FOR TYPE 6 TERMINALS. INCLUDED IN COST  
 PER EACH FOR TRAFFIC BARRIER TERMINALS, TYPE 6.

PR. B-6.24 CONCRETE CURB AND GUTTER  
 STA. 97+76.50 TO STA. 98+00.00 LT  
 STA. 97+76.50 TO STA. 99+44.66 RT  
 STA. 100+66.11 TO STA. 102+22.50 RT  
 STA. 101+00.00 TO STA. 102+22.50 LT

PLAN	SURVEYED	DATE
	DESIGNED	
	CHECKED	
	IN CHARGE	
	BY	
	DATE	
	NO.	
	FILE NAME	

PROFILE	SURVEYED	DATE
	DESIGNED	
	CHECKED	
	IN CHARGE	
	BY	
	DATE	
	NO.	
	FILE NAME	

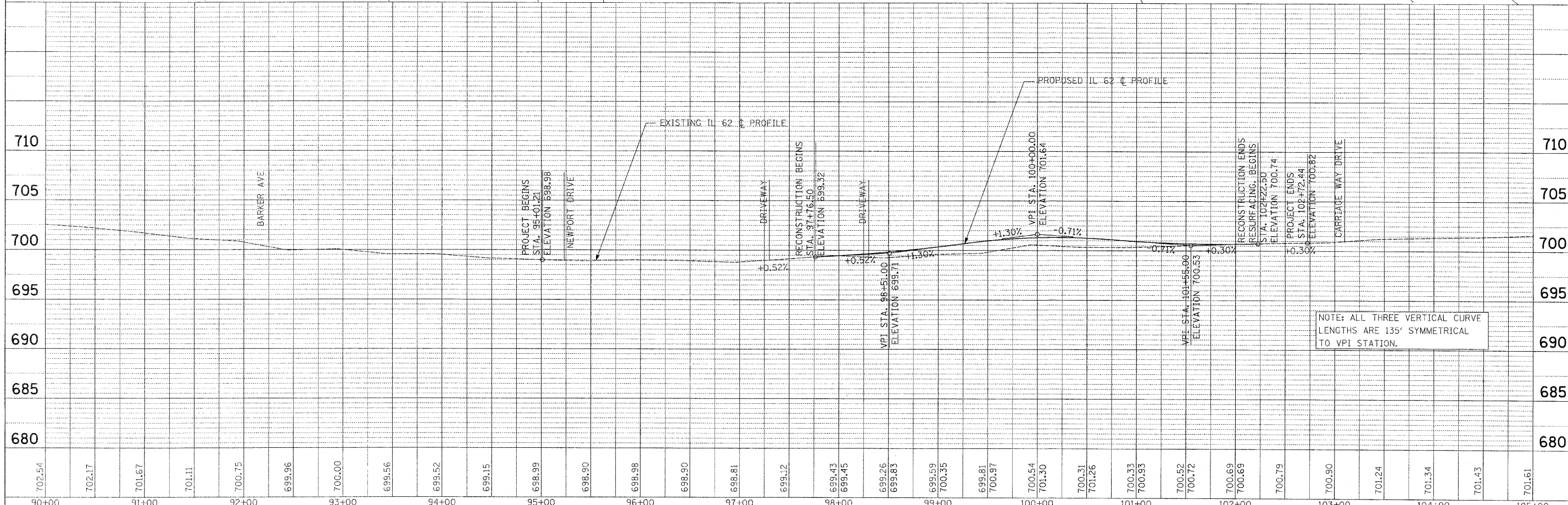

BENCHMARKS:  
 FOUND 'C' CUT ON NW WINGWALL OF ALGONQUIN ROAD  
 BRIDGE OVER SALT CREEK. ELEVATION = 700.27

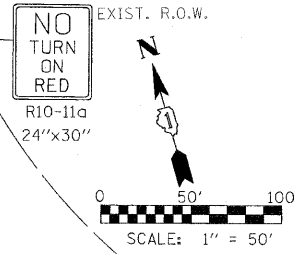

FILE NAME - #FILE#	USER NAME - #USER#	DESIGNED - ST	REVISED -	<b>PROPOSED PLAN AND PROFILE</b> <b>IL ROUTE 62 (ALGONQUIN ROAD) OVER SALT CREEK</b>				F.A.P. RTE. 339	SECTION 116-Y-2-BR-1	COUNTY COOK	TOTAL SHEETS 74	SHEET NO. 15
PILOT SCALE - #SCALE#	CHECKED - FML	REVISOR -	DATE - 02/2010					SCALE: 1" = 50'	SHEET NO. 1 OF 1 SHEETS	STA. 95+01.21 TO STA. 102+72.44	FED. ROAD DIST. NO.	ILLINOIS FED. AID PROJECT