

STATE OF ILLINOIS  
DEPARTMENT OF TRANSPORTATION

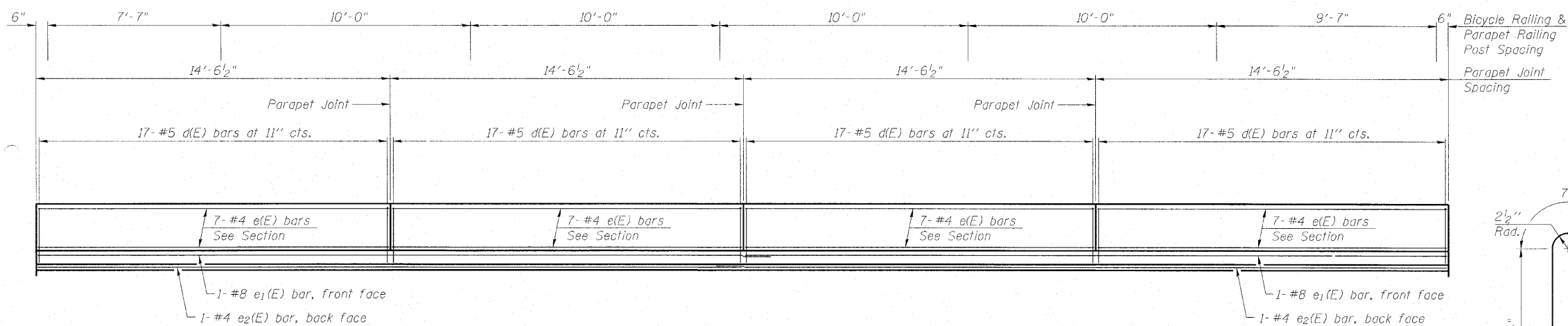

INSIDE ELEVATION OF PARAPET

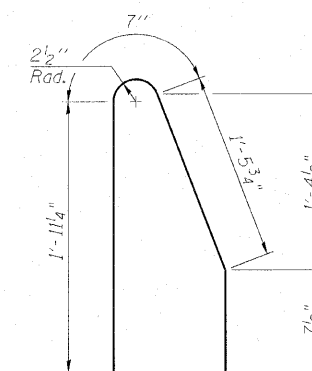

BAR d<sub>1</sub>(E)

SUPERSTRUCTURE  
BILL OF MATERIAL

Bar	No.	Size	Length	Shape
d(E)	127	#5	45'-10"	—
a <sub>1</sub> (E)	78	#5	45'-6"	—
a <sub>2</sub> (E)	254	#5	15'-0"	—
a <sub>3</sub> (E)	156	#5	2'-8"	—
a <sub>4</sub> (E)	2	#5	42'-4"	—
a <sub>6</sub> (E)	60	#5	8'-4"	U
a <sub>10</sub> (E)	127	#5	42'-2"	—
a <sub>11</sub> (E)	78	#5	41'-10"	—
a <sub>14</sub> (E)	2	#5	38'-7"	—
a <sub>16</sub> (E)	6	#5	2'-2"	—
a <sub>26</sub> (E)	6	#5	5'-10"	—
b(E)	161	#5	35'-7"	—
b <sub>1</sub> (E)	161	#5	25'-7"	—
d(E)	136	#5	5'-7"	—
d <sub>1</sub> (E)	136	#5	4'-8"	—
e(E)	56	#4	14'-2"	—
e <sub>1</sub> (E)	4	#8	32'-6"	—
e <sub>2</sub> (E)	4	#4	30'-5"	—
x(E)	154	#5	6'-5"	—
Reinforcement Bars, Epoxy Coated			Pound	37,640
Concrete Superstructure			Cu. Yds.	152.2

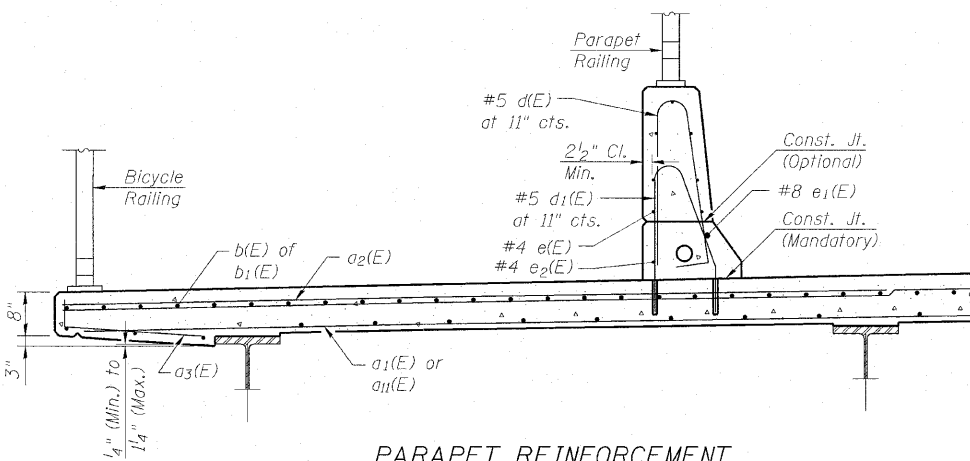

PARAPET REINFORCEMENT  
FOR INTERIOR DECK PARAPET LOCATIONS

Core and set #5 d (E) bar according to Article 509.06 of the Standard Specifications. Cored holes shall be roughened or scored per manufacturer's recommendations. Maximum depth of hole shall not exceed 6".

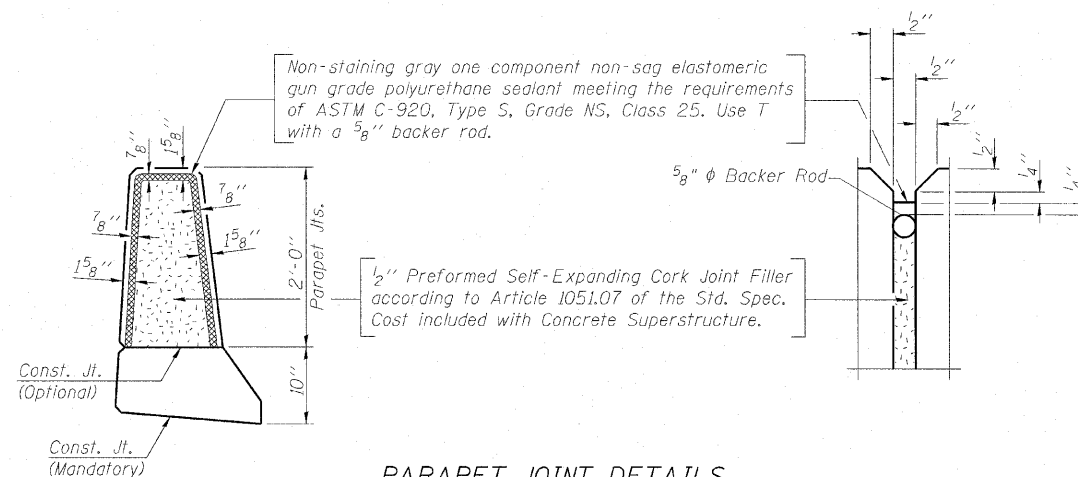

PARAPET JOINT DETAILS

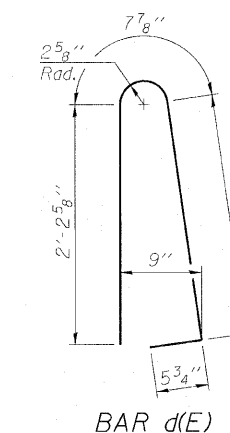

BAR d(E)

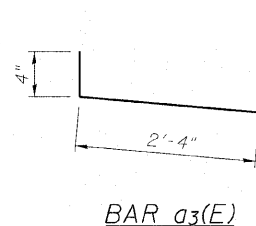

BAR a<sub>3</sub>(E)

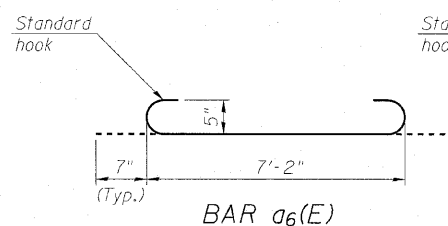

BAR a<sub>6</sub>(E)

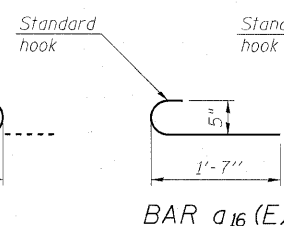

BAR a<sub>16</sub>(E)

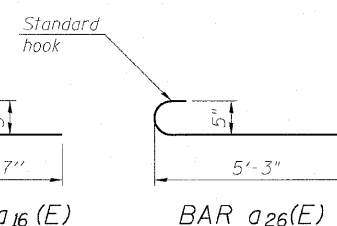

BAR a<sub>26</sub>(E)

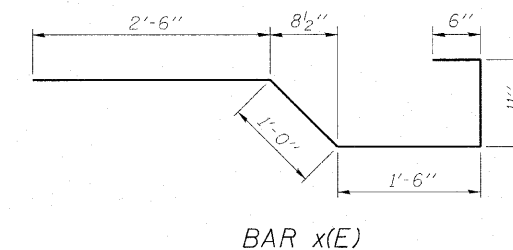

BAR x(E)

SUPERSTRUCTURE DETAILS  
STRUCTURE NO. 016-0581

DESIGNED MAH
CHECKED JMH
DRAWN DR
CHECKED JMH

**COLLINS ENGINEERS**  
123 N. WACKER DR., SUITE 300  
CHICAGO, IL 60606  
(312) 704-9300  
ILLINOIS PROFESSIONAL DESIGN FIRM LICENSE NO. 184-000993

SHEET NO. S8 OF S27 SHEETS	F.A.P. RTE. 339	SECTION 116-Y-2-BR-1	COUNTY COOK	TOTAL SHEETS 74	SHEET NO. 30
	CONTRACT NO. 60J00				
ILLINOIS FED. AID PROJECT					