

**CONSTRUCTION NOTES:**

- ① INSTALL UNINTERRUPTIBLE POWER SUPPLY UNIT.
- ② ALL EXISTING CONFIRMATION BEACONS SHALL BE RETROFITTED WITH LED INDICATIONS. THIS WORK SHALL BE INCIDENTAL TO THE PAY ITEM: UNINTERRUPTIBLE POWER SUPPLY.
- ③ ALL CABINET MODIFICATIONS AND/OR LOAD SWITCH REPLACEMENTS REQUIRED FOR PROPER OPERATION OF THE LED SIGNAL AND LED CONFIRMATION BEACON INDICATIONS TO THE SATISFACTION OF THE ENGINEER SHALL BE INCIDENTAL TO THE PAY ITEM: UNINTERRUPTIBLE POWER SUPPLY

MATCH LINE (SEE LOWER LEFT)

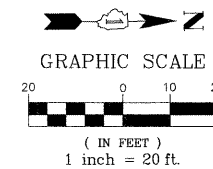

**Restoration of Work Area.** Restoration of the traffic signal work area shall be incidental to the related pay items such as foundation, conduit, handhole, trench and backfill, etc., and no extra compensation shall be allowed. All roadway surfaces such as shoulders, medians, sidewalks, pavement, etc. shall be replaced in kind. All damage to mowed lawns shall be replaced with an approved sod, and all damage to unmowed fields shall be seeded in accordance with Standard Specifications 252 and 250 respectively.

**TRAFFIC SIGNAL LEGEND**

- PORTLAND CEMENT CONCRETE SIDEWALK, 5"
- DETECTABLE WARNING

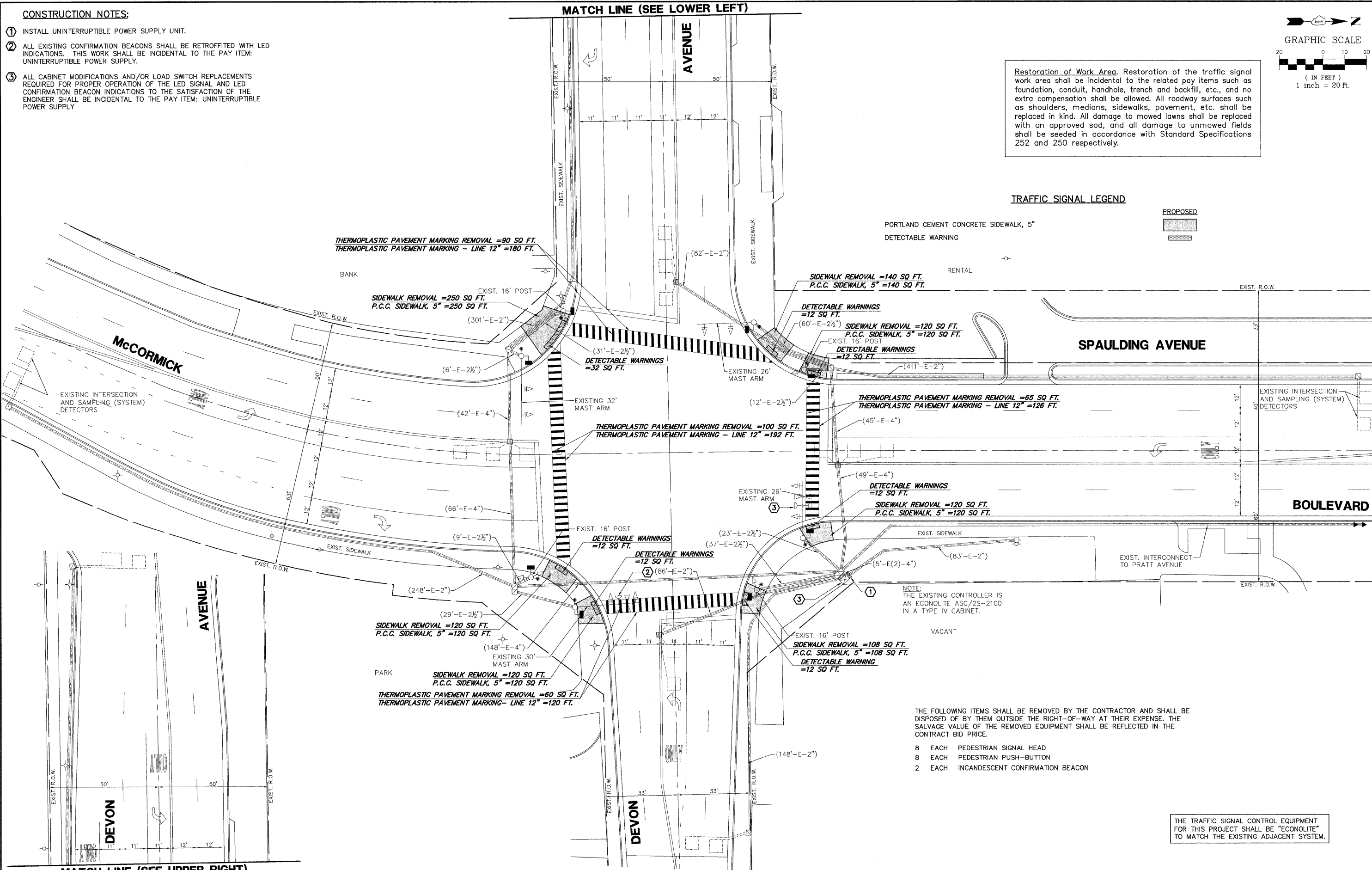

THE TRAFFIC SIGNAL CONTROL EQUIPMENT FOR THIS PROJECT SHALL BE "ECONOLITE" TO MATCH THE EXISTING ADJACENT SYSTEM.

MATCH LINE (SEE UPPER RIGHT)

FILE NAME = McCormick@Devon.cwg	USER NAME = ZACH WALLSTEN	DESIGNED - JRD	REVISED -	<b>STATE OF ILLINOIS DEPARTMENT OF TRANSPORTATION</b>	<b>TRAFFIC SIGNAL MODERNIZATION PLAN McCORMICK BOULEVARD AT DEVON AVENUE</b>	FAP. RTE.	SECTION	COUNTY	TOTAL SHEETS	SHEET NO.
	PLOT SCALE = 1" = .0833'	DRAWN - ZCW	REVISED -			VARIES	2010-006TS	COOK	58	10
	PLOT DATE = 10/29/2010	CHECKED - KLB	REVISED -			CONTRACT #:		60K24		
				SCALE 1"=20'	SHEET NO. OF SHEETS	STA. TO STA.	ILLINOIS FED. AID PROJECT			

GHA #4085.867