

CONSTRUCTION NOTES:

- ① INSTALL UNINTERRUPTIBLE POWER SUPPLY UNIT ON A SEPARATE TYPE A FOUNDATION CONNECTED TO THE CONTROLLER CABINET THROUGH THE DOUBLE HANDHOLE WITH A 3" GALVANIZED STEEL CONDUIT.
- ② ALL EXISTING CONFIRMATION BEACONS SHALL BE RETROFITTED WITH LED INDICATORS. THIS WORK SHALL BE INCIDENTAL TO THE PAY ITEM: UNINTERRUPTIBLE POWER SUPPLY.
- ③ ALL CABINET MODIFICATION AND/OR LOAD SWITCH REPLACEMENTS REQUIRED FOR PROPER OPERATION OF THE LED SIGNAL AND LED CONFIRMATION BEACON INDICATIONS TO THE SATISFACTION OF THE ENGINEER SHALL BE INCIDENTAL TO THE PAY ITEM: UNINTERRUPTIBLE POWER SUPPLY.

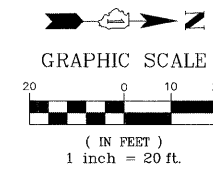

Restoration of Work Area. Restoration of the traffic signal work area shall be incidental to the related pay items such as foundation, conduit, handhole, trench and backfill, etc., and no extra compensation shall be allowed. All roadway surfaces such as shoulders, medians, sidewalks, pavement, etc. shall be replaced in kind. All damage to mowed lawns shall be replaced with an approved sod, and all damage to unmowed fields shall be seeded in accordance with Standard Specifications 252 and 250 respectively.

TRAFFIC SIGNAL LEGEND

PORTLAND CEMENT CONCRETE SIDEWALK, 5"
DETECTABLE WARNING



THE FOLLOWING ITEMS SHALL BE REMOVED BY THE CONTRACTOR AND SHALL BE DISPOSED OF BY THEM OUTSIDE THE RIGHT-OF-WAY AT THEIR EXPENSE. THE SALVAGE VALUE OF THE REMOVED EQUIPMENT SHALL BE REFLECTED IN THE CONTRACT BID PRICE.

- 7 EACH SIGNAL HEAD, 1-FACE, 3-SECTION
- 2 EACH SIGNAL HEAD, 1-FACE, 5-SECTION
- 4 EACH TRAFFIC SIGNAL BACK PLATE
- 3 EACH TRAFFIC SIGNAL POST
- 3 EACH INCANDESCENT CONFIRMATION BEACON
- 2 EACH PEDESTRIAN SIGNAL HEAD
- 2 EACH PEDESTRIAN PUSH-BUTTON

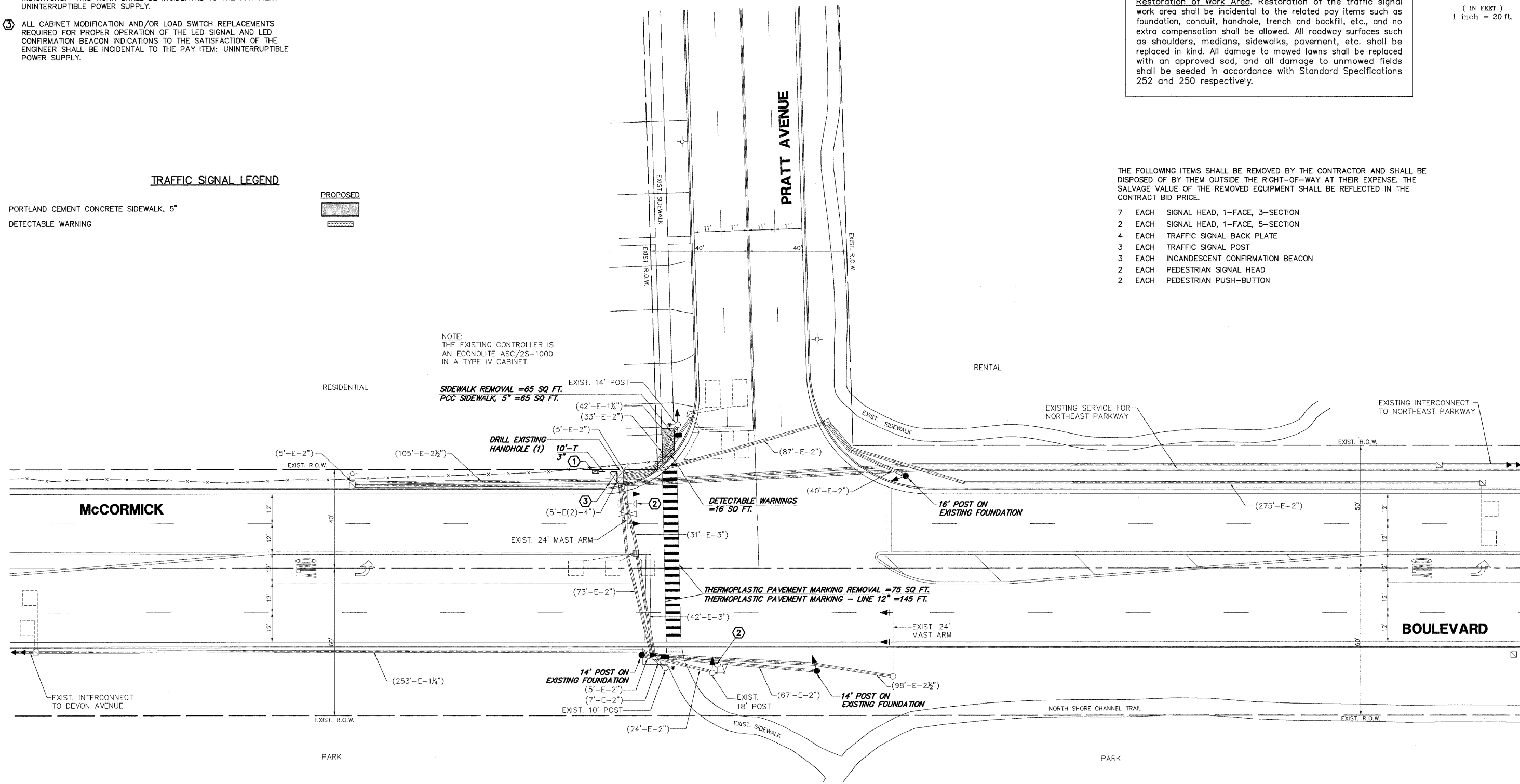

NOTE:
THE EXISTING CONTROLLER IS AN ECONOLITE ASC/2S-1000 IN A TYPE IV CABINET.

THE TRAFFIC SIGNAL CONTROL EQUIPMENT FOR THIS PROJECT SHALL BE "ECONOLITE" TO MATCH THE EXISTING ADJACENT SYSTEM.

FILE NAME = McCORMICK@PRATT.dwg	USER NAME = ZACH WALLSTEN	DESIGNED - JRD	REVISED -	STATE OF ILLINOIS DEPARTMENT OF TRANSPORTATION	TRAFFIC SIGNAL MODERNIZATION PLAN McCORMICK BOULEVARD AT PRATT AVENUE	FAP. RTE.	SECTION	COUNTY	TOTAL SHEETS	SHEET NO.	
	PLOT SCALE = 1" = .0833'	DRAWN - ZCW	REVISED -			VARIES	2010-006TS	COOK	58	12	
	PLOT DATE = 10/29/2010	CHECKED - KLB	REVISED -			CONTRACT #:		60K24			
		DATE - 10/29/2010	REVISED -			ILLINOIS FED. AID PROJECT					
				SCALE 1"=20'		SHEET NO. OF 54 SHEETS		STA. TO STA.		GHA #4085.867	