

DEAD LOAD DEFLECTION DIAGRAM

(Includes weight of concrete, excluding beams).

Note:

The above deflections are not to be used in the field if the engineer is working from the grade elevations adjusted for dead load deflections shown below and on sheet No. S4.

All dimensions are inches (in) except as noted.

All elevations and offsets shown in the "Top of slab Elevations Table" are in feet.

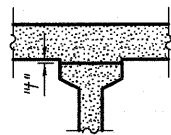

To determine "h" After all precast prestressed beams have been erected, elevations of the top flanges of the beams shall be taken at interval shown below. These elevations subtracted from the Theoretical Grade Elevations Adjusted for Dead Load Deflection" minus slab thickness, equals the fillet heights "h" above top flange of beams.

FILLET HEIGHTS

SOUTH EDGE OF DECK SLAB

Location	Station	Offset	Theoretical Grade Elevation	Theoretical Grade Elevation Adjusted For Dead Load Deflection
West Edge of Deck	0+30.15	34+58	14.20	14.20
☉ West Bearing	0+36.67	34.58	14.07	14.07
A	0+49.82	34.58	13.80	13.80
☉ East Bearing	0+59.82	34.58	13.78	13.78
Inside Face of East Parapet	0+60.57	34.58	13.78	13.78

BEAM 1

Location	Station	Offset	Theoretical Grade Elevation	Theoretical Grade Elevation Adjusted For Dead Load Deflection
West Edge of Deck	0+29.97	33.13	14.20	14.20
☉ West Bearing	0+36.42	32.58	14.07	14.07
B	0+40.16	31.24	13.99	14.00
A	0+49.99	29.41	13.80	13.80
☉ East Bearing	0+59.82	27.58	13.59	13.59
Inside Face of East Parapet	0+60.57	27.44	13.58	13.58

BEAM 2

Location	Station	Offset	Theoretical Grade Elevation	Theoretical Grade Elevation Adjusted For Dead Load Deflection
West Edge of Deck	0+28.56	22.08	14.20	14.20
☉ West Bearing	0+35.09	22.08	14.07	14.07
B	0+39.82	22.08	13.98	13.99
A	0+49.82	22.08	13.78	13.78
☉ East Bearing	0+59.82	22.08	13.58	13.58
Inside Face of East Parapet	0+60.57	22.08	13.56	13.56

BEAM 3

Location	Station	Offset	Theoretical Grade Elevation	Theoretical Grade Elevation Adjusted For Dead Load Deflection
West Edge of Deck	0+27.54	14.08	14.20	14.20
☉ West Bearing	0+34.07	14.08	14.07	14.07
B	0+39.82	14.08	13.95	13.96
A	0+49.82	14.08	13.75	13.76
☉ East Bearing	0+59.82	14.08	13.55	13.56
Inside Face of East Parapet	0+60.57	14.08	13.54	13.54

BEAM DEAD LOAD DEFLECTION

	A	D1	D2	D3
Beam 1	0	0	0	0
Beam 2	0	0	0	0
Beam 3	0	0	0	0
Beam 4	0	0	0	0
Beam 5	0	0	1/8	0
Beam 6	0	0	1/8	0
Beam 7	0	0	1/8	0
Beam 8	0	1/16	1/8	1/16
Beam 9	0	1/16	1/8	1/16
Beam 10	0	1/16	1/8	1/16

BEAM 4

Location	Station	Offset	Theoretical Grade Elevation	Theoretical Grade Elevation Adjusted For Dead Load Deflection
West Edge of Deck	0+26.43	5.33	14.20	14.20
☉ West Bearing	0+32.96	5.33	14.07	14.07
B	0+39.82	5.33	13.93	13.94
A	0+49.82	5.33	13.73	13.74
☉ East Bearing	0+59.82	5.33	13.53	13.53
Inside Face of East Parapet	0+60.57	5.33	13.51	13.51

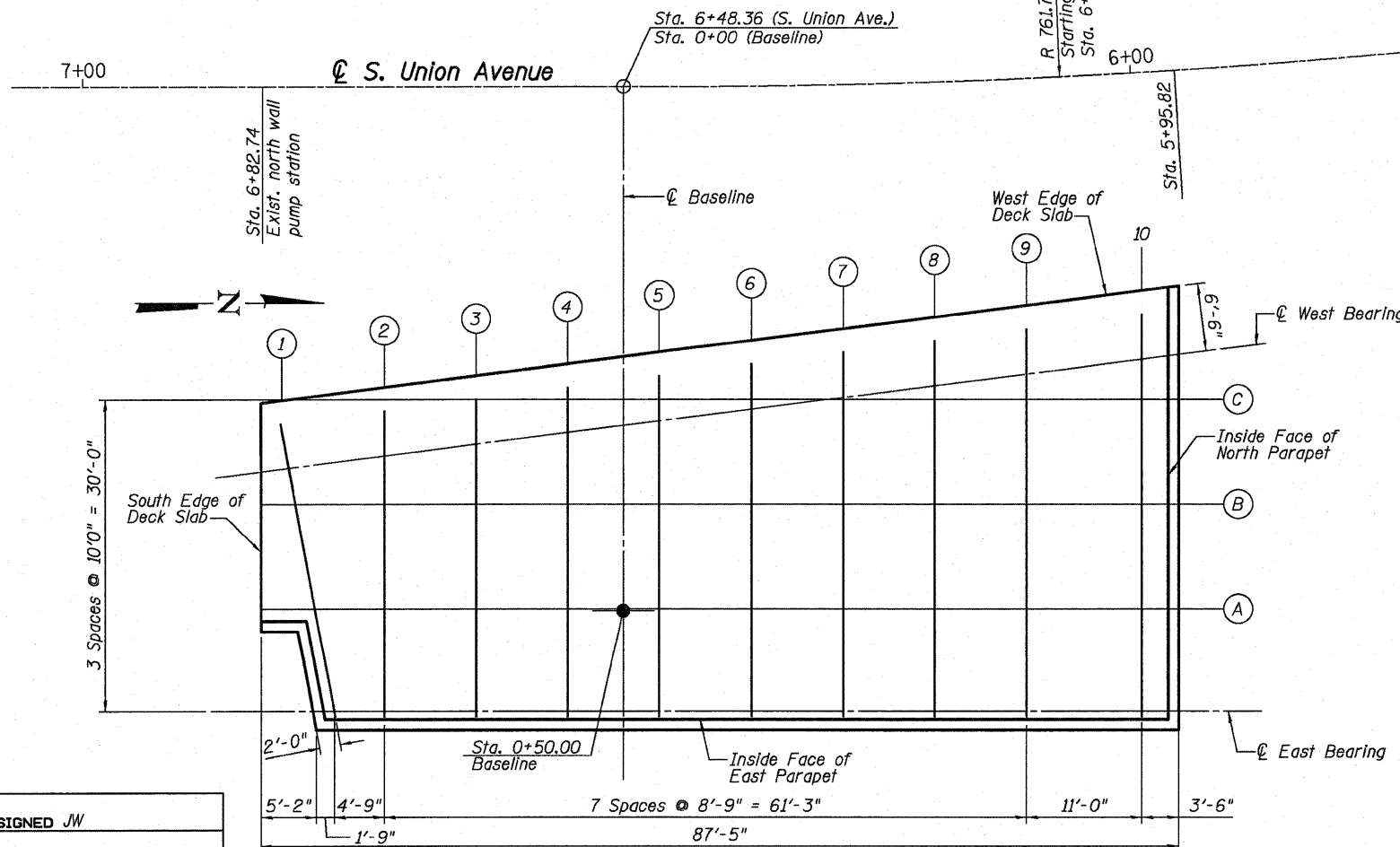

**TOP OF SLAB ELEVATIONS, LAYOUT AND DETAILS
STRUCTURE NUMBER 016-1308**

DESIGNED JW
CHECKED YMM
DRAWN JLS & PS
CHECKED TPG & JXH



PLAN

SHEET NO. S3	F.A.I. RTE.	SECTION	COUNTY	TOTAL SHEETS	SHEET NO.
	90/94	2010-075-I	COOK	33	12
S19 SHEETS	CONTRACT NO. 60L61				
	DATE: 12-03-10	ILLINOIS FED. AID PROJECT			