

- 1 EXIST. TERMINAL SECTION TO BE REPLACED WITH NEW TYPE 1 (SPECIAL) - TANGENT 50 FT LONG. SEE STANDARD 630301 & DISTRICT DETAIL (BD-34).
- OTHER PAY ITEMS WITH QUANTITIES ESTIMATED FOR THIS AREA INCLUDE:
- REMOVAL & DISPOSAL OF UNSUITABLE MATERIAL
 - FURNISHED EXCAVATION
 - TOP SOIL FURNISH AND PLACE, 4"
 - SEEDING, CLASS 2A
 - NITROGEN FERTILIZER NUTRIENT
 - PHOSPHORUS FERTILIZER NUTRIENT
 - POTASSIUM FERTILIZER NUTRIENT
 - EROSION CONTROL BLANKET
 - AGGREGATE SHOULDER, TYPE B - 10"
 - GUARDRAIL REMOVAL

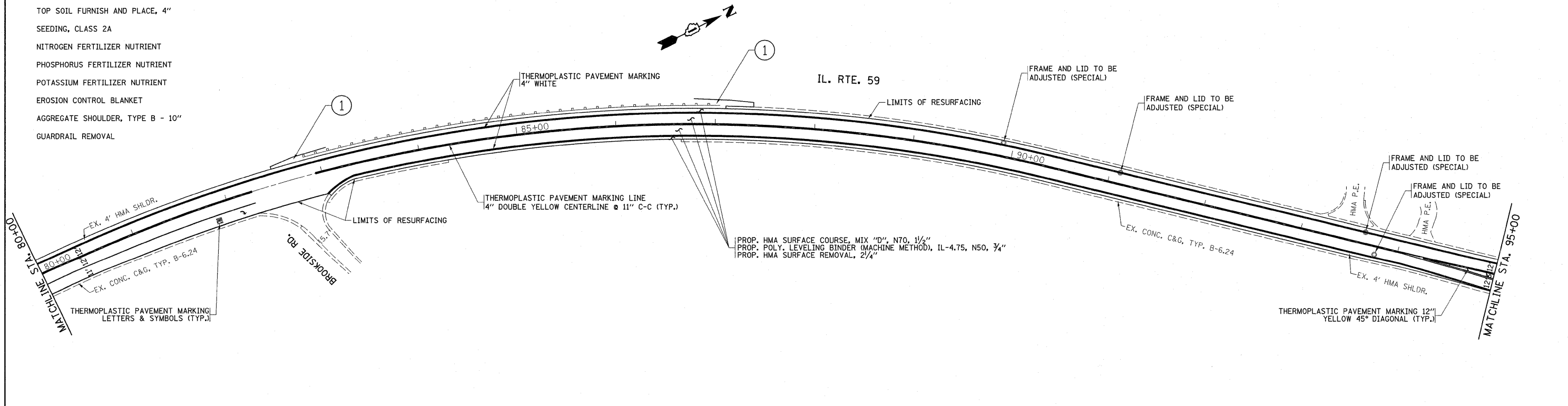

FILE NAME =	USER NAME = hamdanah	DESIGNED -	REVISED -	STATE OF ILLINOIS DEPARTMENT OF TRANSPORTATION	ROADWAY AND PAVEMENT MARKING PLAN				F.A.P. RTE. 338	SECTION 107-RS-3	COUNTY LAKE	TOTAL SHEETS 30	SHEET NO. 7
c:\pw_work\pavdot\hamdanah\d0223594\011	111-sh-t-plan.dgn	DRAWN -	REVISED -		IL. RTE. 59 FROM IL. RTE. 22 TO U.S. RTE 12 (RAND RD.)				CONTRACT NO. 60M58				
	PLOT SCALE = 50.0000' / IN.	CHECKED -	REVISED -		SCALE:	SHEET NO.	OF SHEETS	STA. TO STA.	ILLINOIS FED. AID PROJECT				
	PLOT DATE = 10/29/2010	DATE -	REVISED -										