

- LEGEND**
- ① PROPOSED PORTLAND CEMENT CONCRETE SHOULDER, 12 1/4" (48300705)
 - ② PROPOSED STABILIZED SUBBASE - HOT-MIX ASPHALT, 4 1/2" (31200502)
 - ③ PROPOSED AGGREGATE SUBGRADE, 12" (20001050)
 - ④ PROPOSED CONCRETE BARRIER, DOUBLE FACE, 42 INCH HEIGHT (63700275)
 - ⑤ PROPOSED CONCRETE BARRIER, VARIABLE CROSS SECTION, 42" HEIGHT (X6370205)
 - ⑥ PROPOSED CONCRETE BARRIER, DOUBLE FACE (SPECIAL) (X0326445)
 - ▨ CLASS A PATCHES, 12 1/4"

EXIST. CURVE E-180-3
 PI-STA. = 920+85.69
 $\Delta = 15^\circ 37' 36''$ (LT)
 $D = 1^\circ 00' 38''$
 $R = 5,670.33'$
 $T = 778.08'$
 $L = 1,546.50'$
 $E = 53.13'$
 $P.C. STA. = 913+07.61$
 $P.T. STA. = 928+54.11$

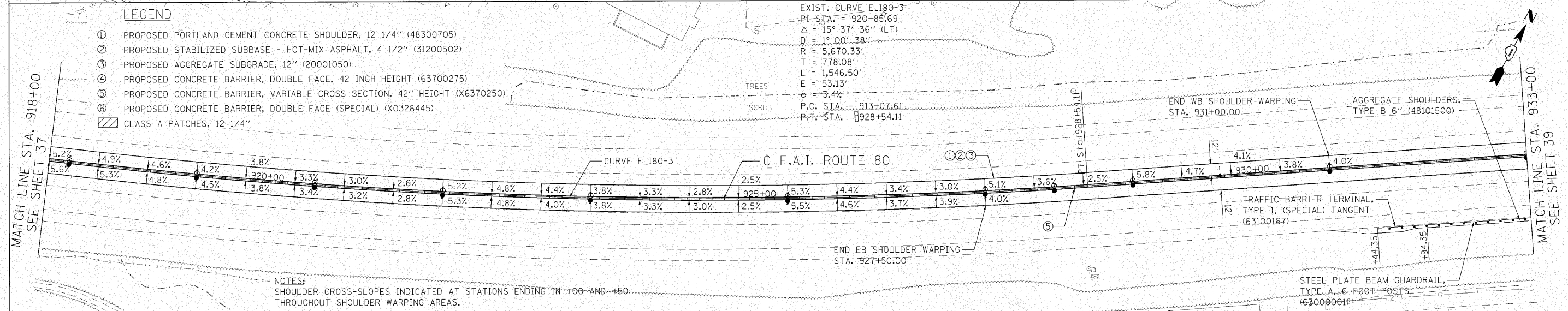

NOTES:
 SHOULDER CROSS-SLOPES INDICATED AT STATIONS ENDING IN +00 AND +50 THROUGHOUT SHOULDER WARPING AREAS.

TOP OF WALL	918+00	919+00	920+00	921+00	922+00	923+00	924+00	925+00	926+00	927+00	928+00	929+00	930+00	931+00	932+00	933+00
705	696.55	696.69	696.83	696.98	697.12	697.26	697.40	697.54	697.68	697.82	697.96	698.10	698.24	698.38	698.52	698.66
700	693.40	693.55	693.69	693.82	693.95	694.07	694.22	694.35	694.48	694.61	694.76	694.89	695.02	695.15	695.28	695.41
695	691.67	691.81	691.92	692.07	692.15	692.29	692.44	692.56	692.68	692.83	692.97	693.10	693.23	693.35	693.48	693.61
690	692.78	692.96	693.14	693.32	693.50	693.68	693.86	694.04	694.22	694.40	694.58	694.76	694.94	695.12	695.30	695.48

<p>Giorba Group, Inc. CONSULTING ENGINEERS 8507 North Cumberland Avenue, Suite 402 Chicago, Illinois 60650 Tel: 773.775.4009 Fax: 773.775.4014 Email: ceng@giorba.com</p>	USER NAME = jkjoeliman DESIGNED - CRC DRAWN - JMK CHECKED - MRJ DATE - 10/27/2010	REVISED - REVISED - REVISED - REVISED -	<p align="center">STATE OF ILLINOIS DEPARTMENT OF TRANSPORTATION</p>	<p align="center">F.A.I. 80 FROM NS RAILROAD TO US 45 ROADWAY PLAN & PROFILE</p>	F.A.I. RTE. = 80 SECTION = 9915&5-11 Y-1 COUNTY = WILL CONTRACT NO. 60M59	TOTAL SHEETS = 309 SHEET NO. = 38
	PLOT SCALE = 50.0000' / IN. PLOT DATE = 10/28/2010	SCALE: 1" = 50' SHEET NO. OF SHEETS STA. 918+00 TO STA. 933+00	ILLINOIS FED. AID PROJECT			