

STAGE CONSTRUCTION LINE (W.B.)

Location	Station	Offset	Theoretical Grade Elevations
W. End of West Appr.	897+64.65	-20.00	686.92
A1	897+74.65	-20.00	686.95
A2	897+84.65	-20.00	686.97
E. End of West Appr.	897+94.65	-20.00	687.00

P.G. S.N. 099-0071 (W.B.) & SOUTH EDGE OF PAVEMENT (W.B.)

Location	Station	Offset	Theoretical Grade Elevations
W. End of West Appr.	897+57.77	-13.50	686.76
A1	897+67.77	-13.50	686.79
A2	897+77.77	-13.50	686.82
E. End of West Appr.	897+87.77	-13.50	686.85

SOUTH EDGE OF SHOULDER (W.B.)

Location	Station	Offset	Theoretical Grade Elevations
W. End of West Appr.	897+45.06	-1.50	686.48 *
A1	897+55.06	-1.50	686.52 *
A2	897+65.06	-1.50	686.53
E. End of West Appr.	897+75.06	-1.50	686.56

NORTH EDGE OF SHOULDER (E.B.)

Location	Station	Offset	Theoretical Grade Elevations
W. End of West Appr.	897+41.89	1.50	686.37 *
A1	897+51.89	1.50	686.40 *
A2	897+61.89	1.50	686.43
E. End of West Appr.	897+71.89	1.50	686.45

P.G. S.N. 099-0070 (E.B.) & NORTH EDGE OF PAVEMENT (E.B.)

Location	Station	Offset	Theoretical Grade Elevations
W. End of West Appr.	897+29.18	13.50	686.59
A1	897+39.18	13.50	686.61
A2	897+49.18	13.50	686.64
E. End of West Appr.	897+59.18	13.50	686.67

STAGE CONSTRUCTION LINE (E.B.)

Location	Station	Offset	Theoretical Grade Elevations
W. End of West Appr.	897+22.30	20.00	686.70
A1	897+32.30	20.00	686.73
A2	897+42.30	20.00	686.76
E. End of West Appr.	897+52.30	20.00	686.79

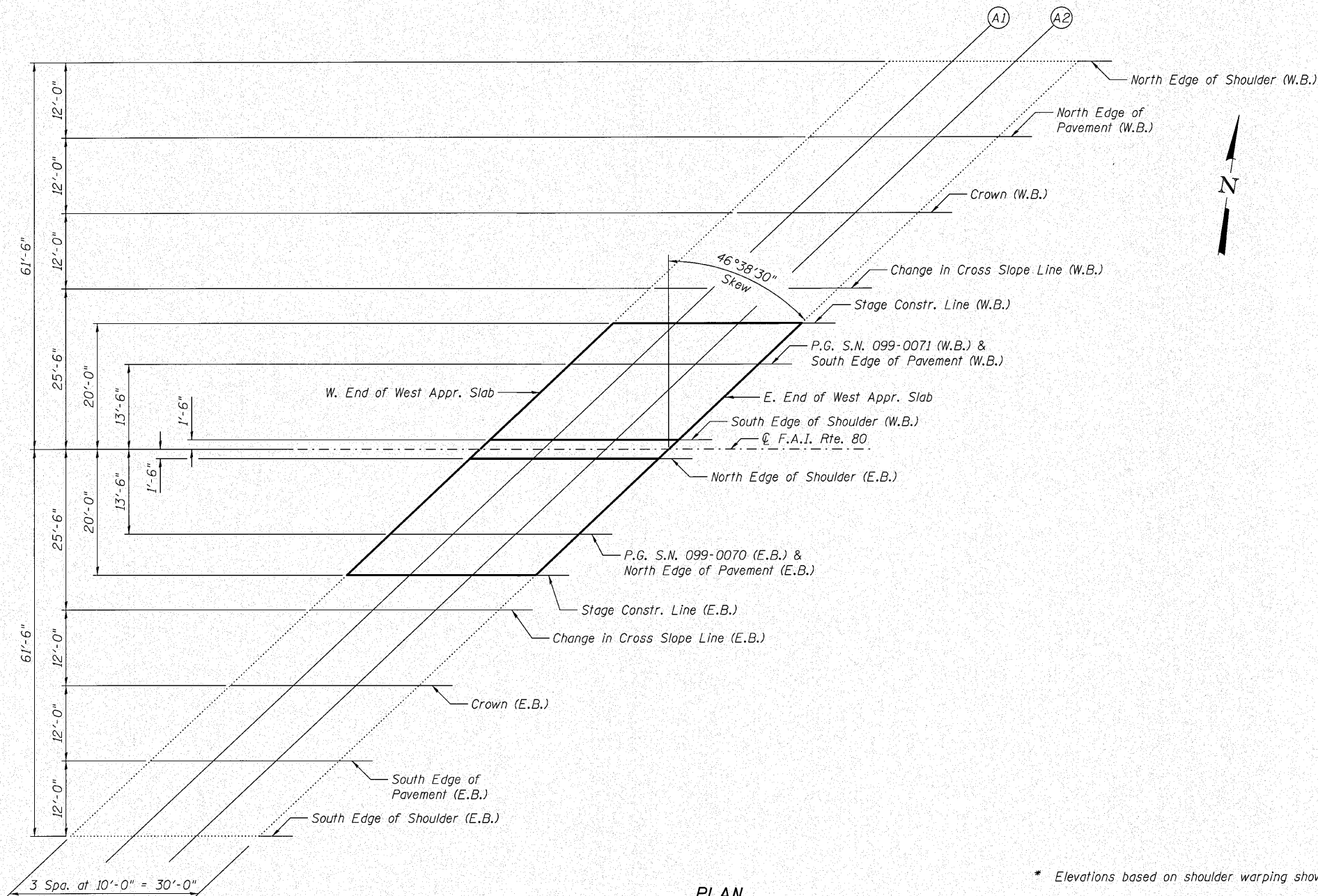

PLAN
(West Approach)

* Elevations based on shoulder warping shown in roadway plans & profile sheets.

All elevations are at top of concrete pour and do not include 3/8" overlay.

nt:\pro\3384\3.east\design\structural\1-80 over n&s\acad\3384_1-80 N&S 07 Top of W Approach Slab Elevations.dgn

Clorba Group, Inc.
CONSULTING ENGINEERS
1501 North Lincoln Road
Suite 202 Chicago, Illinois 60654
Tel: 773.775.4000
Fax: 773.775.4004
www.clorbagroup.com

FILE NAME =	USER NAME = rdanley	DESIGNED - BWS	REVISED -
		CHECKED - EKM	REVISED -
PLOT SCALE =		DRAWN - RD	REVISED -
PLOT DATE = 10/28/2010		CHECKED - SCD	REVISED -

STATE OF ILLINOIS
DEPARTMENT OF TRANSPORTATION

TOP OF WEST APPROACH SLAB ELEVATIONS
STRUCTURE NO. 099-0070 (E.B.) & 099-0071 (W.B.)

F.A.I. RTE. 80	SECTION 99(5&5-1) Y-1	COUNTY WILL	TOTAL SHEETS 309	SHEET NO. 195
CONTRACT NO. 60M59				ILLINOIS FED. AID PROJECT