

| F.A.R. RTE. | SECTION | COUNTY | TOTAL SHEETS | SHEET NO. |
|---------------------|---------------------------|----------------|--------------|-----------|
| | 2010-150-DTR | DUPAGE | 100 | 33 |
| | STA. 152+00 | TO STA. 166+00 | | |
| FED. ROAD DIST. NO. | ILLINOIS FED. AID PROJECT | | | |

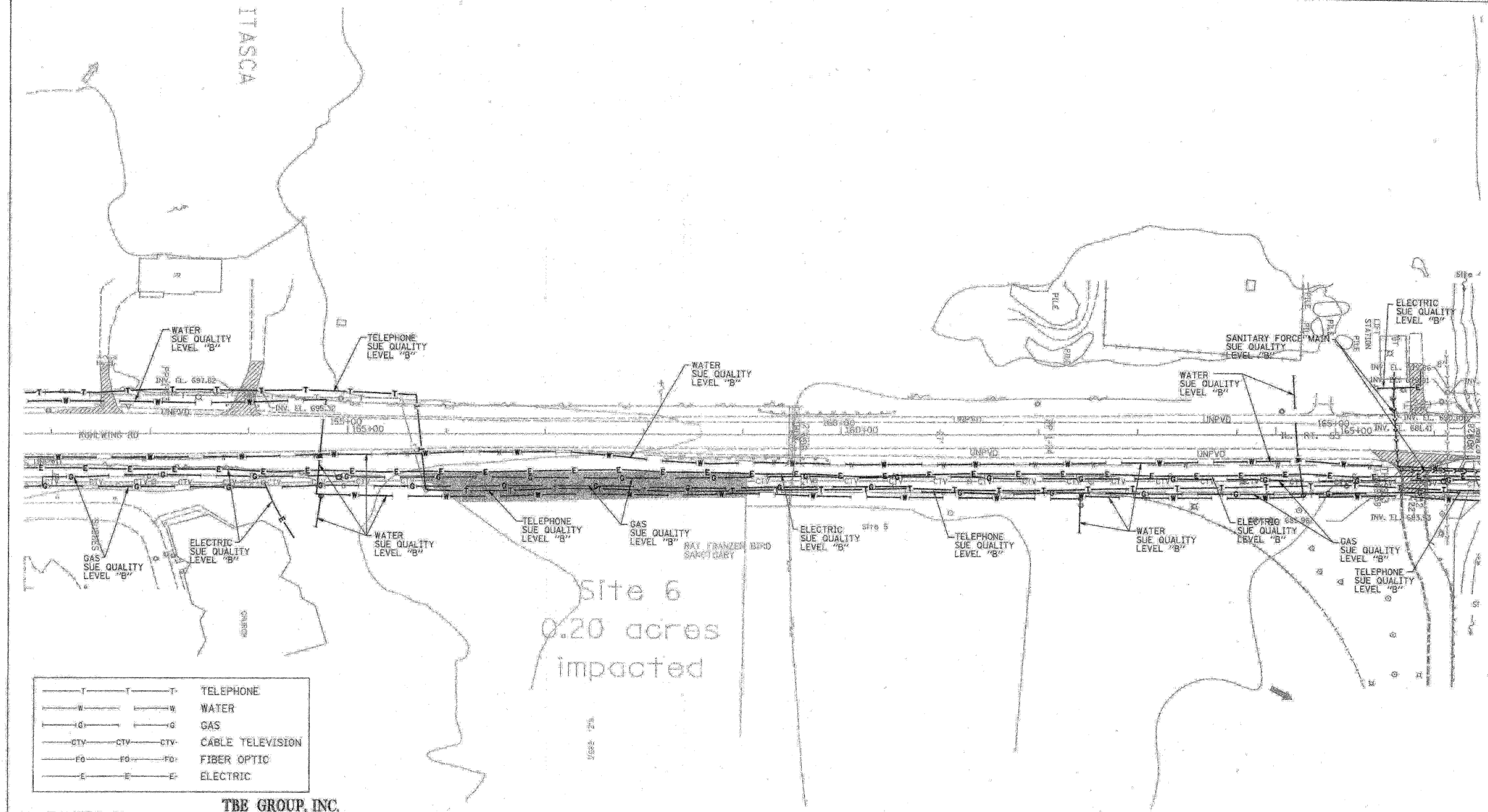

| | |
|---------------|------------------|
| —T—T—T—T— | TELEPHONE |
| —W—W—W—W— | WATER |
| —G—G—G—G— | GAS |
| —CTV—CTV—CTV— | CABLE TELEVISION |
| —FO—FO—FO— | FIBER OPTIC |
| —E—E—E—E— | ELECTRIC |

TBE GROUP, INC.
 CIVIL ENGINEERING * TRANSPORTATION * ENVIRONMENTAL
 * PLANNING * UTILITY ENGINEERING/LOCATING
 SOUTHERN REGION: FL, GA, SC, NC
 NORTHERN REGION: IL, IN, MI, OH, MD, NJ, NY
 PA, VA, CANADA
 WESTERN REGION: AZ, NV, NM, TX, CA, OR, UT, WA
 IL 09500146, IL 09500151, IL 09500152, IL 09500175
 TBE SUE PAGE NO: 12 OF 20
 Signature: *[Handwritten Signature]*
 SUE Quality Level "B" : Designating



205 W. WACKER DRIVE
 SUITE 1020
 CHICAGO, IL 60606
 (312) 704-1970

Utility shown on these plans as depicted in the legend have been investigated by TBE Group, Inc in accordance with SUE Industry Standards as of 5/27/03.
 All other information shown has been provided to TBE Group, Inc by others.

| REVISIONS | |
|-----------|------|
| NAME | DATE |
| | |
| | |
| | |
| | |
| | |
| | |
| | |
| | |
| | |
| | |

ILLINOIS DEPARTMENT OF TRANSPORTATION
 SUBSURFACE UTILITY ENGINEERING
 IL RT. 53 (ROHLWING ROAD)
 FROM MORELAND AVE TO HUNTINGTON AVE
 CONTRACT NO. 60477
 SCALE: 1"=50' DRAWN BY - KLC
 DATE - 7/14/03 CHECKED BY -