

**NOTE:**

THE CONTRACTOR SHALL MAINTAIN ACCESS TO THE EXISTING AND RELOCATED AGGREGATE PATHS AND CROSS WALKS.

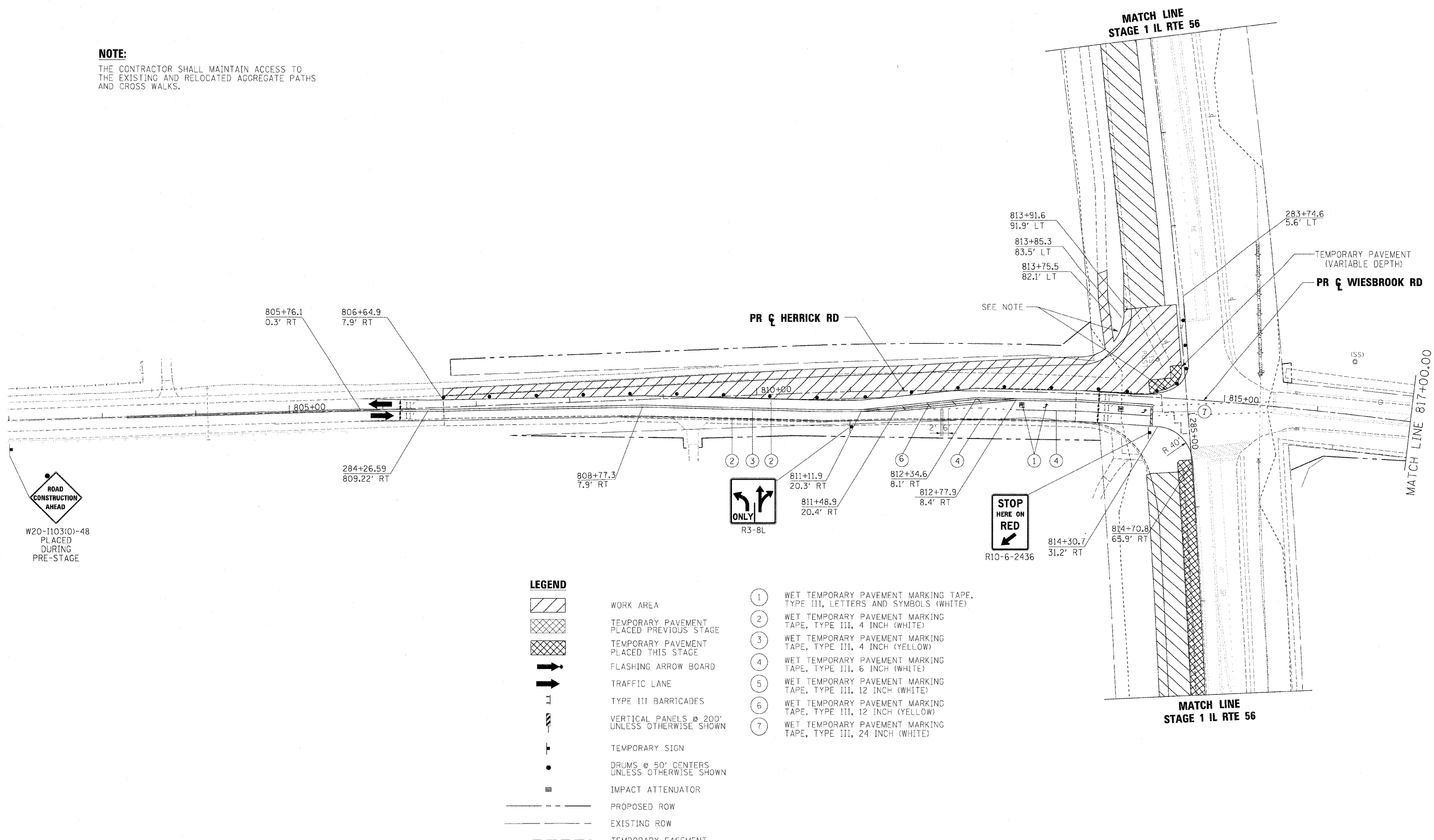

**ROAD CONSTRUCTION AHEAD**  
W20-1103(O)-48  
PLACED DURING PRE-STAGE

**LEGEND**

- WORK AREA
- TEMPORARY PAVEMENT PLACED PREVIOUS STAGE
- TEMPORARY PAVEMENT PLACED THIS STAGE
- FLASHING ARROW BOARD
- TRAFFIC LANE
- TYPE III BARRICADES
- VERTICAL PANELS @ 200' UNLESS OTHERWISE SHOWN
- TEMPORARY SIGN
- DRUMS @ 50' CENTERS UNLESS OTHERWISE SHOWN
- IMPACT ATTENUATOR
- PROPOSED ROW
- EXISTING ROW
- TEMPORARY EASEMENT

- ① WET TEMPORARY PAVEMENT MARKING TAPE, TYPE III, LETTERS AND SYMBOLS (WHITE)
- ② WET TEMPORARY PAVEMENT MARKING TAPE, TYPE III, 4 INCH (WHITE)
- ③ WET TEMPORARY PAVEMENT MARKING TAPE, TYPE III, 4 INCH (YELLOW)
- ④ WET TEMPORARY PAVEMENT MARKING TAPE, TYPE III, 6 INCH (WHITE)
- ⑤ WET TEMPORARY PAVEMENT MARKING TAPE, TYPE III, 12 INCH (WHITE)
- ⑥ WET TEMPORARY PAVEMENT MARKING TAPE, TYPE III, 12 INCH (YELLOW)
- ⑦ WET TEMPORARY PAVEMENT MARKING TAPE, TYPE III, 24 INCH (WHITE)

FILE NAME =	DESIGNED - JMM	REVISED -
...\\D162419-shr-HEF-staging-2-14.dgn	DRAWN - TMB	REVISED -
USER NAME = tblank	CHECKED - RMT	REVISED -
PLOT DATE = 12/7/2010	DATE - 12/6/10	REVISED -

**benesch**

**STATE OF ILLINOIS  
DEPARTMENT OF TRANSPORTATION**

**MAINTENANCE OF TRAFFIC PLAN  
STAGE 1-2 HERRICK**  
SCALE: 1"=50' SHEET NO. 47 OF 112 SHEETS STA. TO STA.

F.A.P. RTE.	SECTION	COUNTY	TOTAL SHEETS	SHEET NO.
365	(S7 & 58)WRS-2	DUPAGE	681	139
CONTRACT NO. 62419			ILLINOIS FED. AID PROJECT	