

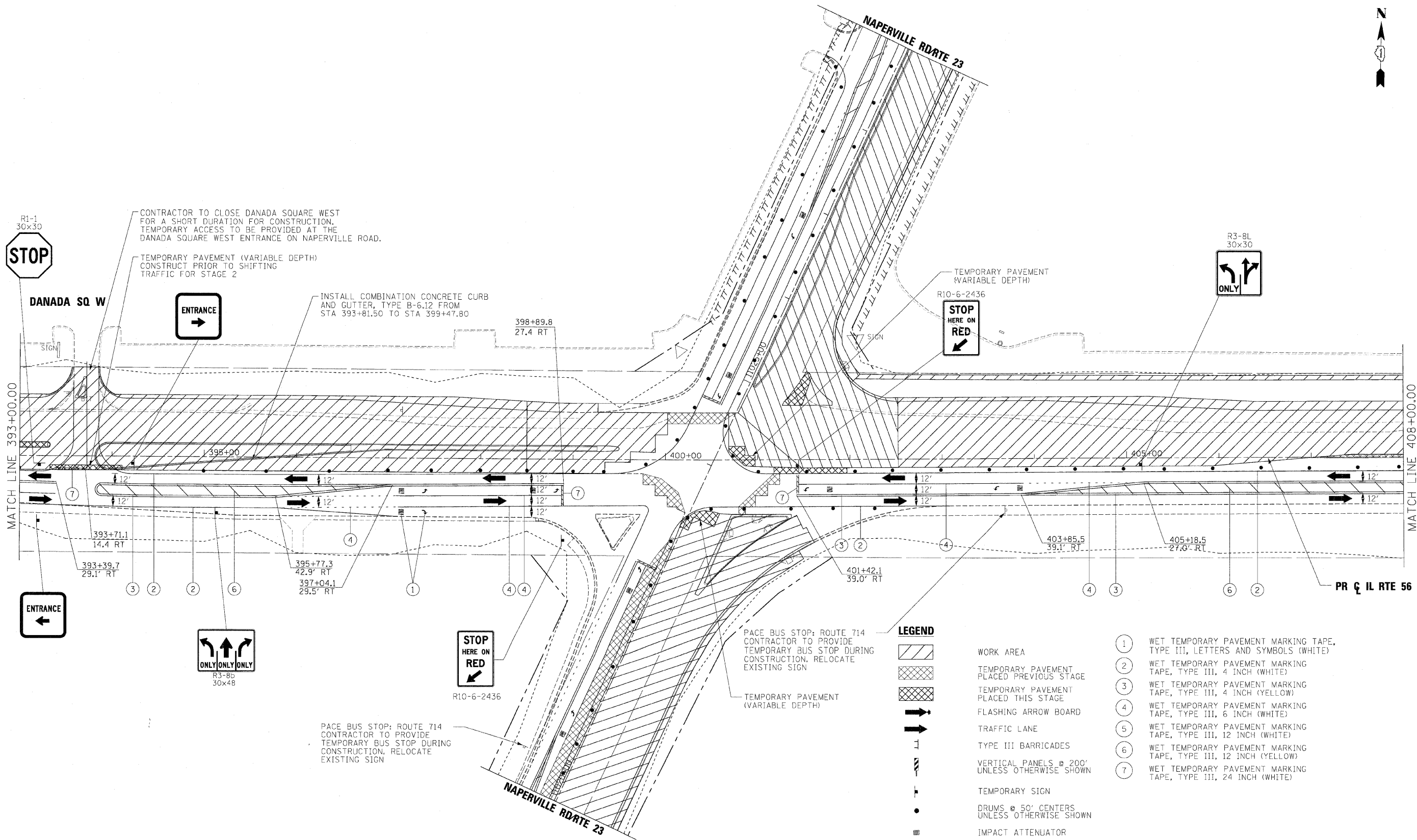

MATCH LINE 393+00.00

MATCH LINE 408+00.00



CONTRACTOR TO CLOSE DANADA SQUARE WEST FOR A SHORT DURATION FOR CONSTRUCTION. TEMPORARY ACCESS TO BE PROVIDED AT THE DANADA SQUARE WEST ENTRANCE ON NAPERVILLE ROAD.

TEMPORARY PAVEMENT (VARIABLE DEPTH) CONSTRUCT PRIOR TO SHIFTING TRAFFIC FOR STAGE 2

INSTALL COMBINATION CONCRETE CURB AND GUTTER, TYPE B-6.12 FROM STA 393+81.50 TO STA 399+47.80

TEMPORARY PAVEMENT (VARIABLE DEPTH)

R10-6-2436
**STOP
HERE ON
RED**

R3-8L
30x30
ONLY

R1-1
30x30
STOP

DANADA SQ W

ENTRANCE
→

ENTRANCE
←

ONLY ONLY ONLY
R3-8b
30x48

**STOP
HERE ON
RED**
R10-6-2436

PACE BUS STOP: ROUTE 714
CONTRACTOR TO PROVIDE
TEMPORARY BUS STOP DURING
CONSTRUCTION, RELOCATE
EXISTING SIGN

PACE BUS STOP: ROUTE 714
CONTRACTOR TO PROVIDE
TEMPORARY BUS STOP DURING
CONSTRUCTION, RELOCATE
EXISTING SIGN

TEMPORARY PAVEMENT
(VARIABLE DEPTH)

LEGEND

- WORK AREA
- TEMPORARY PAVEMENT PLACED PREVIOUS STAGE
- TEMPORARY PAVEMENT PLACED THIS STAGE
- FLASHING ARROW BOARD
- TRAFFIC LANE
- TYPE III BARRICADES
- VERTICAL PANELS @ 200' UNLESS OTHERWISE SHOWN
- TEMPORARY SIGN
- DRUMS @ 50' CENTERS UNLESS OTHERWISE SHOWN
- IMPACT ATTENUATOR
- PROPOSED ROW
- EXISTING ROW
- TEMPORARY EASEMENT

- ① WET TEMPORARY PAVEMENT MARKING TAPE, TYPE III, LETTERS AND SYMBOLS (WHITE)
- ② WET TEMPORARY PAVEMENT MARKING TAPE, TYPE III, 4 INCH (WHITE)
- ③ WET TEMPORARY PAVEMENT MARKING TAPE, TYPE III, 4 INCH (YELLOW)
- ④ WET TEMPORARY PAVEMENT MARKING TAPE, TYPE III, 6 INCH (WHITE)
- ⑤ WET TEMPORARY PAVEMENT MARKING TAPE, TYPE III, 12 INCH (WHITE)
- ⑥ WET TEMPORARY PAVEMENT MARKING TAPE, TYPE III, 12 INCH (YELLOW)
- ⑦ WET TEMPORARY PAVEMENT MARKING TAPE, TYPE III, 24 INCH (WHITE)

FILE NAME =	DESIGNED - JMM	REVISED -
... \D162419-sh-IL05-staging2-1-11.dgn	DRAWN - TMB	REVISED -
USER NAME = tbenk	CHECKED - RMT	REVISED -
PLOT DATE = 12/7/2010	DATE - 12/6/10	REVISED -

benesch

**STATE OF ILLINOIS
DEPARTMENT OF TRANSPORTATION**

**MAINTENANCE OF TRAFFIC PLAN
STAGE 2-1 IL RTE 56**
SCALE: 1"=50' SHEET NO.59 OF 112 SHEETS STA. 393+00 TO STA. 408+00

F.A.P. RTE.	SECTION	COUNTY	TOTAL SHEETS	SHEET NO.
365	(57 & 58)WRS-2	DUPAGE	681	151
ILLINOIS FED. AID PROJECT			CONTRACT NO. 62419	