

DATE	
BY	
FINAL SURVEY	
DESIGNED	
DRAWN	
CHECKED	
DATE	
REVISIONS	
NO.	

DATE	
BY	
ORIGINAL SURVEY	
DESIGNED	
DRAWN	
CHECKED	
DATE	
REVISIONS	
NO.	

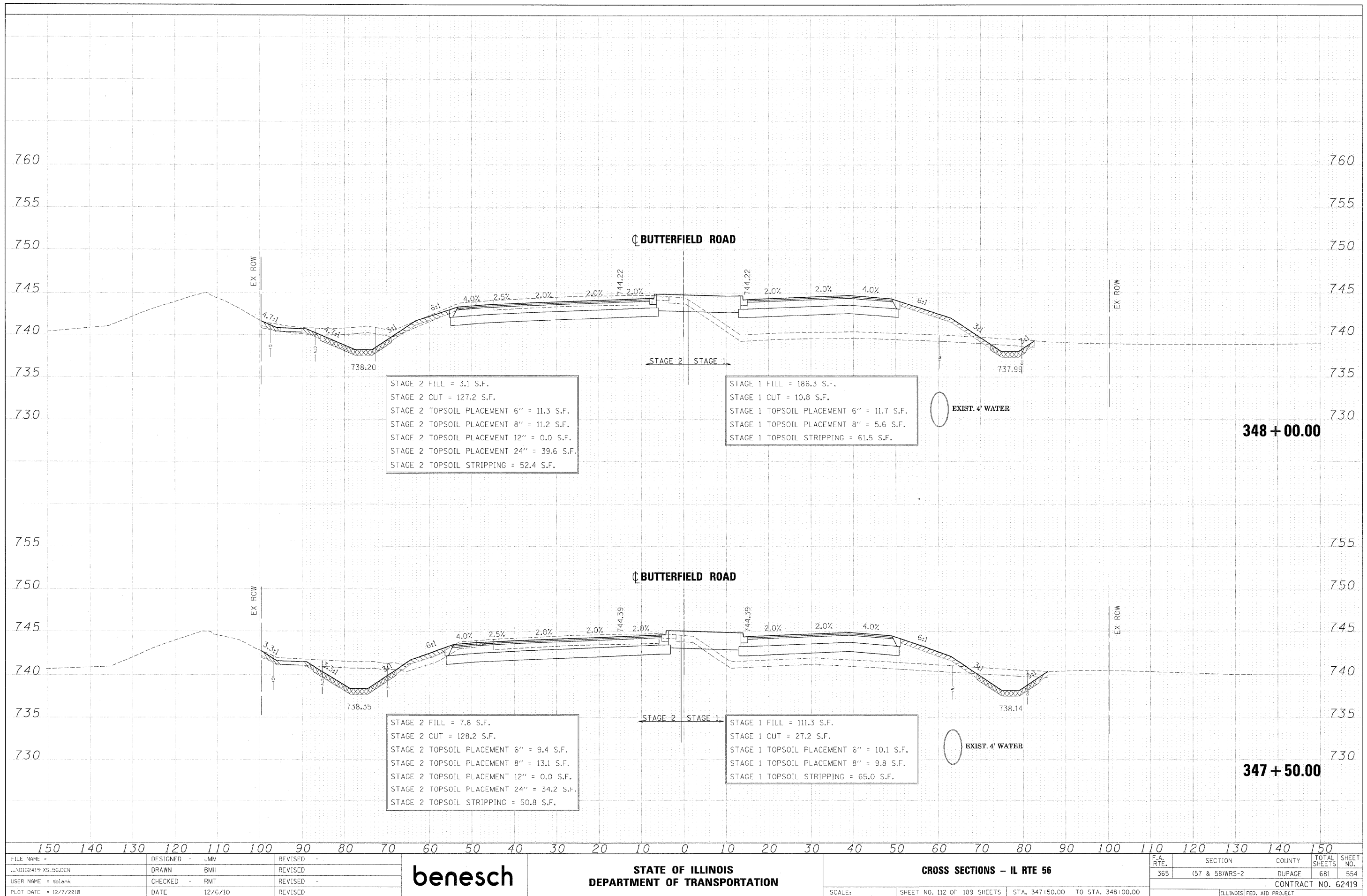

STAGE 2 FILL = 3.1 S.F.
 STAGE 2 CUT = 127.2 S.F.
 STAGE 2 TOPSOIL PLACEMENT 6" = 11.3 S.F.
 STAGE 2 TOPSOIL PLACEMENT 8" = 11.2 S.F.
 STAGE 2 TOPSOIL PLACEMENT 12" = 0.0 S.F.
 STAGE 2 TOPSOIL PLACEMENT 24" = 39.6 S.F.
 STAGE 2 TOPSOIL STRIPPING = 52.4 S.F.

STAGE 1 FILL = 186.3 S.F.
 STAGE 1 CUT = 10.8 S.F.
 STAGE 1 TOPSOIL PLACEMENT 6" = 11.7 S.F.
 STAGE 1 TOPSOIL PLACEMENT 8" = 5.6 S.F.
 STAGE 1 TOPSOIL STRIPPING = 61.5 S.F.

STAGE 2 FILL = 7.8 S.F.
 STAGE 2 CUT = 128.2 S.F.
 STAGE 2 TOPSOIL PLACEMENT 6" = 9.4 S.F.
 STAGE 2 TOPSOIL PLACEMENT 8" = 13.1 S.F.
 STAGE 2 TOPSOIL PLACEMENT 12" = 0.0 S.F.
 STAGE 2 TOPSOIL PLACEMENT 24" = 34.2 S.F.
 STAGE 2 TOPSOIL STRIPPING = 50.8 S.F.

STAGE 1 FILL = 111.3 S.F.
 STAGE 1 CUT = 27.2 S.F.
 STAGE 1 TOPSOIL PLACEMENT 6" = 10.1 S.F.
 STAGE 1 TOPSOIL PLACEMENT 8" = 9.8 S.F.
 STAGE 1 TOPSOIL STRIPPING = 65.0 S.F.

FILE NAME =	DESIGNED - JMM	REVISED -		STATE OF ILLINOIS				CROSS SECTIONS - IL RTE 56				
... \DI62419-XS_56.DGN	DRAWN - BMH	REVISED -		DEPARTMENT OF TRANSPORTATION				F.A. RTE.	SECTION	COUNTY	TOTAL SHEETS	SHEET NO.
USER NAME = tblank	CHECKED - RMT	REVISED -						365	(57 & 58)WRS-2	DUPAGE	681	554
PLOT DATE = 12/7/2010	DATE - 12/6/10	REVISED -						CONTRACT NO. 62419				
							ILLINOIS FED. AID PROJECT					