

DATE	
BY	
FINAL SURVEY	
REVISIONS	
NOTED	
PLOTTED	
TEMPLATE	
AREAS	
CHECKED	
NO.	

DATE	
BY	
ORIGINAL SURVEY	
REVISIONS	
NOTED	
PLOTTED	
TEMPLATE	
AREAS	
CHECKED	
NO.	

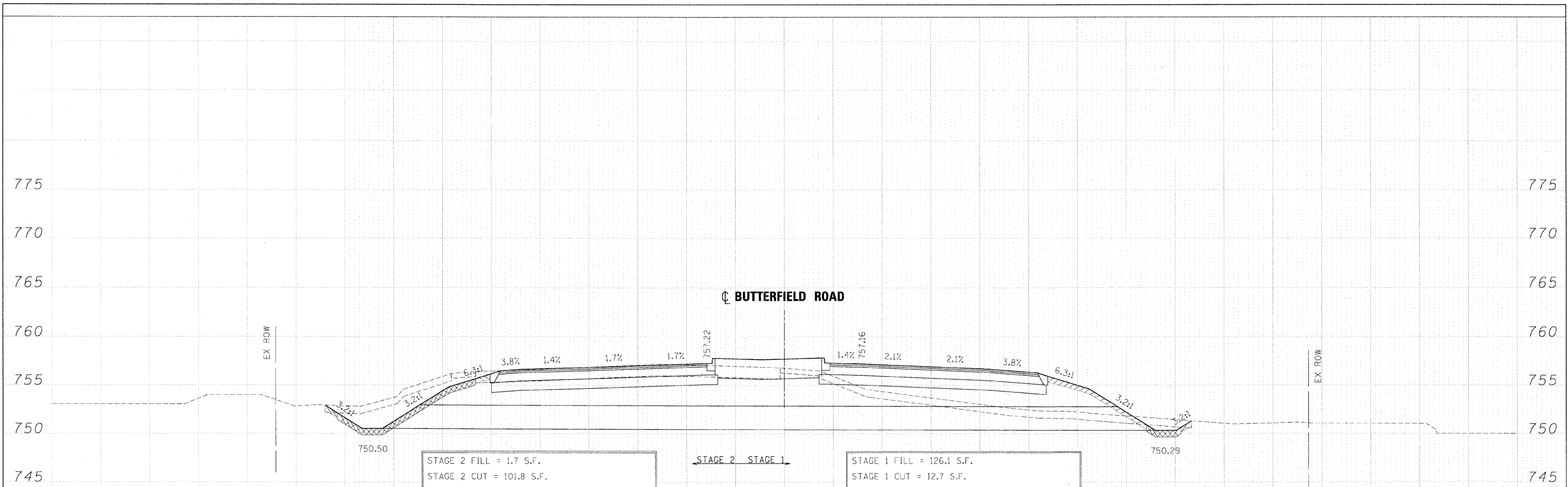

STAGE 2 FILL = 1.7 S.F.
 STAGE 2 CUT = 101.8 S.F.
 STAGE 2 TOPSOIL PLACEMENT 6" = 2.8 S.F.
 STAGE 2 TOPSOIL PLACEMENT 8" = 18.8 S.F.
 STAGE 2 TOPSOIL PLACEMENT 12" = 0.0 S.F.
 STAGE 2 TOPSOIL PLACEMENT 24" = 42.4 S.F.
 STAGE 2 TOPSOIL STRIPPING = 23.8 S.F.

STAGE 1 FILL = 126.1 S.F.
 STAGE 1 CUT = 12.7 S.F.
 STAGE 1 TOPSOIL PLACEMENT 6" = 11.4 S.F.
 STAGE 1 TOPSOIL PLACEMENT 8" = 4.7 S.F.
 STAGE 1 TOPSOIL STRIPPING = 56.8 S.F.

372 + 26.77

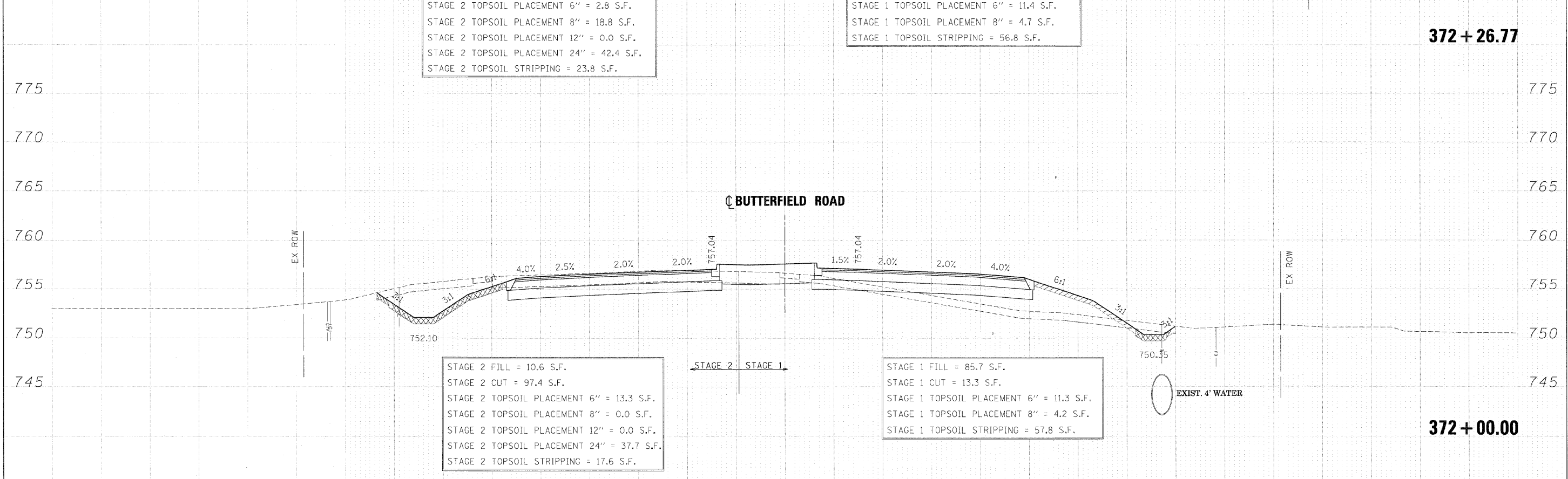

STAGE 2 FILL = 10.6 S.F.
 STAGE 2 CUT = 97.4 S.F.
 STAGE 2 TOPSOIL PLACEMENT 6" = 13.3 S.F.
 STAGE 2 TOPSOIL PLACEMENT 8" = 0.0 S.F.
 STAGE 2 TOPSOIL PLACEMENT 12" = 0.0 S.F.
 STAGE 2 TOPSOIL PLACEMENT 24" = 37.7 S.F.
 STAGE 2 TOPSOIL STRIPPING = 17.6 S.F.

STAGE 1 FILL = 85.7 S.F.
 STAGE 1 CUT = 13.3 S.F.
 STAGE 1 TOPSOIL PLACEMENT 6" = 11.3 S.F.
 STAGE 1 TOPSOIL PLACEMENT 8" = 4.2 S.F.
 STAGE 1 TOPSOIL STRIPPING = 57.8 S.F.

372 + 00.00

FILE NAME =	DESIGNED - JMM	REVISED -		STATE OF ILLINOIS		CROSS SECTIONS - IL RTE 56		F.A. RTE.	SECTION	COUNTY	TOTAL SHEETS	SHEET NO.
... \D162419-XS_56.DGN	DRAWN - BMH	REVISED -		DEPARTMENT OF TRANSPORTATION	365	(57 & 58)WRS-2	DUPAGE	681	579			
USER NAME = stlank	CHECKED - RMT	REVISED -		SCALE:	SHEET NO. 137 OF 189 SHEETS	STA. 372+00.00 TO STA. 372+26.77	CONTRACT NO. 62419		ILLINOIS FED. AID PROJECT			
PLOT DATE = 12/7/2018	DATE = 12/6/10	REVISED -										