

DATE	
BY	
FINISHED	
SUBMITTED	
DATE	
BY	
NO.	

DATE	
BY	
ORIGINAL	
SURVEY	
NOTE BOOK	
NO.	

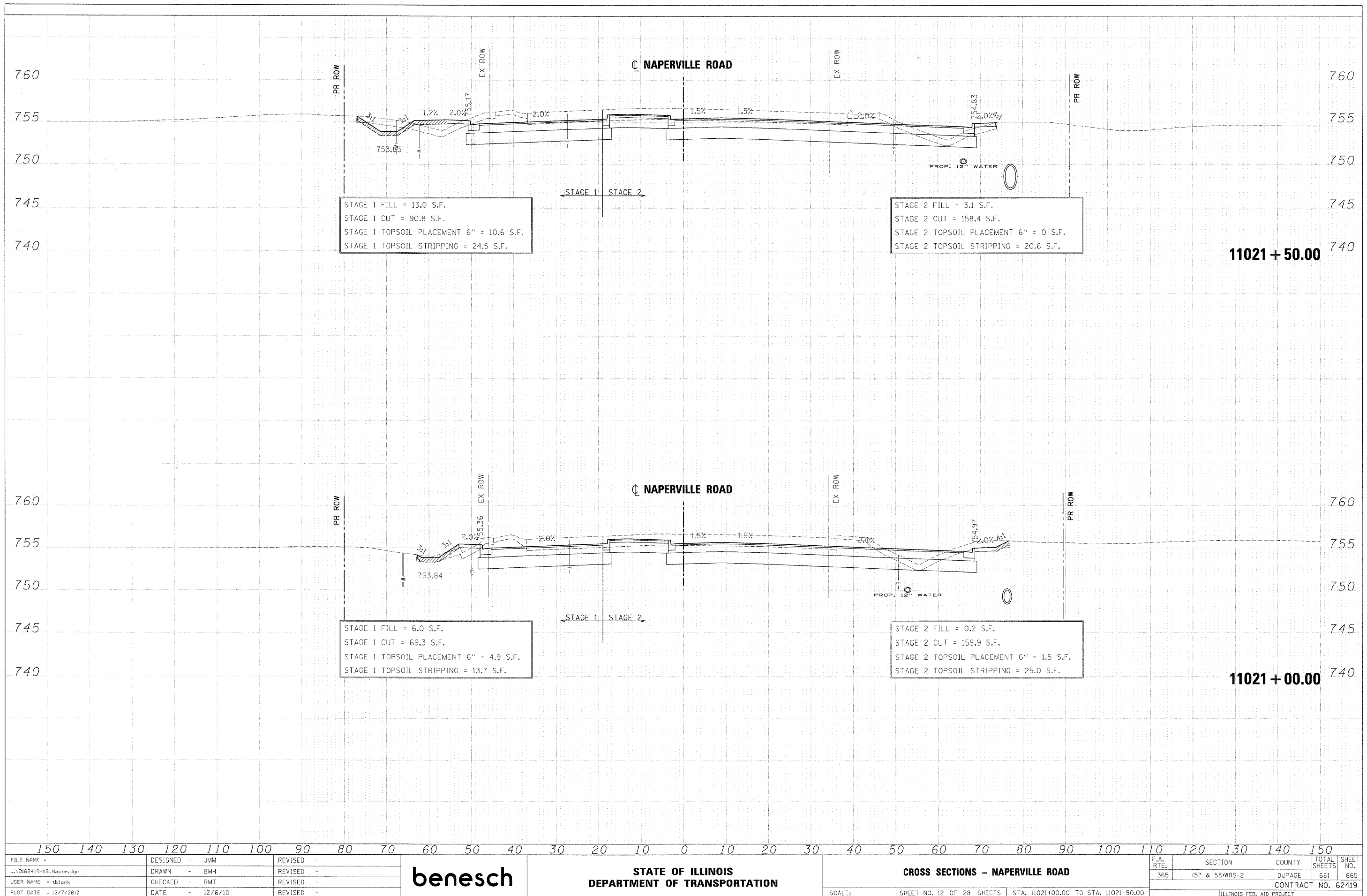

FILE NAME =	DESIGNED - JMM	REVISED -		STATE OF ILLINOIS		CROSS SECTIONS - NAPERVILLE ROAD		F.A. R.T.E.	SECTION	COUNTY	TOTAL SHEETS	SHEET NO.	
... \D162419-X5-Naper.dgn	DRAWN - BMH	REVISED -		DEPARTMENT OF TRANSPORTATION		SCALE:	SHEET NO. 12 OF 28 SHEETS	STA. 11021+00.00 TO STA. 11021+50.00	365	157 & 581WRS-2	DUPAGE	681	665
USER NAME = tbenk	CHECKED - RMT	REVISED -										CONTRACT NO. 62419	
PLOT DATE = 12/7/2010	DATE - 12/6/10	REVISED -										ILLINOIS FED. AID PROJECT	