

CITY OF WARRENVILLE

NW 1/4 SECTION 34 - 39 - 9

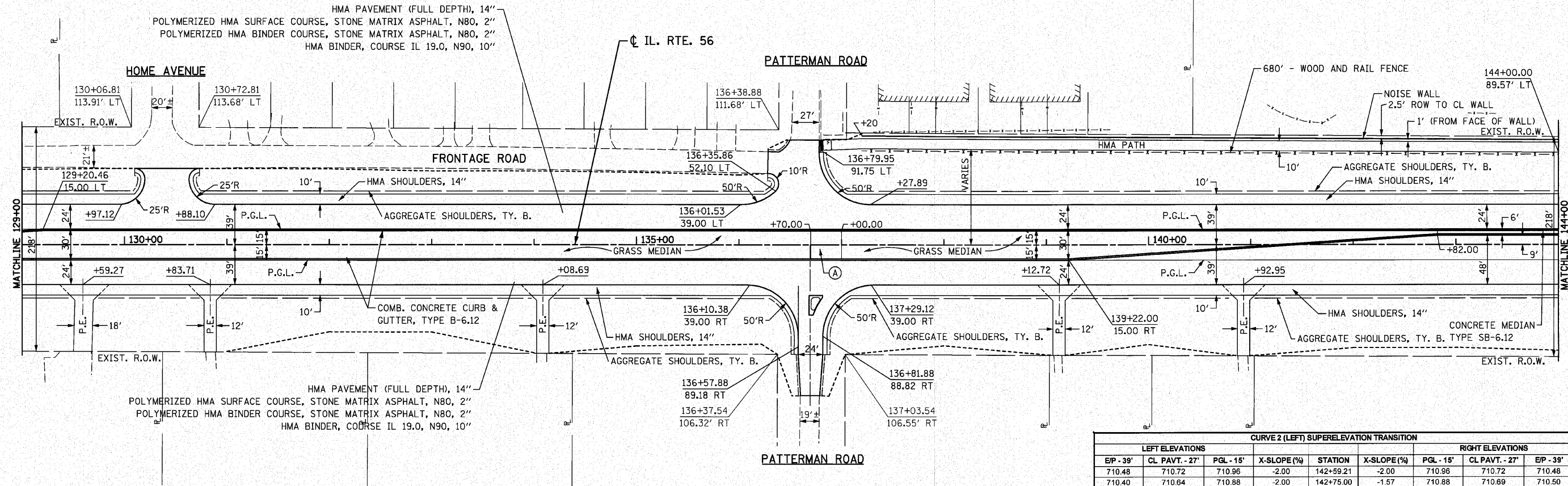

HMA PAVEMENT (FULL DEPTH), 14"
 POLYMERIZED HMA SURFACE COURSE, STONE MATRIX ASPHALT, N80, 2"
 POLYMERIZED HMA BINDER COURSE, STONE MATRIX ASPHALT, N80, 2"
 HMA BINDER, COURSE IL 19.0, N90, 10"

HMA PAVEMENT (FULL DEPTH), 14"
 POLYMERIZED HMA SURFACE COURSE, STONE MATRIX ASPHALT, N80, 2"
 POLYMERIZED HMA BINDER COURSE, STONE MATRIX ASPHALT, N80, 2"
 HMA BINDER, COURSE IL 19.0, N90, 10"

NOTES:

- 1. FOR HOME AVENUE AND PATTERNMAN ROAD INTERSECTIONS, SEE INTERSECTION DETAILS SHEET.
- (A) EMERGENCY ACCESS
 60' - DEPRESSED CURB AND GUTTER
 90 SQ YD - HMA SHOULDER, 14"
 SEE CROSS SECTION FOR DETAIL

CRA 16 ELEV. 715.99
 STA. 136+30.37 104.42' LT.
 N.W. BOLT ON FIRE HYDRANT

CURVE 2 (LEFT) SUPERELEVATION TRANSITION								
LEFT ELEVATIONS			X-SLOPE (%)	STATION	X-SLOPE (%)	RIGHT ELEVATIONS		
EP - 39'	CL PAVT. - 27'	PGL - 15'				PGL - 15'	CL PAVT. - 27'	EP - 39'
710.48	710.72	710.96	-2.00	142+59.21	-2.00	710.96	710.72	710.48
710.40	710.64	710.88	-2.00	142+75.00	-1.57	710.88	710.69	710.50
710.27	710.51	710.75	-2.00	143+00.00	-0.88	710.75	710.64	710.54
710.14	710.38	710.62	-2.00	143+25.00	-0.19	710.62	710.60	710.57
710.10	710.34	710.58	-2.00	143+31.82	0.00	710.58	710.58	710.58
710.01	710.25	710.49	-2.00	143+50.00	0.50	710.49	710.55	710.61
709.88	710.12	710.36	-2.00	143+75.00	1.19	710.36	710.50	710.65
709.75	709.99	710.23	-2.00	144+00.00	1.88	710.23	710.46	710.88
709.73	709.97	710.21	-2.00	144+04.43	2.00	710.21	710.45	710.69
709.69	709.94	710.19	-2.09	144+07.82	2.09	710.19	710.44	710.69
709.48	709.79	710.10	-2.57	144+25.00	2.57	710.10	710.41	710.72
709.24	709.61	709.99	-3.14	144+45.82	3.14	709.99	710.37	710.74

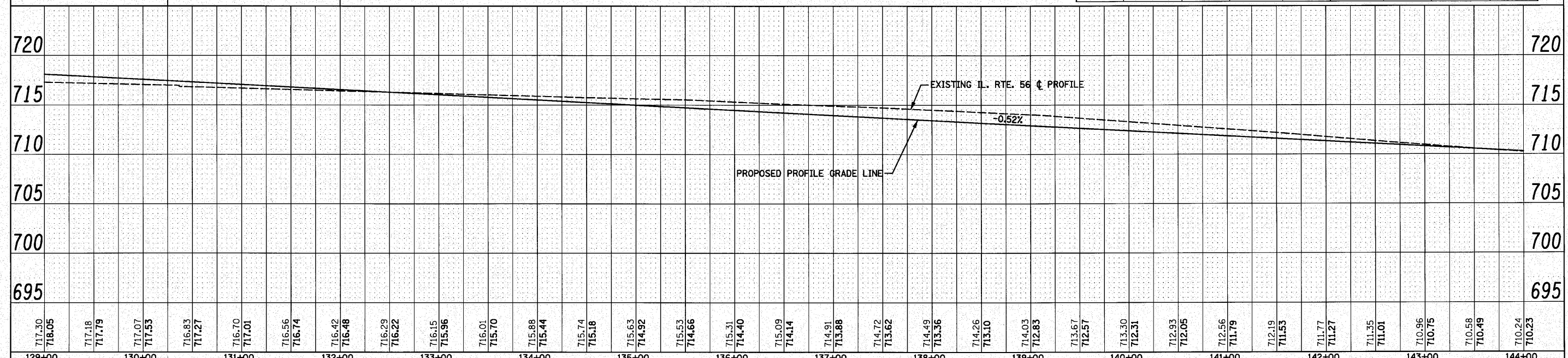

717.30	718.05	717.18	717.79	717.07	717.53	716.83	717.27	716.70	717.01	716.56	716.74	716.42	716.48	716.29	716.22	716.15	715.96	716.01	715.70	715.88	715.44	715.74	715.18	715.63	714.92	715.53	714.66	715.31	714.40	715.09	714.14	714.91	713.88	714.72	713.62	714.49	713.36	714.26	713.10	714.03	712.85	713.67	712.57	713.30	712.31	712.93	712.05	712.56	711.79	712.19	711.53	711.77	711.27	711.35	711.01	710.96	710.75	710.58	710.49	710.24	710.23
129+00	130+00	131+00	132+00	133+00	134+00	135+00	136+00	137+00	138+00	139+00	140+00	141+00	142+00	143+00	144+00																																														

FILE NAME = D162420-sh1-plnprf04.dgn
 PLOT DATE = 12/27/2010
 PLOT SCALE = 50.000' / IN.

CHRISTIAN-ROGE & ASSOCIATES, INC.
 ENGINEERS-PLANNERS-SURVEYORS
 211 WEST WACKER DRIVE
 CHICAGO, ILLINOIS 60606
 PHONE: (312)372-2023 FAX: (312)372-5274

DESIGNED - S.J.P.	REVISED -
DRAWN - B.K.	REVISED -
CHECKED - M.P.	REVISED -
DATE - DECEMBER 3, 2010	REVISED -

STATE OF ILLINOIS
DEPARTMENT OF TRANSPORTATION

ROADWAY PLAN AND PROFILE
IL. RTE. 56
 SCALE: 1" = 50'
 SHEET NO. 4 OF 12 SHEETS
 STA. 129+00 TO STA. 144+00

F.A.P. RTE. 365	SECTION (58859) WRS-3	COUNTY DuPAGE	TOTAL SHEETS 466	SHEET NO. 93
CONTRACT NO. 62420				
FED. ROAD DIST. NO. 1 ILLINOIS FED. AID PROJECT				