

NOTES:

1. FOR WINFIELD ROAD INTERSECTION, SEE DETAILS AND ELEVATIONS SHEET.

(A) HMA PAVEMENT (FULL DEPTH), 14"  
POLYMERIZED HMA SURFACE COURSE, STONE MATRIX ASPHALT, N80, 2"  
POLYMERIZED HMA BINDER COURSE, STONE MATRIX ASPHALT, N80, 2"  
HMA BINDER COURSE, IL-19.0, N90

BM 423 ELEV. 745.78  
STA. 228+78.05 19.63' RT.  
"□" CUT IN T.S. FOUNDATION

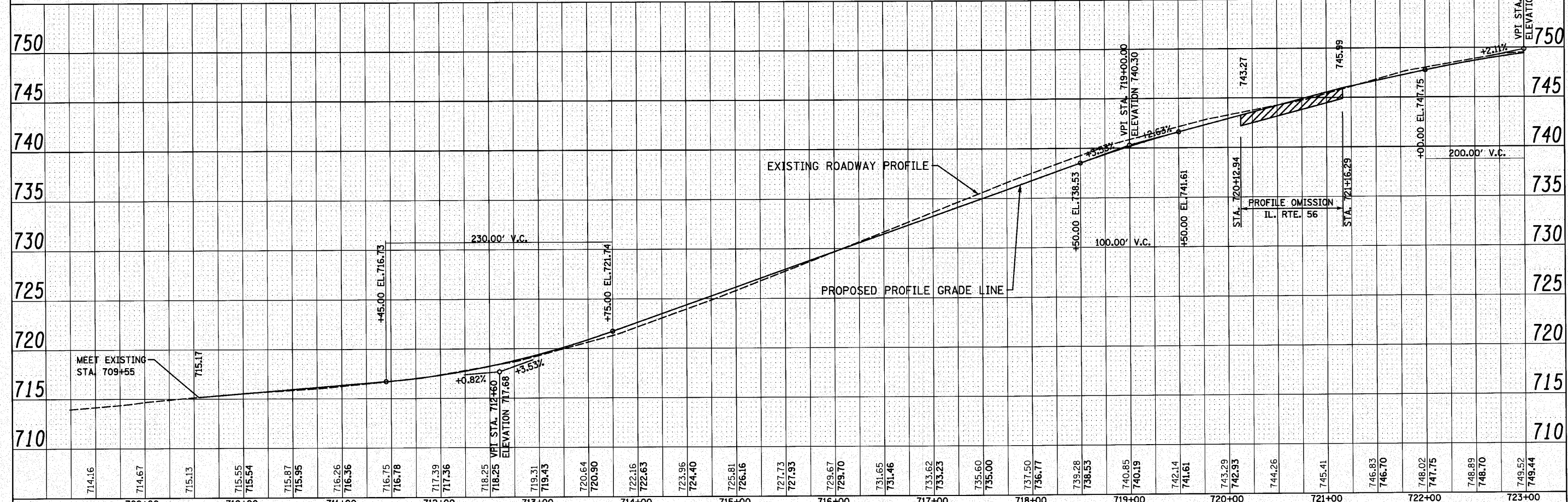

709+00	710+00	711+00	712+00	713+00	714+00	715+00	716+00	717+00	718+00	719+00	720+00	721+00	722+00	723+00															
714.16	714.67	715.13	715.55 715.54	715.87 715.95	716.26 716.36	716.75 716.78	717.39 717.36	718.25 718.25 VPI STA. 718+60 ELEVATION 717.68	719.31 719.43	720.64 720.90	722.16 722.63	723.96 724.40	725.81 726.16	727.73 727.93	729.67 729.70	731.65 731.46	733.62 733.23	735.60 735.00	737.50 736.77	739.28 738.53	740.85 740.19	742.14 741.61	743.29 742.93	744.26	745.41	746.83 746.70	748.02 747.75	748.89 748.70	749.52 749.44

FILE NAME =D162420-shr-plotr-fwin1.dgn  
PLOT DATE =12/2/2010  
PLOT SCALE=50.000' / IN.

CHRISTIAN-ROGE & ASSOCIATES, INC.  
ENGINEERS-PLANNERS-SURVEYORS  
211 WEST WACKER DRIVE  
CHICAGO, ILLINOIS 60606  
PHONE: (312)372-2023 FAX: (312)372-5274

DESIGNED - S.J.P. REVISIONS -  
DRAWN - B.K. REVISIONS -  
CHECKED - M.P. REVISIONS -  
DATE - DECEMBER 3, 2010 REVISIONS -

STATE OF ILLINOIS  
DEPARTMENT OF TRANSPORTATION

ROADWAY PLAN AND PROFILE  
WINFIELD ROAD  
SCALE: 1" = 50' SHEET NO. 1 OF 2 SHEETS STA. 709+55 TO STA. 723+00

F.A.P. RTE.	SECTION	COUNTY	TOTAL SHEETS	SHEET NO.
365	(58&59) WRS-3	DuPAGE	466	105

CONTRACT NO. 62420  
FED. ROAD DIST. NO. 1 ILLINOIS FED. AID PROJECT