

STATE OF ILLINOIS  
DEPARTMENT OF TRANSPORTATION

\* Order a(E), a<sub>1</sub>(E) & a<sub>3</sub>(E) bars full length.  
Cut to fit skew and use remainder of bars in opposite end.

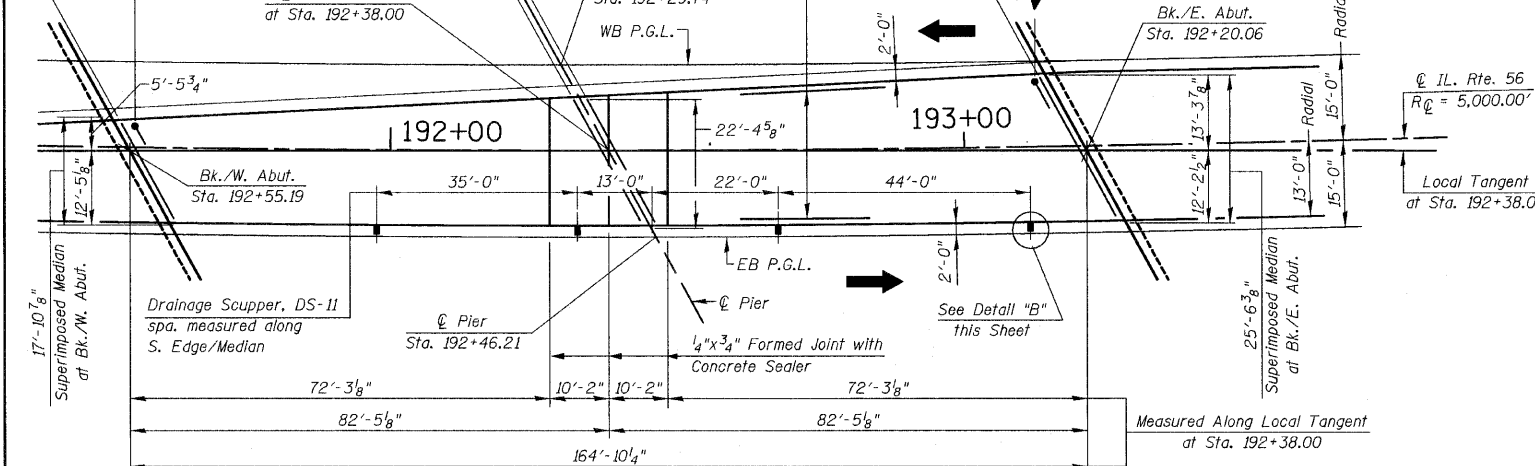
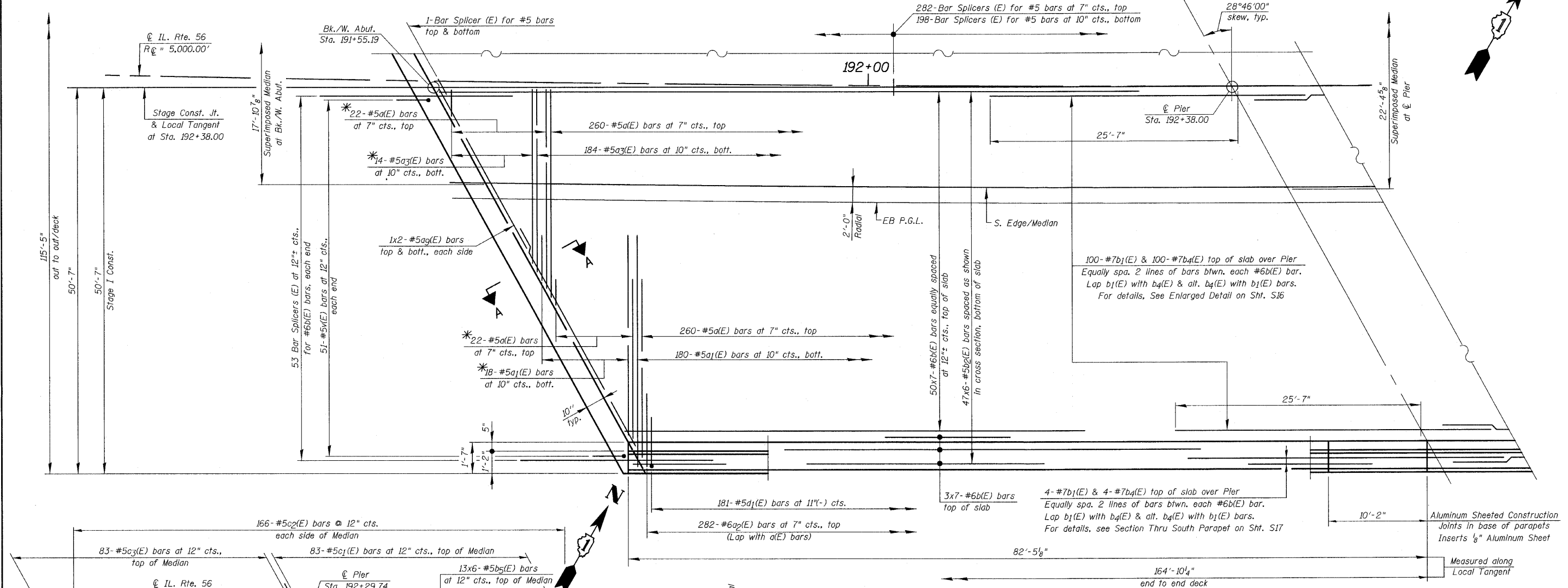

PARTIAL PLAN

MEDIAN PLAN

**MIN. BAR LAP:**  
#5 bars = 2'-6"  
#6 bars = 3'-0"  
#7 bars = 3'-11"

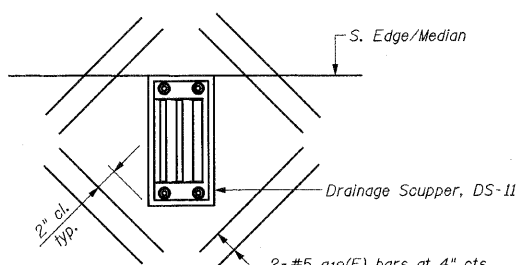

DETAIL "B"  
(4 Locations)

Notes:  
See Sht. S16 for Cross Section & Median Plan.  
See Sht. S17 for superstructure details and Bill of Material.  
Bars indicated thus 50x7-#6 etc., indicates 50 lines of bars with 7 lengths per line.  
See Sht. S22 for Section A-A.

**DECK PLAN-II**  
**IL. ROUTE 56 OVER**  
**WEST BRANCH DuPAGE RIVER**  
**F.A.P. RTE. 365**  
**SECTION (58&59) WRS-3**  
**DuPAGE COUNTY**  
**STA. 192+38.00**  
**STRUCTURE NO. 022-2027**

DESIGNED -
CHECKED -
DRAWN -
CHECKED -

**CR & A**  
CHRISTIAN-ROGE & ASSOCIATES, INC.  
ENGINEERS-PLANNERS-SURVEYORS  
211 WEST WACKER DRIVE  
CHICAGO, ILLINOIS 60606  
PHONE: (312)372-2023 FAX: (312)372-5274

SHEET NO. S15	F.A. RTE. 365	SECTION (58&59) WRS-3	COUNTY DuPAGE	TOTAL SHEETS 466	SHEET NO. 221
S43 SHEETS	CONTRACT NO. 62420		ILLINOIS FED. AID PROJECT		