

WEST BRANCH DUPAGE RIVER

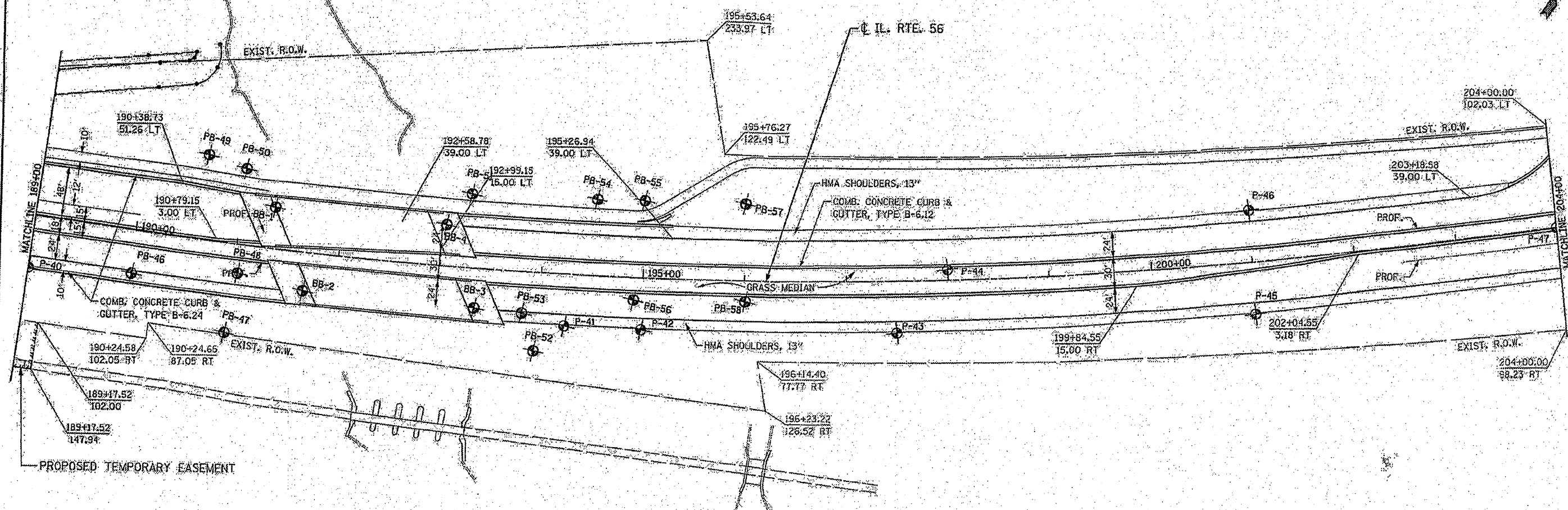

WESTBOUND

PB-49 PB-51 PB-55 PB-57 P-44 P-46

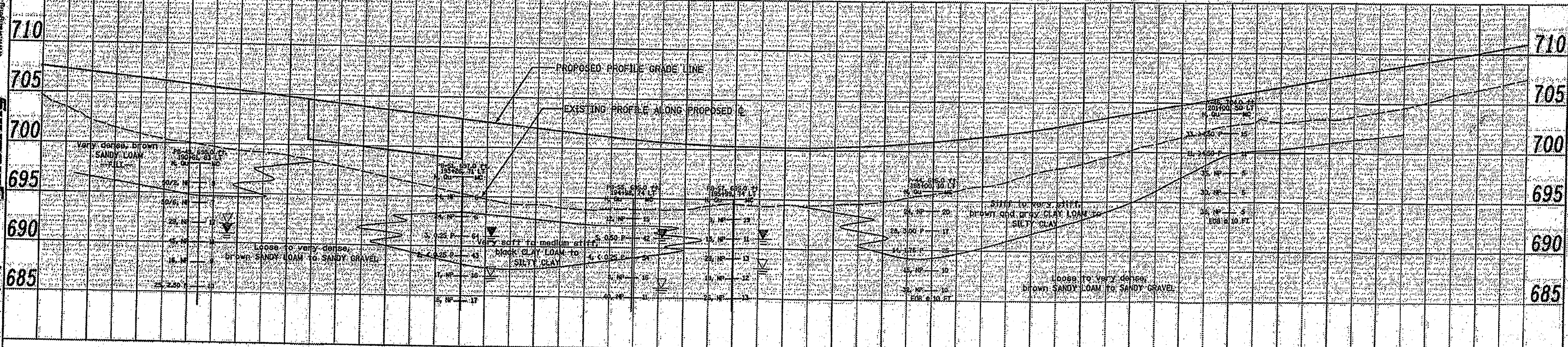

**Wang Engineering**  
 1146 N. Main Street  
 Lombard, IL 60148  
 Phone: (630) 653-8828  
 www.wangeng.com

FILE NAME: >FILES<	CHRISTIAN-ROSE & ASSOCIATES, INC. ENGINEERS-PLANNERS-SURVEYORS 211 WEST WACKER DRIVE CHICAGO, ILLINOIS 60604 PHONE: (312) 774-1924 FAX: (312) 772-6274	DESIGNED - S.J.P.	REVISED -	STATE OF ILLINOIS DEPARTMENT OF TRANSPORTATION	BORING LOCATION PLAN AND SOIL PROFILE IL RTE 56	F.A.P. -	SECTION -	COUNTY -	TOTAL SHEETS -	
PLOT DATE: >DATE<		DRAWN - B.R.S.	REVISED -			365	(58&59) NRS-23	DUPAGE	466	328
PLOT SCALE: >SCALE<		CHECKED - M.P.	REVISED -			CONTRACT NO. 62420				
		DATE - JUNE 2009	REVISED -			SCALE: 1" = 50'    SHEET NO. 9 OF 32 SHEETS    STA. 189+00    TO STA. 204+00 FED. ROAD DIST. NO. 1 ILLINOIS FED. AID PROJECT				