

DATE	
BY	
FINAL SURVEY	
SURVEYED	
TEMPLATE	
NOTE BOOK	
AREAS CHECKED	
NO.	

DATE	
BY	
ORIGINAL SURVEY	
SURVEYED	
TEMPLATE	
NOTE BOOK	
AREAS CHECKED	
NO.	

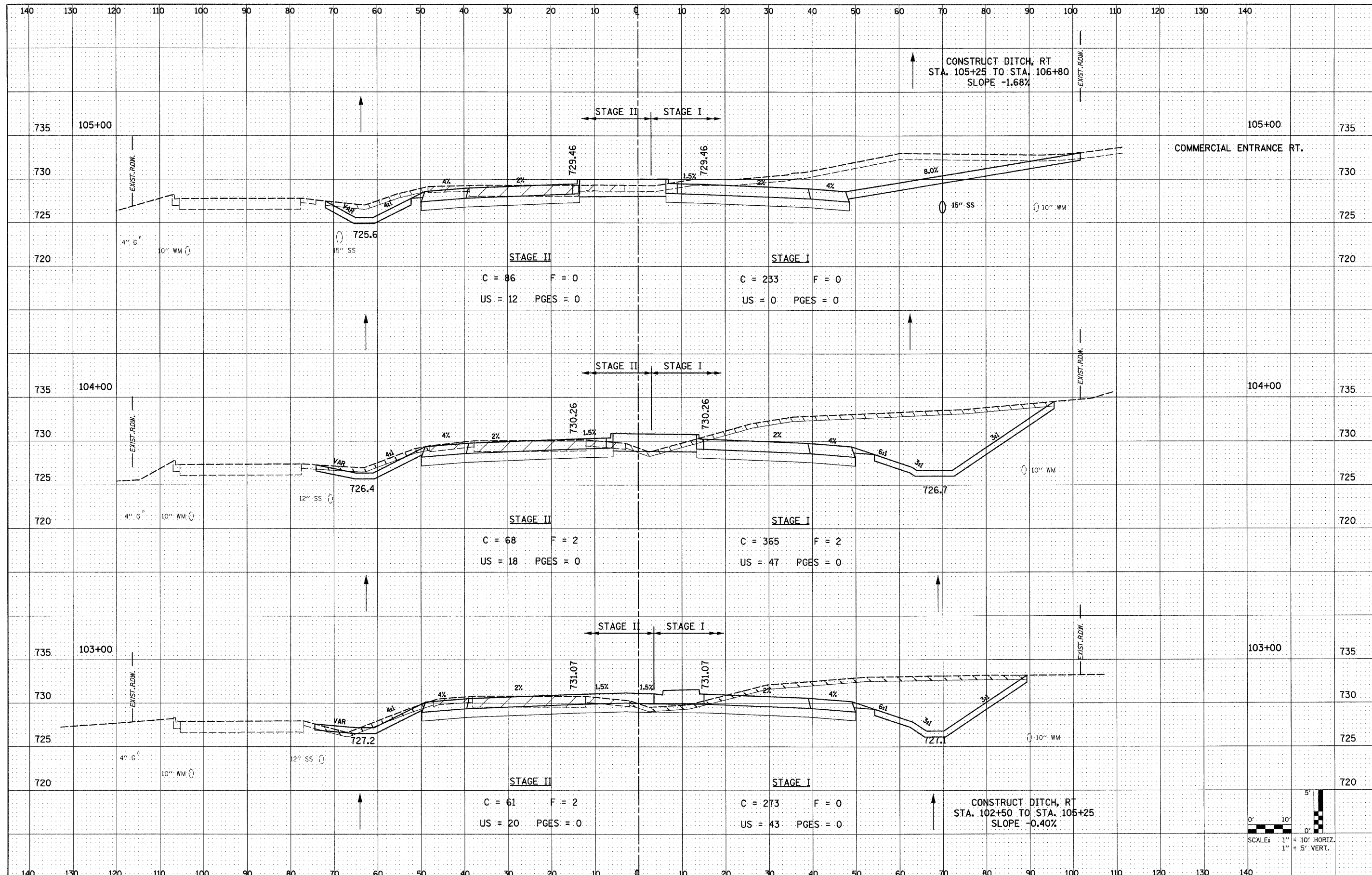

FILE NAME = D:\62420-shr-xshht.dgn
 PLOT DATE = 12/3/2012
 PLOT SCALE = 100.000 / IN.

CHRISTIAN-ROGE & ASSOCIATES, INC.
 ENGINEERS-PLANNERS-SURVEYORS
 211 WEST WACKER DRIVE
 CHICAGO, ILLINOIS 60606
 PHONE: (312)372-2023 FAX: (312)372-5274

DESIGNED -	S.J.P.	REVISED -	
DRAWN -	W.A.M.	REVISED -	
CHECKED -	M.P.	REVISED -	
DATE -	DECEMBER 3, 2010	REVISED -	

STATE OF ILLINOIS
DEPARTMENT OF TRANSPORTATION

CROSS SECTIONS
IL. RTE. 56
 SCALE: NONE SHEET NO. 6 OF 74 SHEETS STA. TO STA.

F.A.P. RTE.	SECTION	COUNTY	TOTAL SHEETS	SHEET NO.
365	(58&59) WRS-3	DuPAGE	466	343
FED. ROAD DIST. NO. 1 ILLINOIS FED. AID PROJECT			CONTRACT NO. 62420	

