

BY	DATE
BY	DATE
BY	DATE
BY	DATE
BY	DATE
BY	DATE
BY	DATE
BY	DATE
BY	DATE
BY	DATE

ORIGINAL SURVEY	SURVEYED
NOTE BOOK	PLOTTED
NO.	DATE
	DATE
	DATE
	DATE
	DATE
	DATE
	DATE
	DATE
	DATE

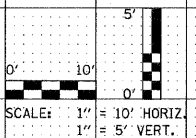
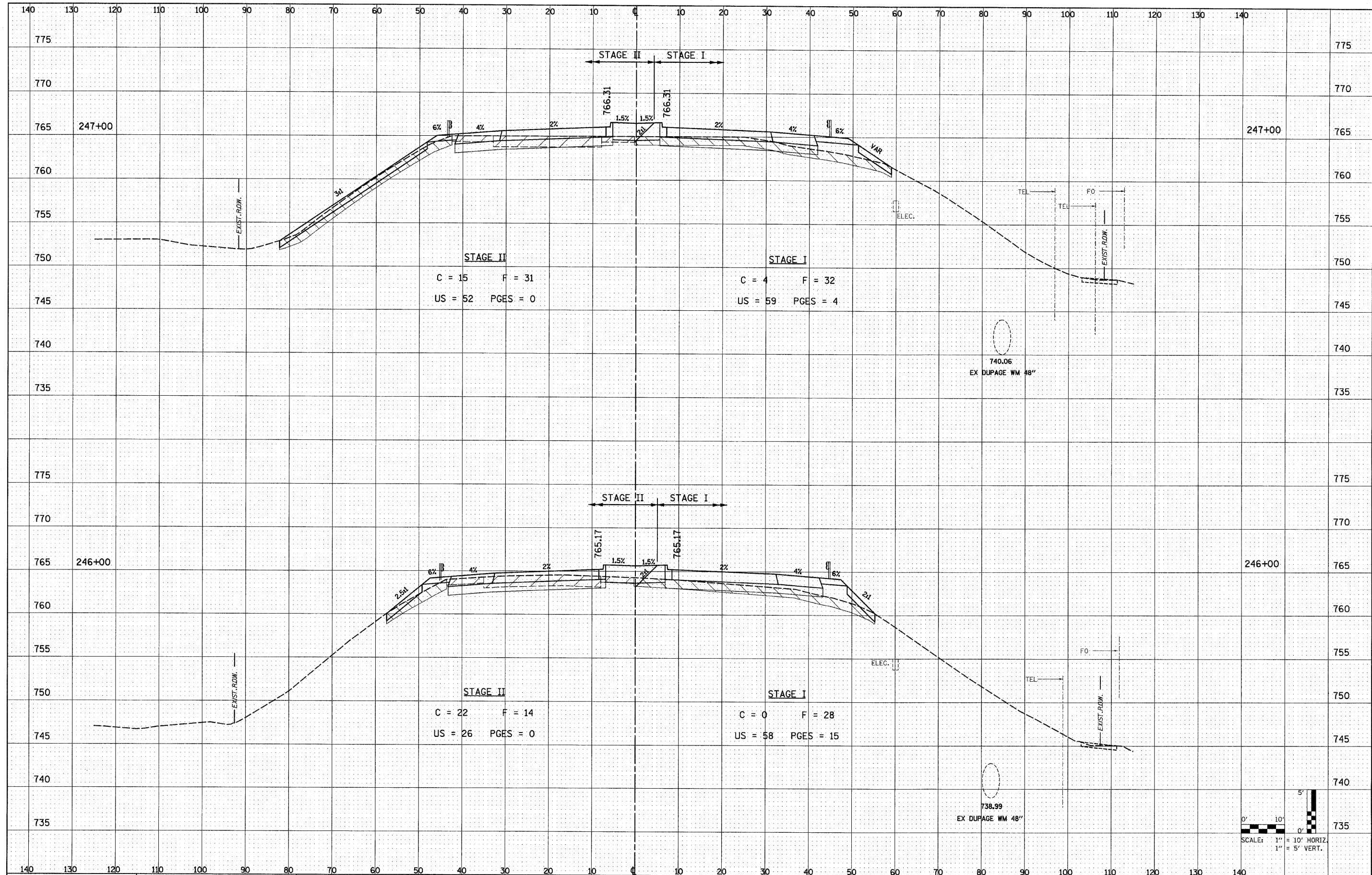

FILE NAME = D162428-sht-xasht.dgn
 PLOT DATE = 12/3/2010
 PLOT SCALE = 100.000 / IN.

CHRISTIAN ROGE & ASSOCIATES, INC.
 ENGINEERS-PLANNERS-SURVEYORS
 211 WEST WACKER DRIVE
 CHICAGO, ILLINOIS 60606
 PHONE: (312)372-2023 FAX: (312)372-5274

DESIGNED	- S.J.P.	REVISED	-
DRAWN	- W.A.M.	REVISED	-
CHECKED	- M.P.	REVISED	-
DATE	- DECEMBER 3, 2010	REVISED	-

**STATE OF ILLINOIS
 DEPARTMENT OF TRANSPORTATION**

**CROSS SECTIONS
 IL. RTE. 56**

SCALE: NONE SHEET NO. 70 OF 74 SHEETS STA. TO STA.

F.A.P. RTE. 365	SECTION (58&59) WRS-3	COUNTY DuPAGE	TOTAL SHEETS 466	SHEET NO. 407
FED. ROAD DIST. NO. 1 ILLINOIS FED. AID PROJECT			CONTRACT NO. 62420	