

INDEX OF SHEETS
FOR INDEX OF SHEETS, SEE SHEET NO. 2

PROJECT LOCATED IN:
VILLAGE OF FRANKFORT
AND FRANKFORT TOWNSHIP
OF WILL COUNTY, ILLINOIS

DESIGN DESIGNATION
2,100(16) PRINCIPAL ARTERIAL 4.27 (PCC-30)

TRAFFIC DATA

	ADT (2000)	DESIGN SPEED	POSTED SPEED
U.S. ROUTE 30	15,000	50 MPH	45 MPH
PFEIFFER ROAD	4,000	35 MPH	35 MPH
80TH AVENUE (NORTH)	4,800	25 MPH	25 MPH
80TH AVENUE (SOUTH)	1,200	20 MPH	20 MPH
FRANKFORT SQUARE	4,000	30 MPH	30 MPH
HUNTERWOODS DRIVE	1,000	25 MPH	25 MPH
HARLEM AVENUE (SOUTH LEG)	19,800	45 MPH	45 MPH
HARLEM AVENUE (NORTH LEG)	13,000	45 MPH	55 MPH

DESCRIPTION OF PROJECT

THIS IMPROVEMENT CONSISTS OF EARTH EXCAVATION, RECONSTRUCTION AND WIDENING OF ROADWAYS, CONSTRUCTION OF STORM SEWERS AND DRAINAGE STRUCTURES, BOX CULVERT CONSTRUCTION, MODERNIZATION OF TRAFFIC SIGNALS, AND WIDENING OF US ROUTE BRIDGE OVER HICKORY CREEK (SN 099-0311).

PERMITTING

ALL WORK SHALL BE IN COMPLIANCE WITH THE FOLLOWING PERMITS:
US ARMY CORPS OF ENGINEERS - SECTION 404 PERMIT
IDNR-OWR - FLOODWAY PERMIT
IEPA - NPDES

STATE OF ILLINOIS
DEPARTMENT OF TRANSPORTATION
DIVISION OF HIGHWAYS
PLANS FOR PROPOSED HIGHWAY
F.A.P. ROUTE 353 - U.S. ROUTE 30 (LINCOLN HIGHWAY)
SECTION: (12 & 13) WRS-4
U.S. ROUTE 45 (96TH AVENUE) TO
ILLINOIS ROUTE 43 (HARLEM AVENUE)
ROADWAY RECONSTRUCTION AND
TRAFFIC SIGNAL MODERNIZATION AND INSTALLATION
PROJECT NO.: ACNHF-0353(019)
WILL COUNTY
C-91-218-02

F.A.P. RTE.	SECTION	COUNTY	TOTAL SHEETS	SHEET NO.
353	(12&13)WRS-4	WILL	608	1

CONTRACT NO. 62478 *L08+1709

D-91-218-02

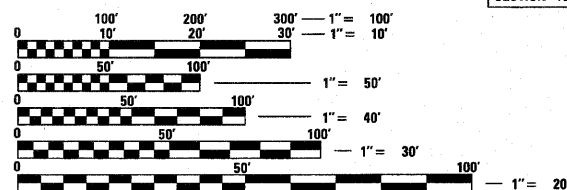
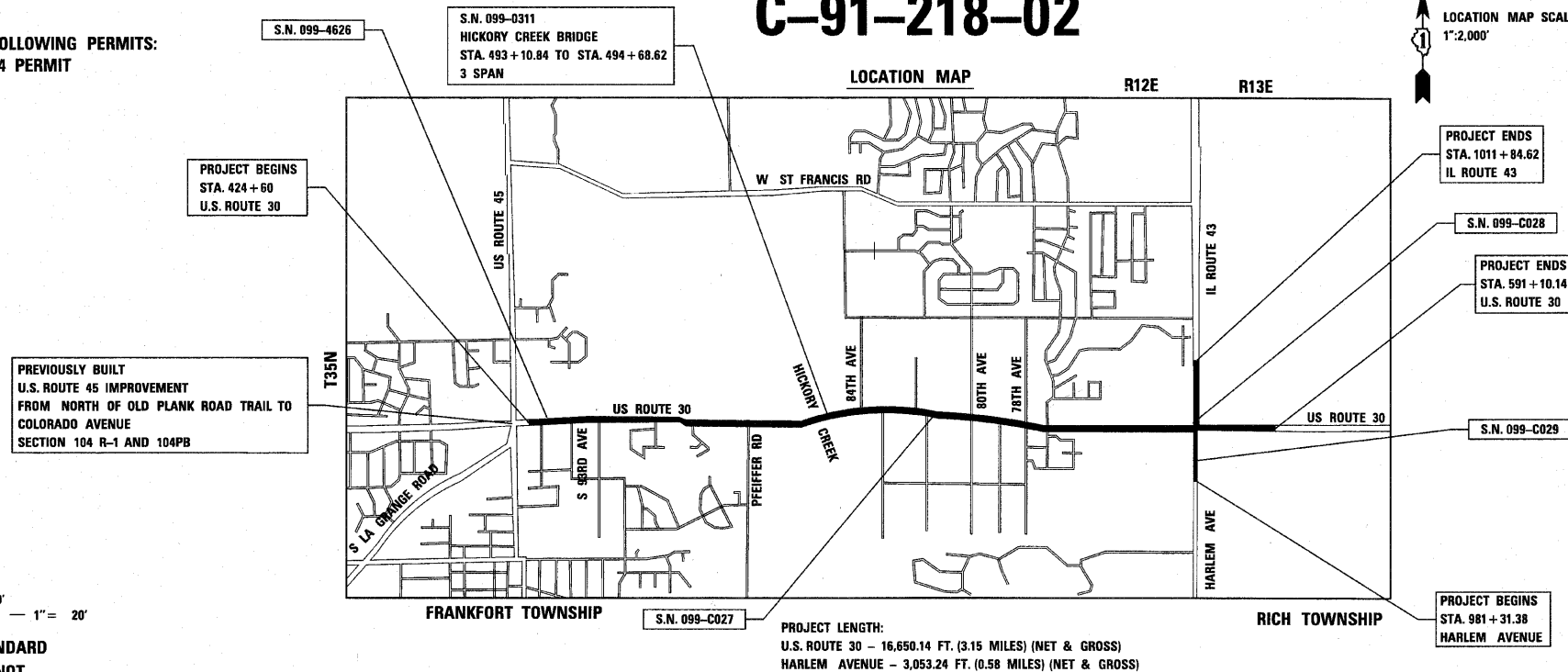
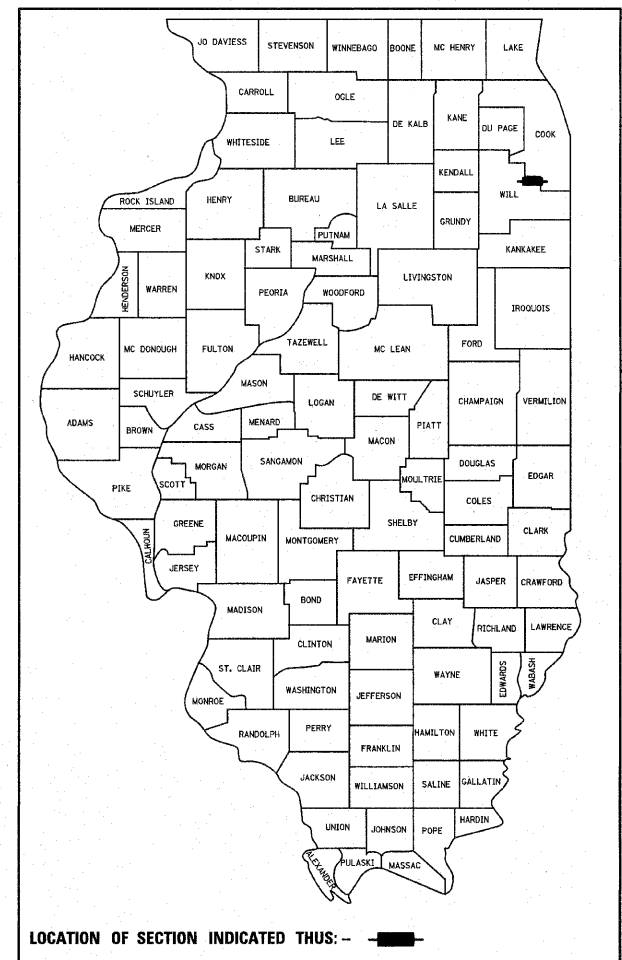

FULL SIZE PLANS HAVE BEEN PREPARED USING STANDARD ENGINEERING SCALES. REDUCED SIZED PLANS WILL NOT CONFORM TO STANDARD SCALES. IN MAKING MEASUREMENTS ON REDUCED PLANS, THE ABOVE SCALES MAY BE USED.

J.U.L.I.E.
JOINT UTILITY LOCATION INFORMATION FOR EXCAVATION
1-800-892-0123 OR 811

SIGNED: [Signature]
DATE: 6/10/2010
EXPIRES 11-30-2011
FOR DRAWINGS 1-216, 230-363, 494-608

SIGNED: [Signature]
DATE: 6/10/2010
EXPIRES 11-30-2011
FOR DRAWINGS 408-439, 493

SIGNED: [Signature]
DATE: 6/9/10
EXPIRES 11-30-2011
FOR DRAWINGS 364-406

STATE OF ILLINOIS
DEPARTMENT OF TRANSPORTATION
DIVISION OF HIGHWAYS

SUBMITTED: JUNE 10, 2010

[Signature]
DEPUTY DIRECTOR OF HIGHWAYS, REGION ONE ENGINEER

December 10, 2010

[Signature]
ENGINEER OF DESIGN AND ENVIRONMENT

December 10, 2010

[Signature]
DIRECTOR OF HIGHWAYS, CHIEF ENGINEER

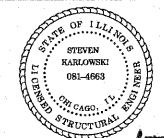

SIGNED: [Signature]
DATE: 6/10/2010
EXPIRES 11-30-2010
FOR DRAWINGS 440-492



450 E. Devon Ave., Suite 300 - Itasca, Illinois 60143
Tel: 630.773.3900 - Fax: 630.773.3975
www.civiltechinc.com

PRINTED BY THE AUTHORITY OF THE STATE OF ILLINOIS

IDOT DISTRICT ONE DESIGN CONSULTANT SERVICES MANAGER: RAJENDRA SHAH (847) 705-4555

CONTRACT NO. 62478