

F.A.P. RTE.	SECTION	COUNTY	TOTAL SHEETS	SHEET NO.
353	(12&13)WRS-4	WILL	608	98
STA. 495+00		TO STA. 525+00		
FED. ROAD DIST. NO. 7 ILLINOIS FED. AID PROJECT				

NOTES:
SEE SHEET NO. 90-91 FOR DRAINAGE CALL-OFFS.

DIRECT ACCESS TO THE RESIDENTIAL PROPERTIES ALONG THE NORTH SIDE OF U.S. ROUTE 30 (STA. 504+00 TO 510+00) MAY NOT BE POSSIBLE THROUGHOUT STAGE 1 CONSTRUCTION DUE TO THE LARGE DIFFERENCE BETWEEN THE EXISTING AND PROPOSED GRADES. A QUANTITY OF ONE TEMPORARY ACCESS (ROAD) HAS BEEN INCLUDED FOR THE CONSTRUCTION OF A TEMPORARY ACCESS TO THE PROPERTIES FROM THE WEST END AT STA. 504+00. THIS WORK SHALL BE AS DIRECTED AND APPROVED BY THE ENGINEER.

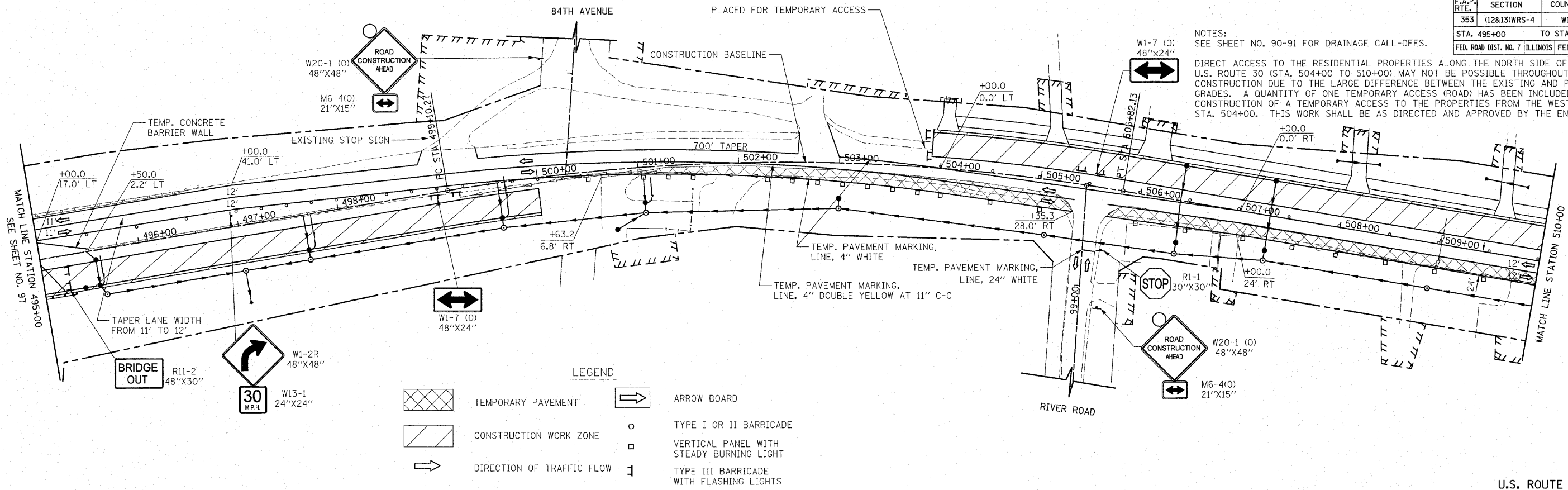

LEGEND

- TEMPORARY PAVEMENT
- CONSTRUCTION WORK ZONE
- DIRECTION OF TRAFFIC FLOW
- ARROW BOARD
- TYPE I OR II BARRICADE
- VERTICAL PANEL WITH STEADY BURNING LIGHT
- TYPE III BARRICADE WITH FLASHING LIGHTS

U.S. ROUTE 30

NOTE:

DIRECT ACCESS TO THE PROPERTIES ALONG THE NORTH SIDE OF U.S. ROUTE 30 (STA. 516+00 TO 521+25) MAY NOT BE POSSIBLE THROUGHOUT STAGE 1 CONSTRUCTION DUE TO THE LARGE DIFFERENCE BETWEEN THE EXISTING AND PROPOSED GRADES. A QUANTITY OF TWO TEMPORARY ACCESS (ROAD) HAS BEEN INCLUDED FOR THE CONSTRUCTION OF TEMPORARY ACCESS TO THE PROPERTIES FROM THE EAST AND WEST END OF THIS SECTION. THIS WORK SHALL BE AS DIRECTED AND APPROVED BY THE ENGINEER.

MAINLINE AND DETENTION SEWER ALONG NORTH SIDE OF U.S. ROUTE 30 TO BE CONSTRUCTED AFTER COMPLETION OF THE BOX CULVERT.

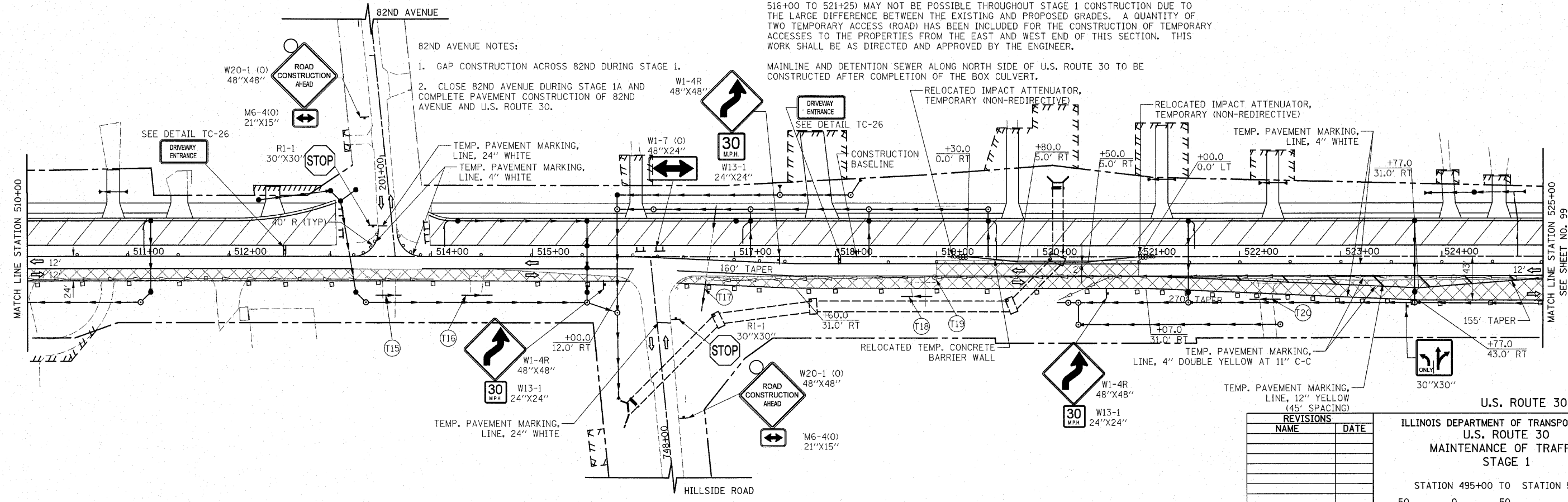

- 82ND AVENUE NOTES:**
- GAP CONSTRUCTION ACROSS 82ND DURING STAGE 1.
 - CLOSE 82ND AVENUE DURING STAGE 1A AND COMPLETE PAVEMENT CONSTRUCTION OF 82ND AVENUE AND U.S. ROUTE 30.

REVISIONS

NAME	DATE

ILLINOIS DEPARTMENT OF TRANSPORTATION
U.S. ROUTE 30
MAINTENANCE OF TRAFFIC
STAGE 1

STATION 495+00 TO STATION 525+00

SCALE IN FEET
DATE 6/11/2010

DRAWN BY DJK
CHECKED BY JRV