

F.A.P. RTE.	SECTION	COUNTY	TOTAL SHEETS	SHEET NO.
353	(12&13)WRS-4	WILL	608	99
STA. 525+00		TO STA. 554+00		
FED. ROAD DIST. NO. 1 ILLINOIS FED. AID PROJECT				

80TH AVENUE NOTES:

1. GAP CONSTRUCTION ACROSS 80TH AND CONSTRUCT TEMPORARY PAVEMENT ON 80TH DURING STAGE 1 (USING STANDARD 701501).
2. RESTRICT TRAFFIC TO ONE-WAY NORTHBOUND ON THE NORTH LEG OF 80TH DURING STAGE 1A AND CONSTRUCT WESTERN HALF OF 80TH PAVEMENT.
3. SHIFT NORTHBOUND TRAFFIC TO PERMANENT PAVEMENT AND CONSTRUCT EASTERN HALF OF PAVEMENT.

NOTES:

SEE SHEET NO. 90-91 FOR DRAINAGE CALL-OFFS.

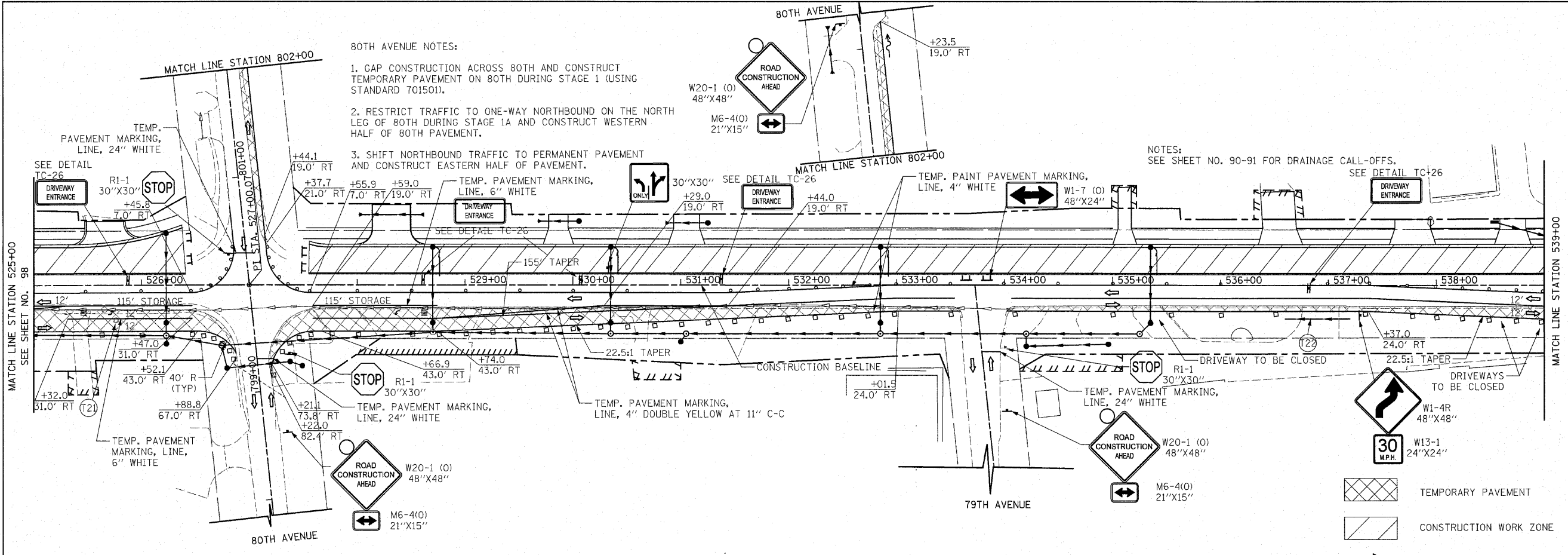

LEGEND

- ARROW BOARD
- TYPE I OR II BARRICADE
- VERTICAL PANEL WITH STEADY BURNING LIGHTS
- TYPE III BARRICADE WITH FLASHING LIGHT
- TEMPORARY PAVEMENT
- CONSTRUCTION WORK ZONE
- DIRECTION OF TRAFFIC FLOW
- U.S. ROUTE 30

78TH AVENUE NOTES:

1. GAP CONSTRUCTION ACROSS 78TH DURING STAGE 1.
2. RESTRICT TRAFFIC TO ONE-WAY SOUTHBOUND ON THE NORTH LEG OF 78TH DURING STAGE 1A AND CONSTRUCT WESTERN HALF OF 78TH PAVEMENT.
3. SHIFT SOUTHBOUND TRAFFIC TO PERMANENT PAVEMENT AND CONSTRUCT EASTERN HALF OF PAVEMENT.

FRANKFORD SQUARE NOTES:

1. GAP CONSTRUCTION ACROSS FRANKFORD SQUARE DURING STAGE 1.
2. CLOSE FRANKFORD SQUARE DURING STAGE 1A AND COMPLETE CONSTRUCTION OF FRANKFORD SQUARE AND U.S. ROUTE 30.

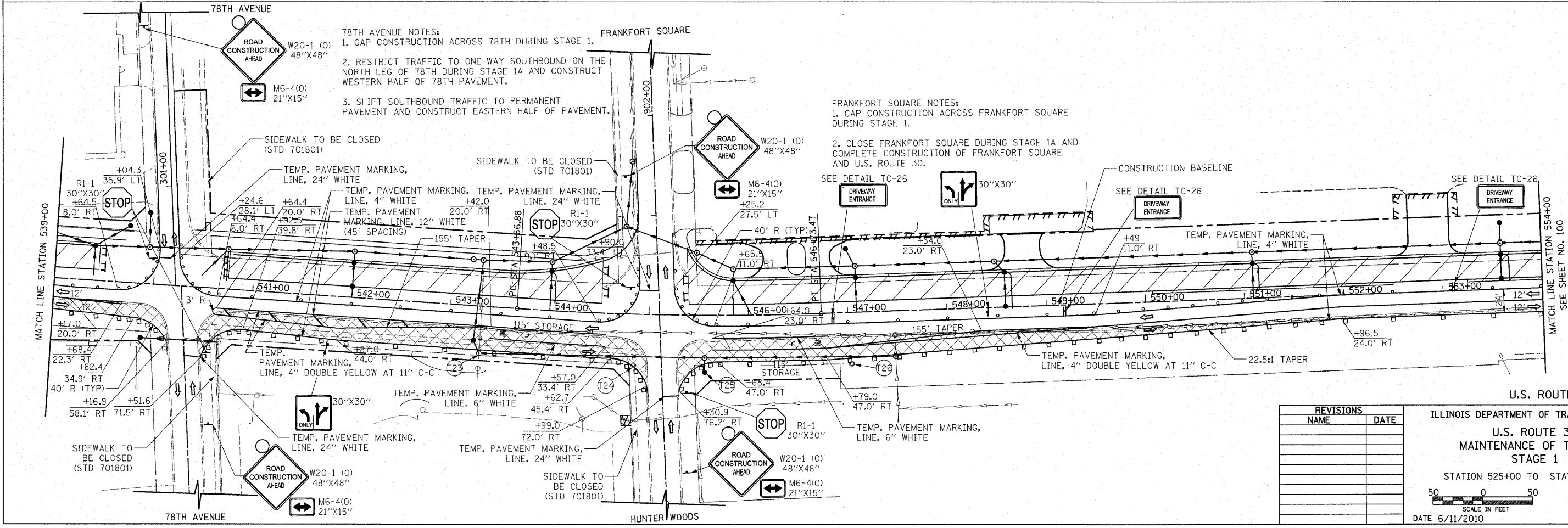

REVISIONS	
NAME	DATE

ILLINOIS DEPARTMENT OF TRANSPORTATION
 U.S. ROUTE 30
 MAINTENANCE OF TRAFFIC
 STAGE 1
 STATION 525+00 TO STATION 554+00
 SCALE IN FEET
 DATE 6/11/2010
 DRAWN BY DJK
 CHECKED BY JRV