

F.A.P. RTE.	SECTION	COUNTY	TOTAL SHEETS	SHEET NO.
353	(12&13)WRS-4	WILL	608	102
STA. 976+00		TO STA. 998+00		
FED. ROAD DIST. NO. 1 ILLINOIS FED. AID PROJECT				

NOTES:
SEE SHEET NO. 90-91 FOR DRAINAGE CALL-OFFS.

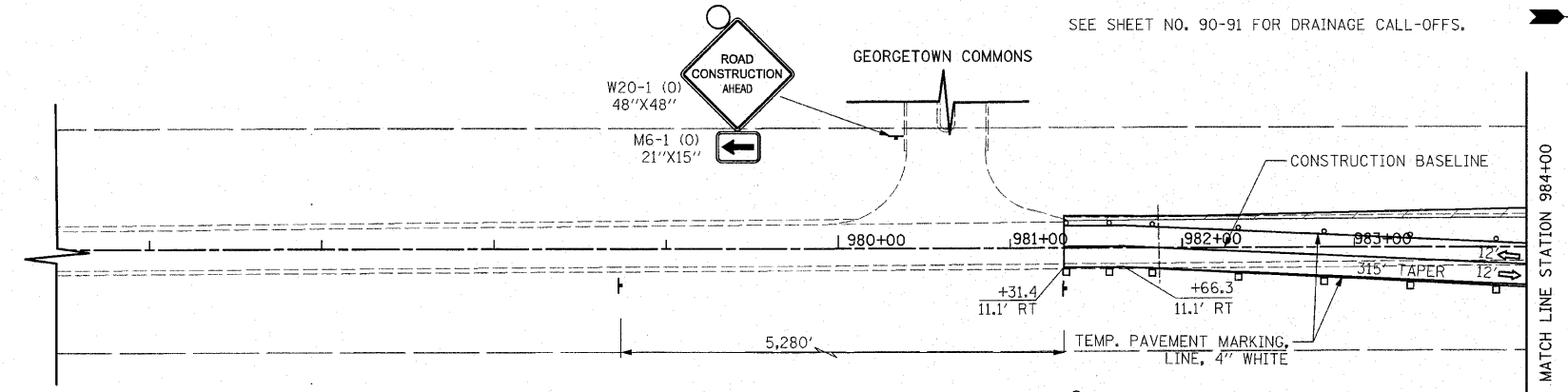

- LEGEND**
- TEMPORARY PAVEMENT
 - CONSTRUCTION WORK ZONE
 - DIRECTION OF TRAFFIC FLOW
 - ARROW BOARD
 - TYPE I OR II BARRICADE
 - VERTICAL PANEL WITH STEADY BURNING LIGHT
 - TYPE III BARRICADE WITH FLASHING LIGHTS

HARLEM AVENUE

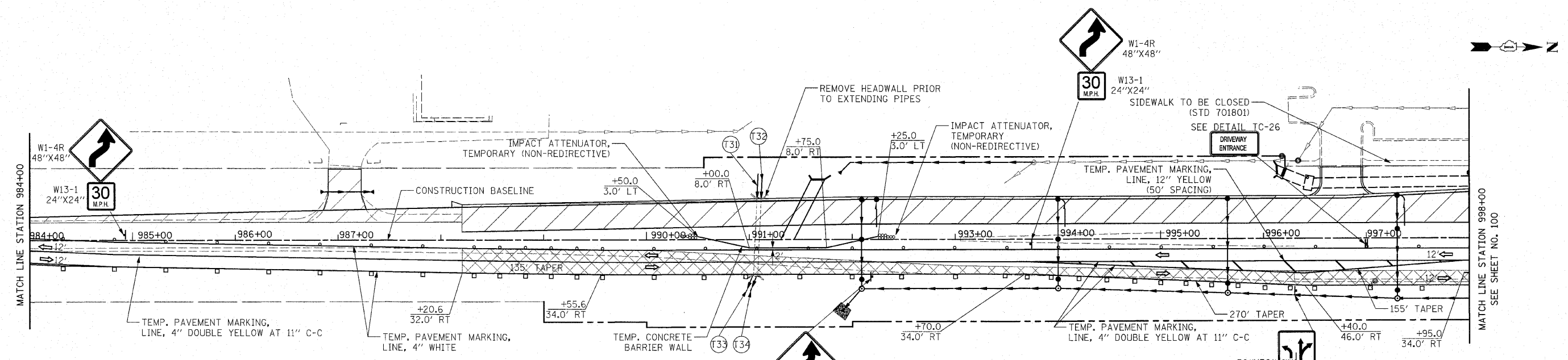

REVISIONS	
NAME	DATE

ILLINOIS DEPARTMENT OF TRANSPORTATION
HARLEM AVENUE
MAINTENANCE OF TRAFFIC
STAGE 1

STA. 976+00 TO STA. 998+00

SCALE IN FEET
0 50

DATE 6/11/2010

DRAWN BY DJK
CHECKED BY JRV