

F.A.P. RTE.	SECTION	COUNTY	TOTAL SHEETS	SHEET NO.
353	(12&13)WRS-4	WILL	608	120
STA. 480+00		TO STA. 510+00		
FED. ROAD DIST. NO. 1 ILLINOIS FED. AID PROJECT				

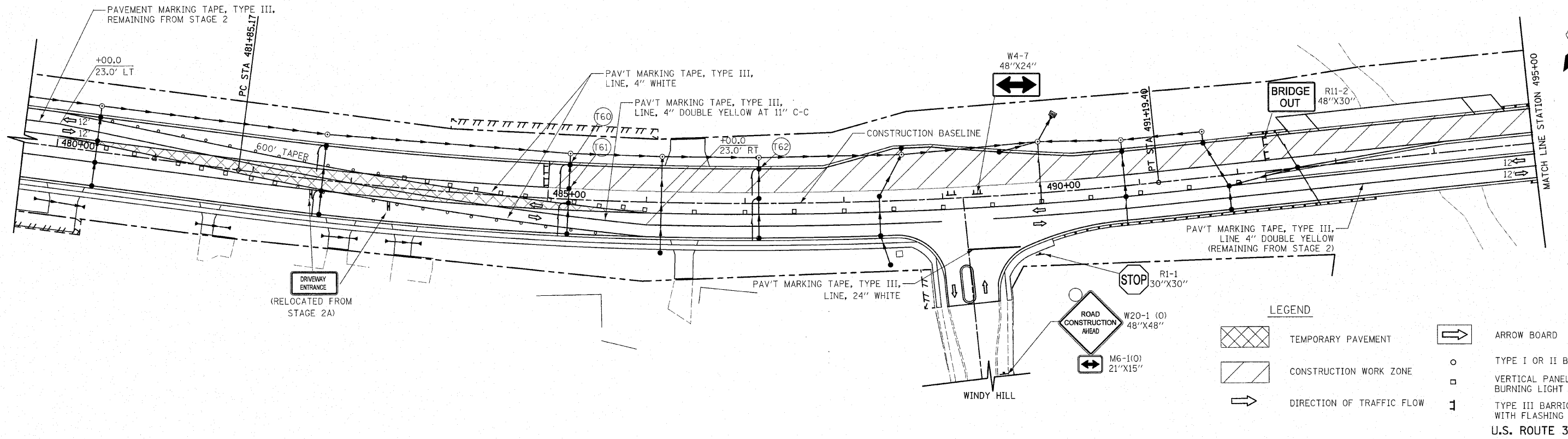

**LEGEND**

	TEMPORARY PAVEMENT		ARROW BOARD
	CONSTRUCTION WORK ZONE		TYPE I OR II BARRICADE
	DIRECTION OF TRAFFIC FLOW		VERTICAL PANEL WITH STEADY BURNING LIGHT
			TYPE III BARRICADE WITH FLASHING LIGHT

U.S. ROUTE 30

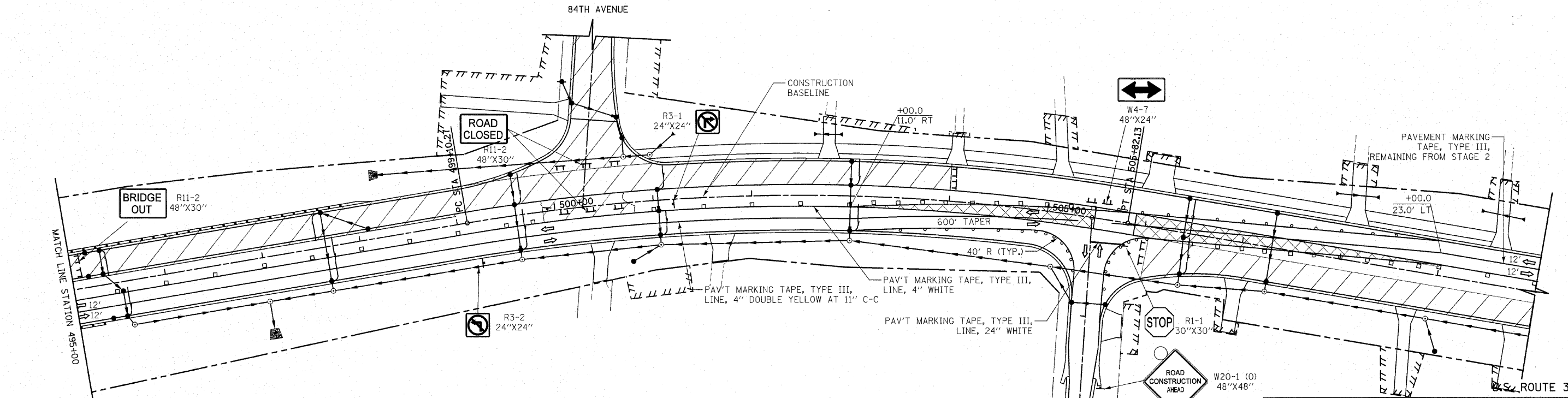

REVISIONS	
NAME	DATE

ILLINOIS DEPARTMENT OF TRANSPORTATION  
U.S. ROUTE 30  
MAINTENANCE OF TRAFFIC  
STAGE 2B

STATION 480+00 TO STATION 510+00

SCALE IN FEET  
0 50 50

DATE 6/11/2010

DRAWN BY DJK  
CHECKED BY JRV