

F.A.P. RTE.	SECTION	COUNTY	TOTAL SHEETS	SHEET NO.
353	(12&13)WRS-4	WILL	608	179
STA. 495+00		TO STA. 510+00		
FED. ROAD DIST. NO. 1 ILLINOIS FED. AID PROJECT				

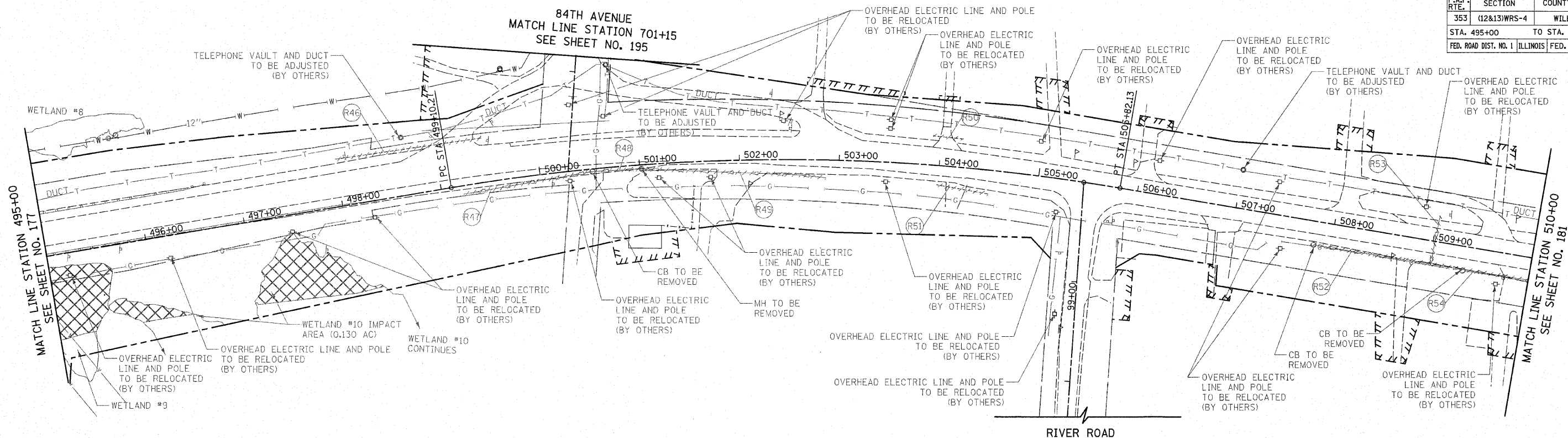

LEGEND



EXISTING U.S. ROUTE 30

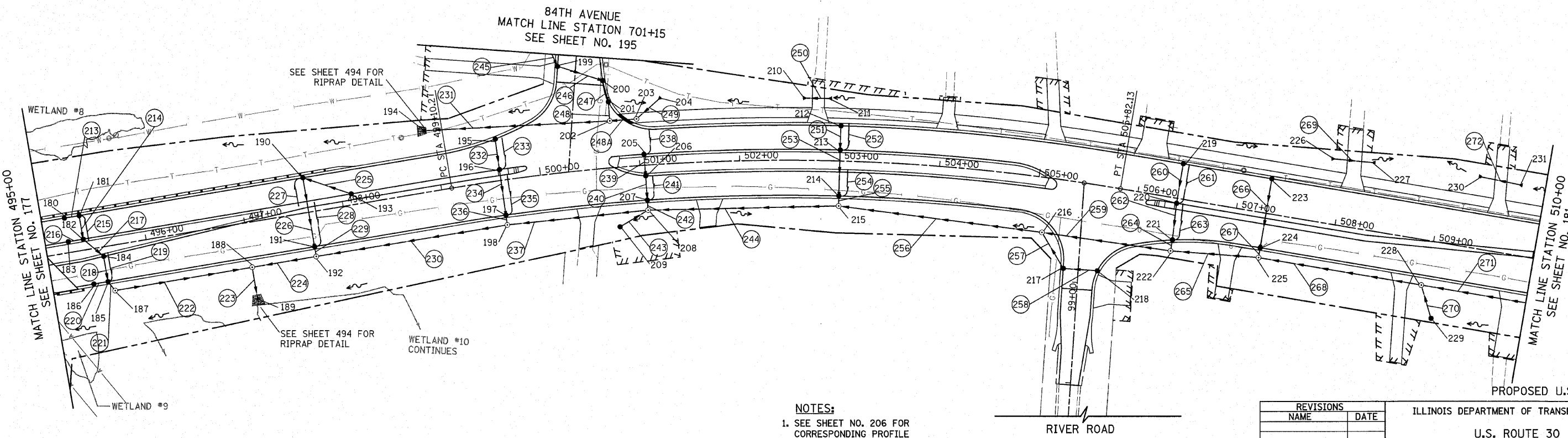

NOTES:
1. SEE SHEET NO. 206 FOR CORRESPONDING PROFILE

REVISIONS	
NAME	DATE

ILLINOIS DEPARTMENT OF TRANSPORTATION

U.S. ROUTE 30
DRAINAGE AND UTILITY PLANS

STATION 495+00 TO STATION 510+00

SCALE IN FEET
50 0 50

DATE 6/11/2010

DRAWN BY DJK
CHECKED BY JRV

PROPOSED U.S. ROUTE 30