

CONTRACT NO. 62478				
F.A.P. RTE.	SECTION	COUNTY	TOTAL SHEETS	SHEET NO.
353	(12&13)WRS-4	WILL	608	300
STA.		TO STA.		
FED. ROAD DIST. NO. 1		ILLINOIS FED. AID PROJECT		

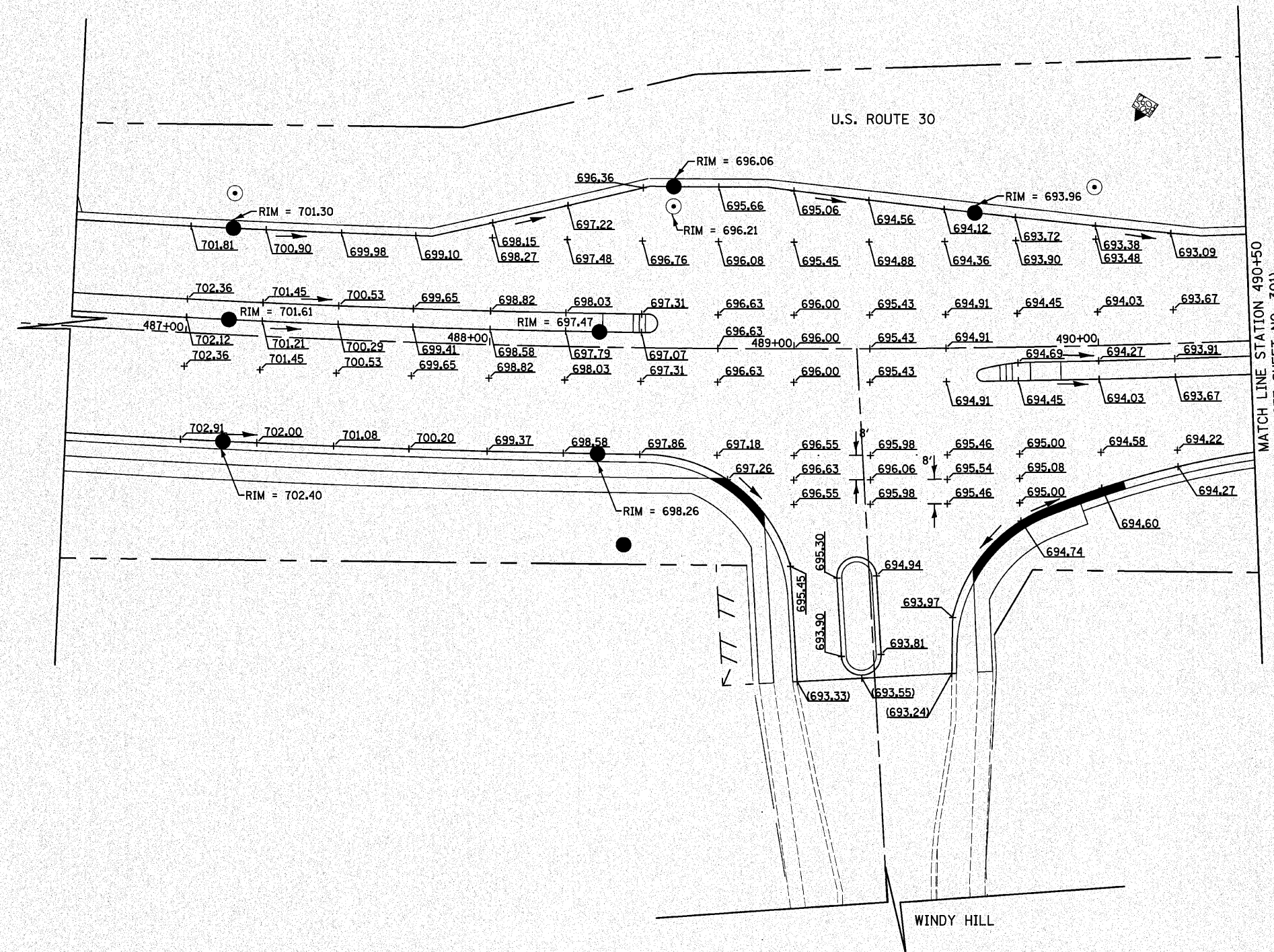

LEGEND
 FLOW DIRECTION

NOTES
 ELEVATIONS ARE GIVEN AT 25' INTERVALS UNLESS OTHERWISE NOTED.

REVISIONS	
NAME	DATE

ILLINOIS DEPARTMENT OF TRANSPORTATION
 U.S. ROUTE 30 / WINDY HILL
 INTERSECTION GRADING PLAN

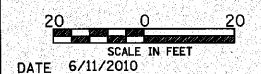

DRAWN BY DJK
 CHECKED BY JRV

DATE 6/11/2010