

F.A.P. SITE	SECTION	COUNTY	TOTAL SHEETS	SHEET NO.
353	(12&13)WRS-4	WILL	608	316
STA. 465+00		TO STA. 495+00		
FED. ROAD DIST. NO. 1		ILLINOIS	FED. AID PROJECT	

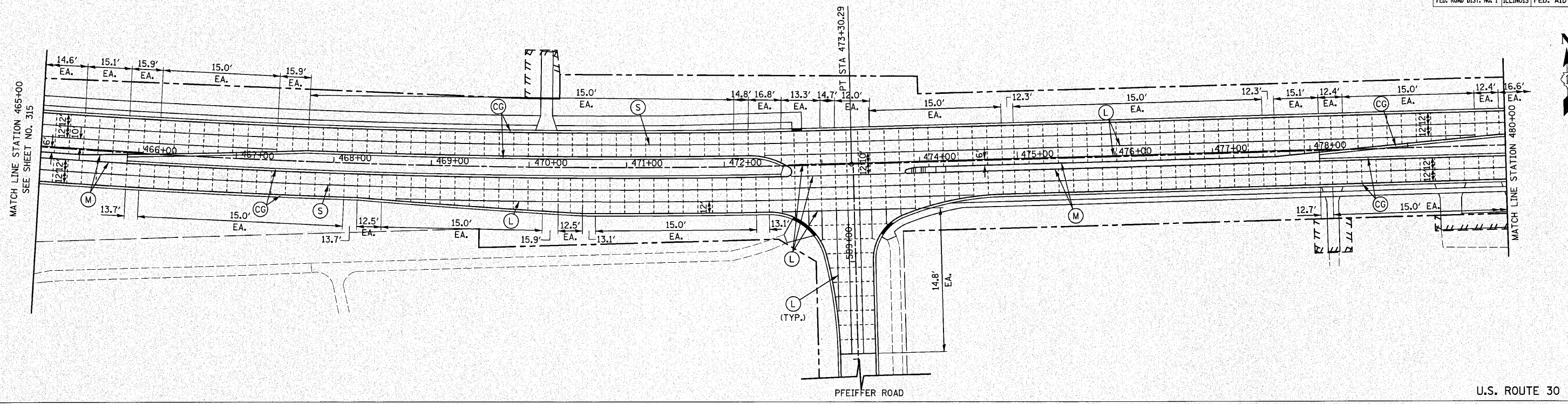

U.S. ROUTE 30

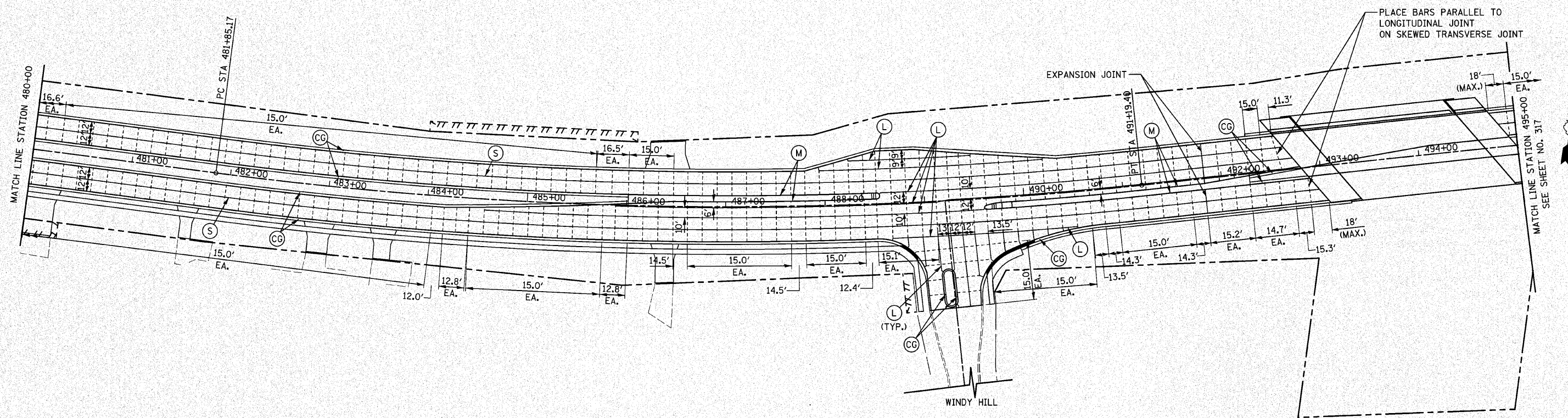

U.S. ROUTE 30

REVISIONS	
NAME	DATE

ILLINOIS DEPARTMENT OF TRANSPORTATION
U.S. ROUTE 30
JOINTING PLAN

STATION 465+00 TO STATION 495+00

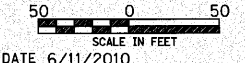

DRAWN BY DJK
CHECKED BY JRV

DATE 6/11/2010