

FINAL SURVEY NOTE BOOK NO. BY DATE

ORIGINAL SURVEY NOTE BOOK NO. BY DATE

PLOT DATE = 8/18/2018  
 FILE NAME = J:\1551\road\sheet518.dwg  
 PLOT SCALE = 1/8"=1'-0"  
 USER NAME = bfg

F.A.P. RTE.	SECTION	COUNTY	TOTAL SHEETS	SHEET NO.
353	(12&13)WRS-4	WILL	608	516
STA. 424+60.00		TO STA. 427+00.00		
FED. ROAD DIST. NO. 1		ILLINOIS FED. AID PROJECT		

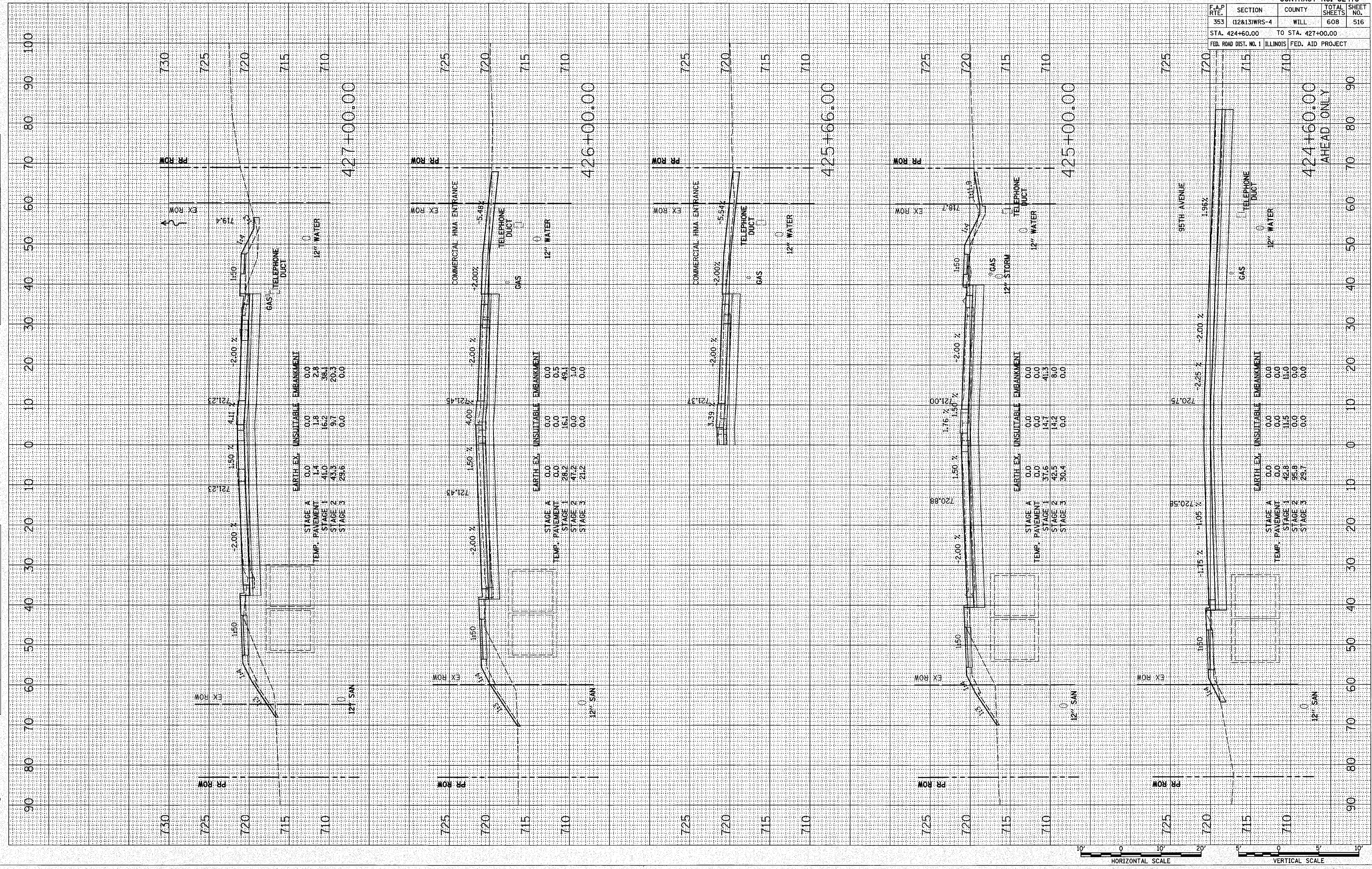

NOTE: THE DEPTHS OF THE EXISTING GAS, TELEPHONE DUCT, CABLE TV, AND WATER MAIN HAVE BEEN ASSUMED. ELEVATIONS NOTED AS XXX.X(Y) ARE FOR TEMPORARY DITCH GRADES DURING CONSTRUCTION.

U.S. ROUTE 30