

CONSULTANT SERVICES SECTION DISTRICT ONE - DESIGN / RAJENDRA SHAH (347) 705-4555

FOR INDEX OF SHEETS. SEE SHEET NO. 2

PROJECT IS LOCATED IN
NEW LENOX TOWNSHIP
VILLAGE OF NEW LENOX
& FRANKFORT TOWNSHIP
VILLAGE OF MOKENA
VILLAGE OF FRANKFORT

DESIGN DESIGNATION

2,340 (20) OTHER PRINCIPAL ARTERIAL 4.27 (PCC-30)

	ADT (1998)	DESIGN SPEED	POSTED SPEED
WILLIAMS TO GARFIELD	16,000	50	40
GARFIELD TO WOLF	16,000	50	50
WOLF TO HACKBERRY	16,000	50	45
HACKBERRY TO U.S. 45	16,000	50	40
MARLEY ROAD	2,500	30	30
SCHOOLHOUSE ROAD (S LEG)	7,700	35	35
SCHOOLHOUSE ROAD (N LEG)	6,600	45	45
WOLF ROAD (S LEG)	6,500	45	45
WOLF ROAD (N LEG)	10,500	45	45
ELSNER ROAD	3,800	25	25
LOCUST STREET (S LEG)	1,100	25	25
LOCUST STREET (N LEG)	3,100	20	20

PROPOSED IMPROVEMENT

RECONSTRUCTION OF U.S. ROUTE 30 (LINCOLN HIGHWAY) FROM WILLIAMS STREET TO U.S. ROUTE 45 INCLUDING EIGHT NOISE RETAINING WALLS, NINE BOX CULVERTS, DRAINAGE IMPROVEMENTS, TRAFFIC SIGNALS AND OTHER RELATED IMPROVEMENTS

DESCRIPTION OF PROJECT

NOISE WALL 'A' STA. 201+45 TO STA. 212+15 RT.
 NOISE WALL 'B' STA. 241+18 TO STA. 250+69 RT.
 NOISE WALL 'C' STA. 273+75 TO STA. 286+10 LT.
 NOISE WALL 'D' STA. 309+89 TO STA. 316+17 LT.
 NOISE WALL 'E' STA. 324+48 TO STA. 328+70 RT.
 NOISE WALL 'F' STA. 364+83 TO STA. 371+55 LT.
 NOISE WALL 'G' STA. 372+65 TO STA. 389+70 LT.
 NOISE WALL 'H' STA. 391+33 TO STA. 397+58 LT.

BOX CULVERT 'B' STA. 158+00.00 SN 099-C011
 BOX CULVERT 'C' STA. 170+61.70 SN 099-C012
 BOX CULVERT 'D' STA. 256+75.00 SN 099-C014
 BOX CULVERT 'E' STA. 271+00.00 SN 099-C015
 BOX CULVERT 'G' STA. 341+10.00 SN 099-0106
 BOX CULVERT 'H' STA. 401+73.90 SN 099-C018
 BOX CULVERT 'J' STA. 182+31.00 SN 099-C013
 BOX CULVERT 'K' STA. 381+20.00 SN 099-C016
 BOX CULVERT 'L' STA. 387+35.00 SN 099-C017.

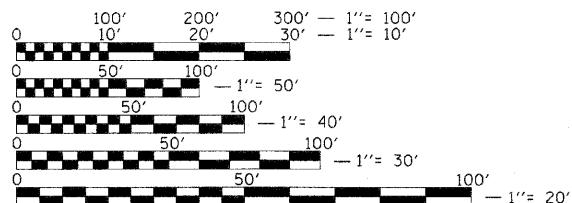

FULL SIZE PLANS HAVE BEEN PREPARED USING STANDARD ENGINEERING SCALES, REDUCED SIZED PLANS WILL NOT CONFORM TO STANDARD SCALES, IN MAKING MEASUREMENTS ON REDUCED PLANS, THE ABOVE SCALES MAY BE USED.

J.U.L.I.E.
JOINT UTILITY LOCATION INFORMATION FOR EXCAVATION
1-800-892-0123 OR 811

CONTRACT NO. 62479

COUNTY: WILL SECTION: (12 & 13) WRS-3 F.A.P. ROUTE: 353

STATE OF ILLINOIS
 DEPARTMENT OF TRANSPORTATION
 DIVISION OF HIGHWAYS
**PLANS FOR PROPOSED
 HIGHWAYS**

F.A.P. 353 (U.S. ROUTE 30)
 SECTION: (12 & 13) WRS-3
 WILLIAMS STREET TO U.S. ROUTE 45
 ROADWAY RECONSTRUCTION & TRAFFIC
 SIGNAL MODERNIZATION AND INSTALLATION
 PROJECT: ACNHF-0353(020)
 WILL COUNTY
 C-91-219-02

THIS CONTRACT REQUIRES COMPLIANCE
 WITH THE FOLLOWING PERMITS:
 1. 404 PERMIT
 2. NPDES PERMIT

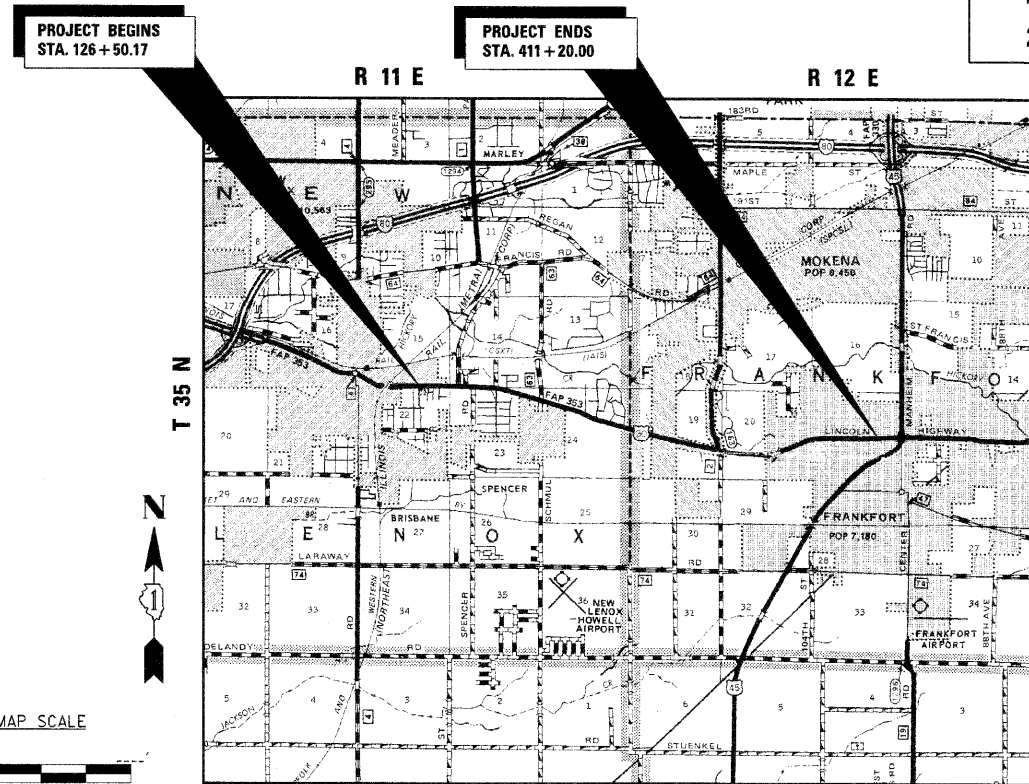

NEW LENOX TWP. FRANKFORT TWP.
 GROSS LENGTH PROJECT = 28,470 FEET = 5.39 MILES
 NET LENGTH PROJECT = 28,463 FEET = 5.39 MILES

FAP RTE	SECTION	COUNTY	TOTAL SHEETS	SHEET NO.
353	(12&13)WRS-3	WILL	1236	1

D-91-219-02

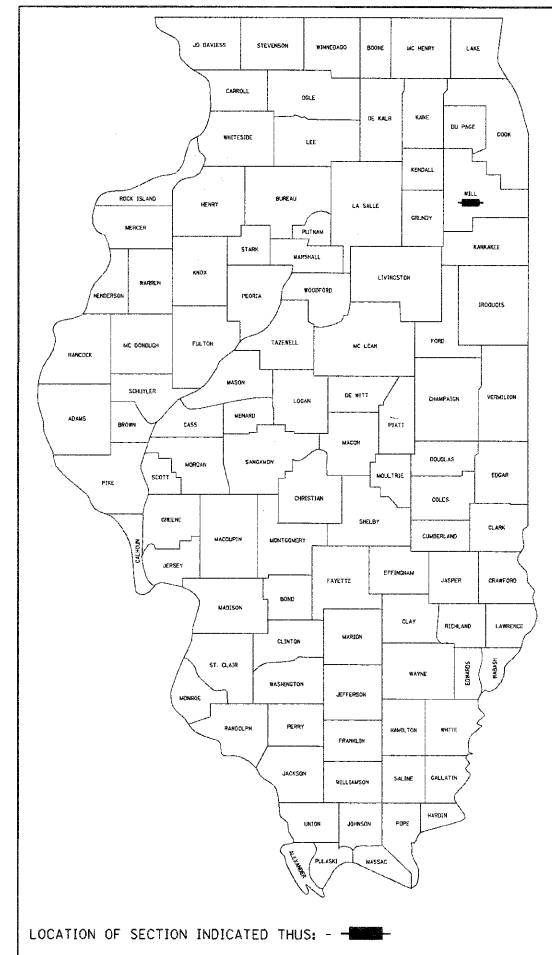

ROADWAY & STRUCTURES DESIGNED BY

DLZ 85 W. ALGONQUIN, SUITE 220
 ARLINGTON HEIGHTS, IL 60005
 (847) 640-0840

Gregory R. Drummond
 REGISTERED PROFESSIONAL ENGINEER
 11-30-11 EXPIRES

Wayne A. Triley
 REGISTERED STRUCTURAL ENGINEER
 11-30-10 EXPIRES

STATE OF ILLINOIS
 DEPARTMENT OF TRANSPORTATION
 DIVISION OF HIGHWAYS

SUBMITTED June 9, 2010
 Diane M. O'Keefe
 DEPUTY DIRECTOR OF HIGHWAYS, REGION ENGINEER

December 10, 2010
 Scott E. Stitt, P.E.
 ENGINEER OF DESIGN AND ENVIRONMENT

December 10, 2010
 Christine M. Reedler
 DIRECTOR OF HIGHWAYS, CHIEF ENGINEER

PRINTED BY AUTHORITY OF THE STATE OF ILLINOIS