

F.A.P. RTE.	SECTION	COUNTY	TOTAL SHEETS	SHEET NO.
353	(12&13)WRS-3	WILL	1235	127
STA. 346+00		TO STA. 374+00		
FED. ROAD DIST. NO.	ILLINOIS	FED. AID PROJECT		

CONTRACT NO. 62479

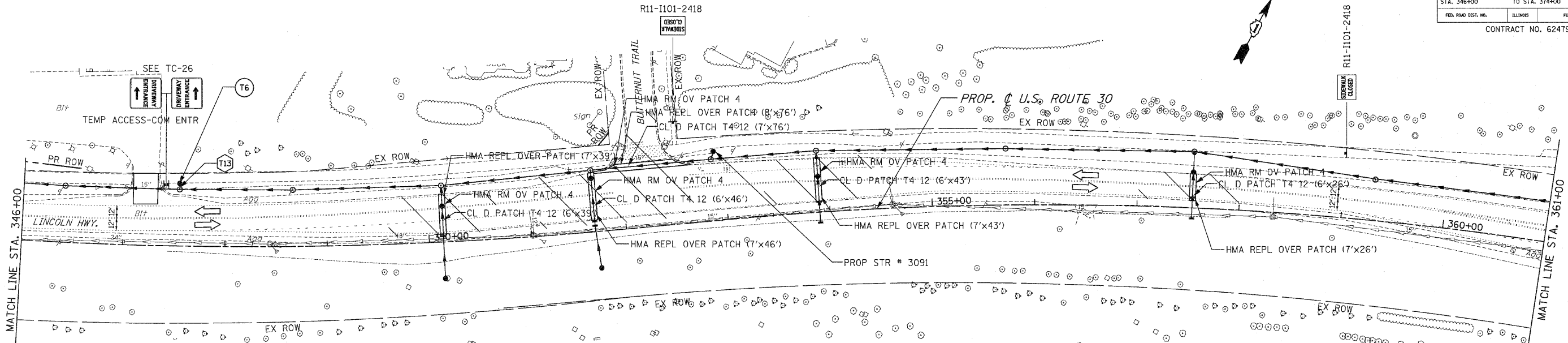

STRUCTURE	STATION	OFFSET	TYPE	FRAME	RIM ELEVATION	INVERT ELEVATION			
						NORTH	EAST	SOUTH	WEST
T6	347+55.0	61.0'	LT CB C	8	725.2			721.45	
STR #3091	352+92	67.0'	LT CB C	8	732.30**			727.30	

PIPE NO.	LENGTH	DIAMETER	TYPE	SLOPE (FT/FT)	INVERT		TRENCH BACKFILL
					U.S.	D.S.	
T13	6	24	1	.005	721.32	721.29	0

\*\* RIM TO BE ADJUSTED IN STAGE 2 - SEE DRAINAGE & UTILITY DRAWINGS

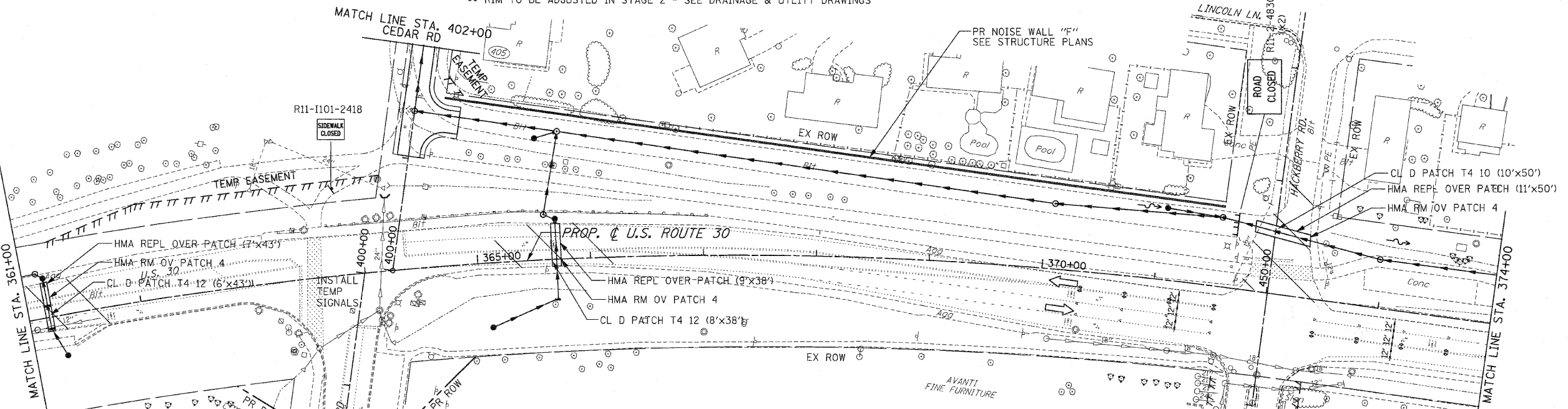

**PAVEMENT MARKING KEY**

1	4" SOLID - WHITE
2	12" SOLID - YELLOW
3	4" SOLID - YELLOW @ 11" c-c
4	24" STOP BAR - WHITE
5	12" SOLID - WHITE
6	6" SOLID - WHITE
7	6"-6'/2" DASH-WHITE
8	4" SOLID - YELLOW
9	4" 30'/10' DASH WHITE

**LEGEND**

- ➔ ARROW BOARD
- ▨ TEMPORARY PAVEMENT
- ▨ TEMPORARY PAVEMENT
- ▨ CONSTRUCTED IN EARLIER STAGE
- ▨ CONSTRUCTION ZONE
- ⊥ TYPE III BARRICADE WITH FLASHING LIGHTS
- ⊥ TYPE II BARRICADE
- ⊥ DRUM OR VERTICAL BARRICADE
- ➔ DIRECTION INDICATOR BARRICADE WITH STEADY BURN MONODIRECTIONAL LIGHT
- ⊥ FLASHING LIGHT
- ⊗ TEMPORARY STRUCTURE NUMBER
- ⊗ TEMPORARY PIPE NUMBER
- ⊗ TEMPORARY STRUCTURE NUMBER
- ⊗ TEMPORARY PIPE NUMBER

**REVISIONS**

NO.	NAME	DATE

ILLINOIS DEPARTMENT OF TRANSPORTATION  
**MAINTENANCE OF TRAFFIC**  
 PRE-STAGE 1  
 U.S. RTE. 30 (LINCOLN HIGHWAY)  
 STA. 346+00 TO STA. 374+00  
 SCALE : 1" = 50'  
 DATE : / /  
 DRAWN BY : BAE  
 CHECKED BY : GB