

F.A.P. RTE.	SECTION	COUNTY	TOTAL SHEETS	SHEET NO
353	(12&13)WRS-3	WILL	1235	150
STA. 118+00		TO STA. 146+00		
FED. ROAD DIST. NO.	ILLINOIS	FED. AID PROJECT		

CONTRACT NO. 62479

PRE-STAGE 2 GENERAL NOTES

PRE-STAGE 2 CONSTRUCTION

CONSTRUCT PART OF THE PROPOSED STRUCTURS (SEE STRUCTURE PLANS):

- CULVERT "B"
- CULVERT "J"
- CULVERT "K"

CONSTRUCT TEMPORARY PAVEMENT AT THE FOLLOWING LOCATIONS:

- WEST OF WEST HIGH SCHOOL ENTRANCE TO EAST OF WEST HIGH SCHOOL ENTRANCE
- WEST OF FORREST PRESERVE RD TO FORREST PRESERVE RD
- WASHINGTON PARKWAY TO EAST OF WASHINGTON PARKWAY

CONSTRUCT THE REMAINING PORTIONS OF THE FOLLOWING INTERSECTIONS:

- SPENCER RD
- WASHINGTON PARKWAY

PRE-STAGE 2 TRAFFIC

EB US RTE 30

SHIFT TRAFFIC TO WB PASSING LANE/TURN LANE/TEMP. PAVEMENT CONSTRUCTED IN EARLIER STAGE FROM WILLIAMS ST TO COMMERCIAL ENTRANCE AT STA 297+00.

FROM COMMERCIAL ENTRANCE AT STA 297+00 SHIFT TRAFFIC TO EXISTING EB PASSING LANE AT WOLF RD. TRAFFIC REMAINS THE SAME AS PREVIOUS STAGE FROM WOLF RD. TO ELSNER RD.

FROM ELSNER RD. TO LOCUST ST. TRAFFIC TO FOLLOW WB LANES, ONE LANE TO THE RIGHT OF WB PASSING LANE ON TURN LANE/TEMP. PAVEMENT CONSTRUCTED IN EARLIER STAGE.

FROM LOCUST TRAFFIC SHALL BE SHIFTED TO WB PASSING LANE CONSTRUCTED IN EARLIER STAGE UNTIL EAST OF COMMERCIAL ENTRANCE LOCATED AT STA 408+00.

FROM EAST OF CE AT STA 408+00 SHIFT TRAFFIC TO EXISTING EB PASSING LANE, OPENING ALL EB LANES PRIOR TO US RTE 45.

WB US RTE 30

FROM US RTE 45 MAINTAIN TRAFFIC IN WB DRIVING LANE/TEMPORARY PAVEMENT CONSTRUCTED IN EARLIER STAGE TO WEST OF ELSNER RD.

FROM ELSNER RD. TO WOLF RD. TRAFFIC SHALL REMAIN AS IN PREVIOUS STAGE.

FROM WOLF RD. TO WILLIAMS ST. MAINTAIN TRAFFIC IN EXISTING WB DRIVING LANE AND WB DRIVING LANE/TEMPORARY PAVEMENT CONSTRUCTED IN EARLIER STAGE.

LEFT TURN LANES SHALL BE PROVIDED AT THE FOLLOWING LOCATIONS:

- MARLEY RD.
- SCHOOLHOUSE RD.
- VANCINA LN.
- GARFIELD AVE.
- WEST CIRCLE DR.
- ARROWHEAD
- FORREST PRESERVE RD. (STA 258+50)
- TALL GRASS RD.
- CE @ STA 297+00
- ELSNER RD.
- HACKBERRY RD.
- LOCUST ST.

EXISTING LEFT TURN LANES SHALL REMAIN OPEN AT THE FOLLOWING LOCATIONS:

- WOLF RD.
- CE AT STA 318+50
- 108TH AVE
- US RTE 45

THE FOLLOWING SIDESTREETS SHALL BE DETOURED DURING THIS STAGE:

- SPENCER RD
- WASHINGTON PKWY.

ALL OTHER SIDESTREETS SHALL REMAIN OPEN.

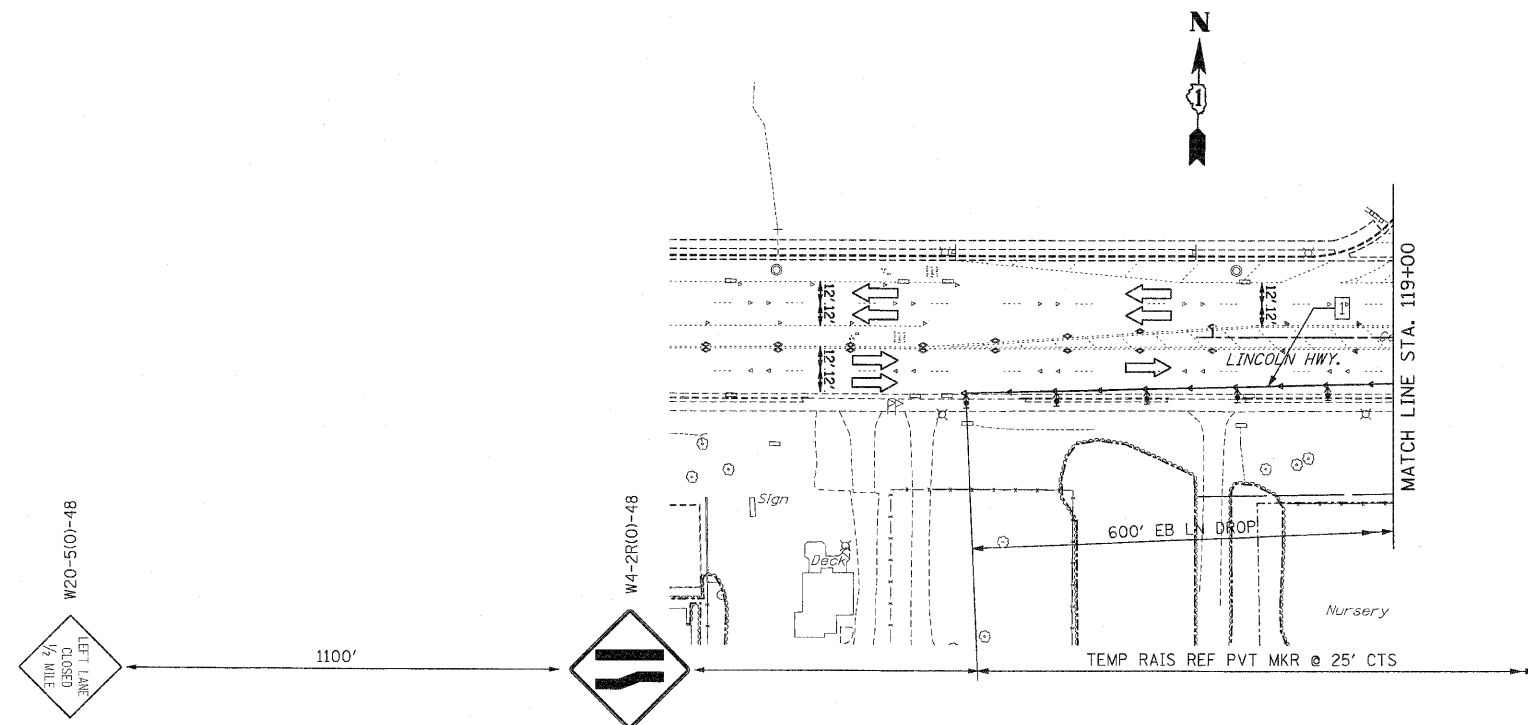

PAVEMENT MARKING KEY

- | | |
|---|-----------------------------|
| 1 | 4" SOLID - WHITE |
| 2 | 12" SOLID - YELLOW |
| 3 | 4" SOLID - YELLOW @ 11" c-c |
| 4 | 24" STOP BAR - WHITE |
| 5 | 12" SOLID - WHITE |
| 6 | 6" SOLID - WHITE |
| 7 | 6"-6'/2' DASH-WHITE |
| 8 | 4" SOLID - YELLOW |
| 9 | 4" 30'/10' DASH WHITE |

LEGEND

- ➔ ARROW BOARD
- ▨ TEMPORARY PAVEMENT
- ▨ TEMPORARY PAVEMENT CONSTRUCTED IN EARLIER STAGE
- ▨ CONSTRUCTION ZONE
- ⊥ TYPE III BARRICADE WITH FLASHING LIGHTS
- ⊥ TYPE II BARRICADE
- ⊥ DRUM OR VERTICAL BARRICADE
- ➔ DIRECTION INDICATOR BARRICADE WITH STEADY BURN MONODIRECTIONAL LIGHT
- ⊗^{FL} FLASHING LIGHT

REVISIONS	
NAME	DATE

ILLINOIS DEPARTMENT OF TRANSPORTATION
MAINTENANCE OF TRAFFIC
PRE-STAGE 2
U.S. RTE. 30 (LINCOLN HIGHWAY)
GENERAL NOTES
 SCALE : 1" = 50'
 DATE : / /
 DRAWN BY : BAE
 CHECKED BY : GB