

F.A.P. RTE.	SECTION	COUNTY	TOTAL SHEETS	SHEET NO.
353	(12&13)WRS-3	WILL	1235	172
STA. 374+00		TO STA. 404+00		
FED. ROAD DIST. NO.	ILLINOIS	FED. AID PROJECT		
CONTRACT NO. 62479				

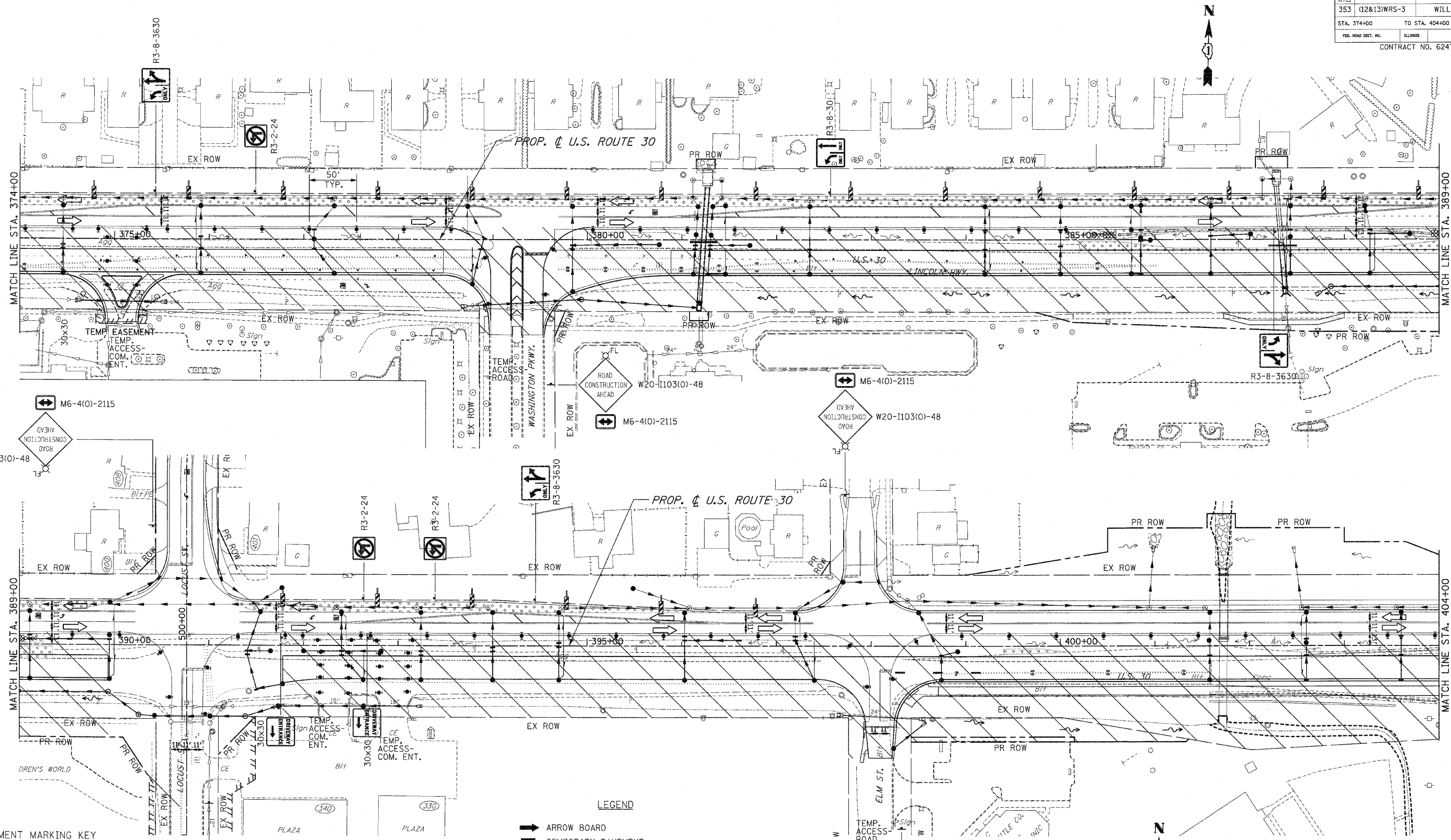

PAVEMENT MARKING KEY

- 1 4" SOLID - WHITE
- 2 12" SOLID - YELLOW
- 3 4" SOLID - YELLOW @ 11" c-c
- 4 24" STOP BAR - WHITE
- 5 12" SOLID - WHITE
- 6 6" SOLID - WHITE
- 7 6"-6'/2' DASH-WHITE
- 8 4" SOLID - YELLOW
- 9 4" 30'/10' DASH WHITE

LEGEND

- ➔ ARROW BOARD
- TEMPORARY PAVEMENT
- ▨ TEMPORARY PAVEMENT CONSTRUCTED IN EARLIER STAGE
- ▩ INCIDENTAL BITUMINOUS PAVEMENT
- ▧ CONSTRUCTION ZONE
- ⊥ TYPE III BARRICADE WITH FLASHING LIGHTS
- ⊥ TYPE II BARRICADE, [50' c-c STRAIGHTS
25' c-c TAPERS
10' c-c RADII]
- ⊥ DRUM OR VERTICAL BARRICADE
- ⊥ STEADY BURN MONODIRECTIONAL LIGHT
- TEMPORARY CONCRETE BARRIER WALL

REVISIONS	
NAME	DATE

ILLINOIS DEPARTMENT OF TRANSPORTATION
MAINTENANCE OF TRAFFIC
 STAGE 2
 U.S. RTE. 30 (LINCOLN HIGHWAY)
 STA. 374+00 TO STA. 404+00
 SCALE : 1" = 50'
 DATE : / / DRAWN BY : BAE
 CHECKED BY : GB