

F.A.P. RTE.	SECTION	COUNTY	TOTAL SHEETS	SHEET NO.
353	(12&13)WRS-3	WILL	1235	179
STA. 161+00		TO STA. 174+00		
FED. ROAD DIST. NO.	ILLINOIS	FED. AID PROJECT		
CONTRACT NO. 62479				

STAGE 3 CONSTRUCTION

1. CONSTRUCT US RTE 30 MEDIANS FROM LINCOLNWAY DR. TO WOLF RD.
2. CONSTRUCT WB US RTE 30 DRIVING AND PASSING LANES FROM EAST OF WOLF RD. TO WEST OF HACKBERRY RD.
3. CONSTRUCT CURB AND GUTTER, DRIVEWAYS, SIDEWALK AND BIKE PATH ALONG WB US RTE 30 FROM EAST OF WOLF RD. TO WEST OF HACKBERRY RD.
4. CONSTRUCT CURB & GUTTER, BIKE PATH, NOISE WALL 'G' AND WALL 'H' ALONG WB US 30 FROM EAST OF HACKBERRY RD. TO WEST OF ELM ST.
5. CONSTRUCT HALF OF CULVERT "G" (SEE STRUCTURE PLANS).
6. CONSTRUCT WB US RTE 30 LEFT TURN LANE STORAGE AND TAPER @ THE FOLLOWING INTERSECTIONS:
 - SETTLERS POND DR.
 - 108TH AVE.
7. CONSTRUCT STORM SEWER LATERALS FOR WB US RTE 30 FROM EAST OF WOLF RD. TO WEST OF HACKBERRY RD. TO WEST OF ELM ST.
8. CONSTRUCT FINAL PAVEMENT MARKINGS ON THE FOLLOWING SIDE STREETS:
 - SETTLERS POND DR.
 - BUTTERNUT TRAIL
 - ELSNER RD
 - LOCUST ST.

STAGE 3 TRAFFIC

- EB US RTE 30**
- ALL LANES FROM WILLIAM ST TO ANDERSON RD SHALL BE OPEN.
 - CLOSE PASSING LANE, KEEPING DRIVING LANE OPEN FROM WILLIAMS ST TO WEST OF WOLF.
 - KEEP ONLY DRIVING LANE FROM EAST OF WOLF TO WEST OF US RTE 45.
 - ALL LANES FROM WEST OF US RTE 45 TO EAST OF US RTE 45 SHALL BE OPEN.
 - LEFT TURN LANES SHALL BE PROVIDED FOR THE FOLLOWING LOCATIONS:
 - 1 - WEST HIGH SCHOOL ENTRANCE (STA 185+00)
 - 2 - SCHOOLHOUSE RD
 - 3 - VANCINA/RETAIL DR. (STA 219+00)
 - 4 - WEST CIRCLE DR.
 - 5 - ARROWHEAD RD.
 - 6 - EAST CIRCLE DR.
 - 7 - FOREST PRESERVE DR. (STA 258+25)
 - 8 - TALL GRASS RD.
 - 9 - RIDGEMORE RD.
 - 10 - FRANKFORD TOWNSHIP CENTER (STA 318+75)
 - 11 - HACKBERRY RD.
 - 12 - LOCUST ST
 - 13 - ELM ST.
 - EXISTING LEFT TURN LANES SHALL REMAIN OPEN AT THE FOLLOWING LOCATIONS:
 - 1 - WOLF RD
 - 2 - US RTE 45
 - EXISTING RIGHT TURN LANE SHALL REMAIN OPEN AT THE FOLLOWING LOCATIONS:
 - 1 - WOLF RD.
 - 2 - RETAIL DR.
 - 3 - CE @ STA 226+75

- WB US RTE 30**
- ALL LANES FROM WILLIAM ST TO ANDERSON RD SHALL BE OPEN.
 - DRIVING AND PASSING LANES FROM ANDERSON RD TO LINCOLNWAY DR. SHALL BE OPEN. THE MEDIAN SHALL BE CLOSED.
 - CLOSE PASSING LANE, KEEPING DRIVING LANE OPEN FROM LINCOLNWAY DR. TO EAST OF WOLF RD.
 - TRANSITION EB LANES CONSTRUCTED IN EARLIER STAGE TO WB DRIVING LANE FROM EAST OF WOLF RD TO WEST OF RTE 45.
 - LEFT TURN LANES SHALL BE PROVIDED FOR THE FOLLOWING LOCATIONS:
 - 1 - CE @ STA 185+50
 - 2 - SCHOOLHOUSE RD.
 - 3 - RETAIL DR. (STA 219+50)
 - 4 - JOLIET HWY
 - 5 - BLUESTONE BAY DR.
 - 6 - PRESTANCIA DR.
 - 7 - OWENS RD.
 - 8 - CE @ STA 297+00
 - 9 - CE @ STA 318+75
 - 10 - 108TH AVE
 - 11 - ELSNER RD.
 - 12 - HACKBERRY RD.
 - 13 - WASHINGTON PKWY
 - 14 - LOCUST ST.
 - 15 - ELM ST.
 - 16 - CE @ STA 408+00

- EXISTING RIGHT TURN LANES SHALL REMAIN OPEN AT THE FOLLOWING LOCATIONS:
 - 1 - WOLF RD.
- EXISTING LEFT TURN LANES SHALL REMAIN OPEN AT THE FOLLOWING LOCATIONS:
 - 1 - WOLF RD.
 - 2 - US RTE 45
- MAINTAIN EXISTING LANES ON ALL SIDEROADS.

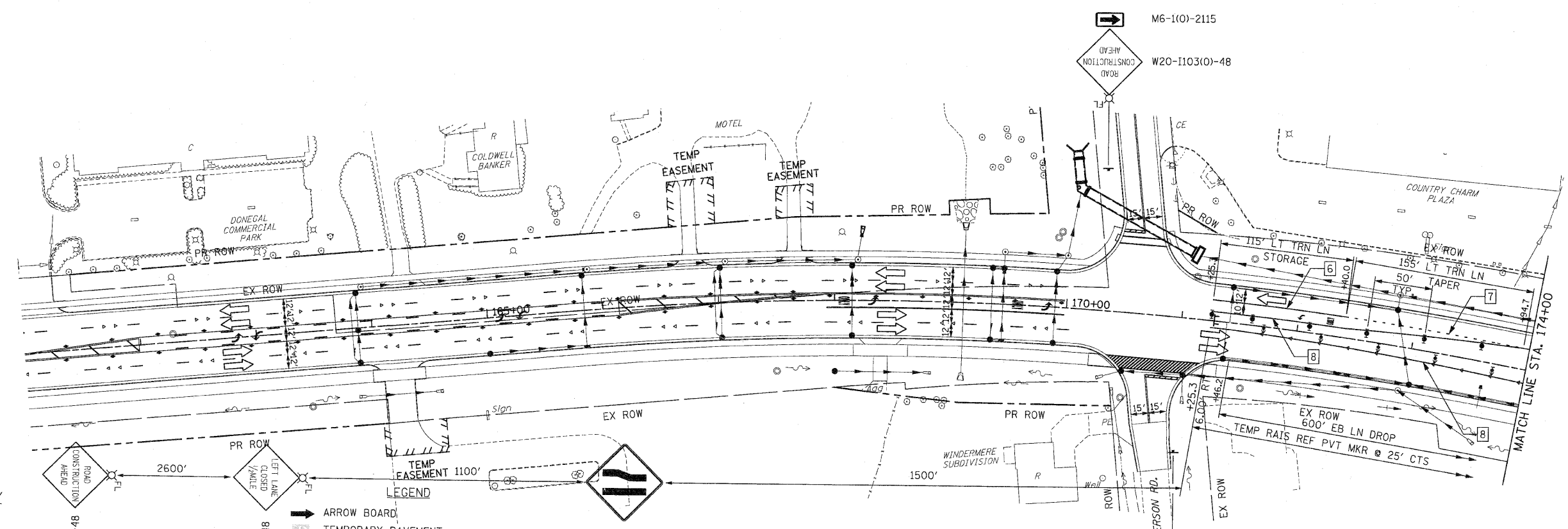

PAVEMENT MARKING KEY

- 1 4" SOLID - WHITE
- 2 12" SOLID - YELLOW
- 3 4" SOLID - YELLOW @ 11" C-C
- 4 24" STOP BAR - WHITE
- 5 12" SOLID - WHITE
- 6 6" SOLID - WHITE
- 7 6"-6 1/2" DASH-WHITE
- 8 4" SOLID - YELLOW
- 9 4" 30'/10" DASH WHITE

LEGEND

- ARROW BOARD
- TEMPORARY PAVEMENT
- CONSTRUCTED IN EARLIER STAGE
- CONSTRUCTION ZONE
- TYPE III BARRICADE WITH FLASHING LIGHTS
- TYPE II BARRICADE
- DRUM OR VERTICAL BARRICADE
- DIRECTION INDICATOR BARRICADE WITH STEADY BURN MONODIRECTIONAL LIGHT
- FLASHING LIGHT

REVISIONS	
NAME	DATE

ILLINOIS DEPARTMENT OF TRANSPORTATION
MAINTENANCE OF TRAFFIC
 STAGE 3
 U.S. RTE. 30 (LINCOLN HIGHWAY)
 STA. 161+00 TO STA. 174+00
 SCALE : 1" = 50'
 DATE : / /
 DRAWN BY : BAE
 CHECKED BY : GB