

F.A.P. RTE.	SECTION	COUNTY	TOTAL SHEETS	SHEET NO
353	(12&13)WRS-3	WILL	1235	181
STA. 202+00		TO STA. 230+00		
FED. ROAD DIST. NO.	SLIDESH	FED. AID PROJECT		
CONTRACT NO. 62479				

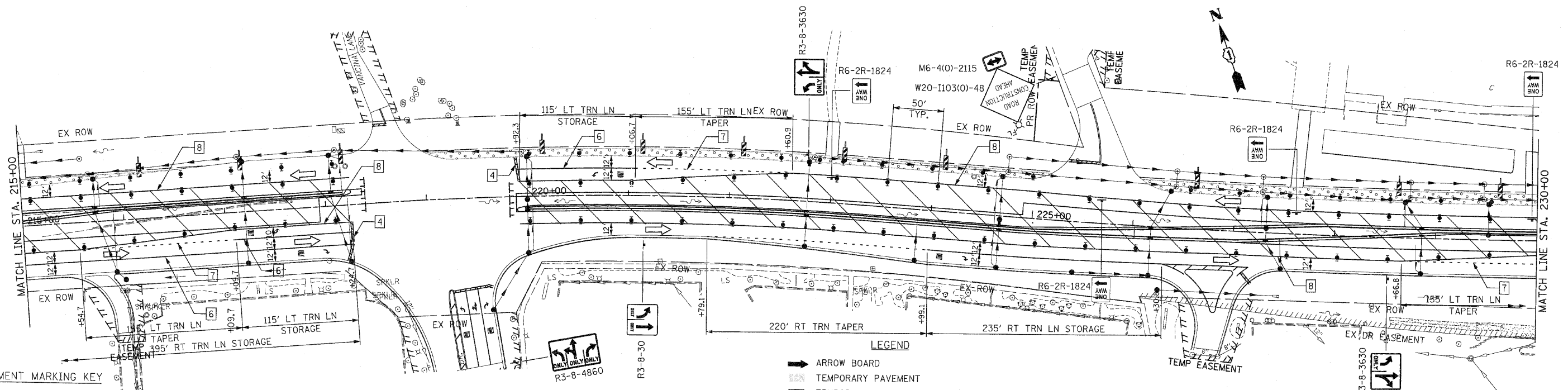
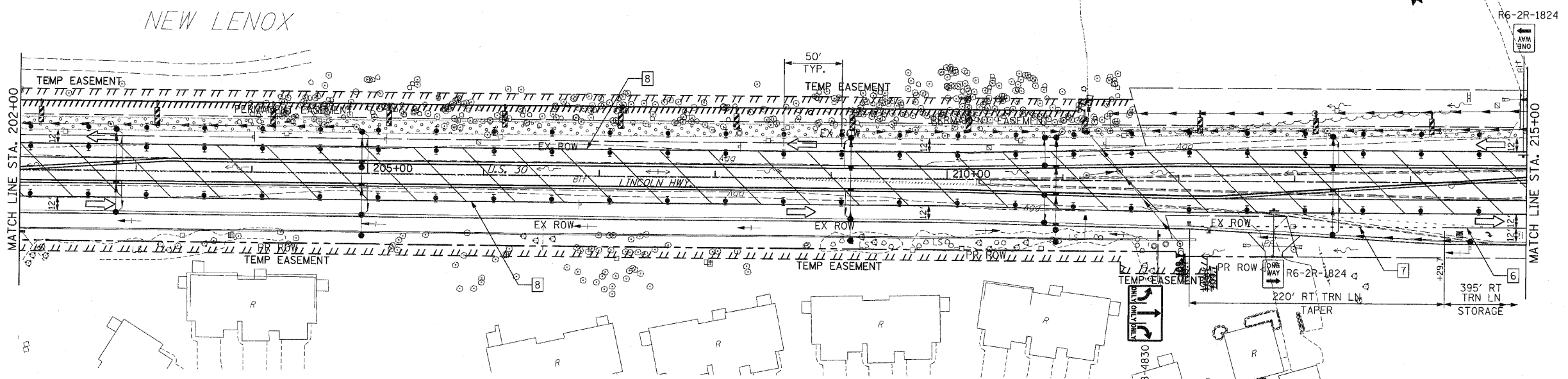

**PAVEMENT MARKING KEY**

1	4" SOLID - WHITE
2	12" SOLID - YELLOW
3	4" SOLID - YELLOW @ 11" C-C
4	24" STOP BAR - WHITE
5	12" SOLID - WHITE
6	6" SOLID - WHITE
7	6"-6 1/2' DASH-WHITE
8	4" SOLID - YELLOW
9	4" 30'/10' DASH WHITE

**LEGEND**

→	ARROW BOARD
▨	TEMPORARY PAVEMENT
▩	TEMPORARY PAVEMENT CONSTRUCTED IN EARLIER STAGE
▧	CONSTRUCTION ZONE
⊥	TYPE III BARRICADE WITH FLASHING LIGHTS
⊥	TYPE II BARRICADE
⊥	DRUM OR VERTICAL BARRICADE
→	DIRECTION INDICATOR BARRICADE WITH STEADY BURN MONODIRECTIONAL LIGHT
⊥	FLASHING LIGHT

REVISIONS	
NAME	DATE

ILLINOIS DEPARTMENT OF TRANSPORTATION  
**MAINTENANCE OF TRAFFIC**  
 STAGE 3  
 U.S. RTE. 30 (LINCOLN HIGHWAY)  
 STA. 202+00 TO STA. 230+00  
 SCALE: 1" = 50'  
 DATE: / /  
 DRAWN BY: BAE  
 CHECKED BY: GB