

F.A.P. RTE.	SECTION	COUNTY	TOTAL SHEETS	SHEET NO.
353	(12&13)WRS-3	WILL.	1235	189
STA. 118+00		TO STA. 146+00		
FED. ROAD DIST. NO.	ILLINOIS	FED. AID PROJECT		
CONTRACT NO. 62479				

STAGE 4 CONSTRUCTION

1. CONSTRUCT US RTE 30 MEDIANS FROM WOLF RD TO LOCUST ST.
2. CONSTRUCT FINAL LIFT OF FULL DEPTH PAVEMENT FROM WOLF RD TO LOCUST ST.
3. CONSTRUCT FINAL PAVEMENT MARKINGS ON US ROUTE 30 EAST BOUND FROM OWENS RD TO LOCUST ST, WEST BOUND FROM WOLF RD TO CE @ STA 408+00
4. CONSTRUCT LANDSCAPING IN MEDIANS FROM WOLF RD TO LOCUST ST.

STAGE 4 TRAFFIC

EB US RTE 30 - CLOSE PASSING LANE, KEEPING DRIVING LANE OPEN. LEFT TURN LANES SHALL BE PROVIDED FOR ALL SIDE STREETS,

WB US RTE 30 - CLOSE PASSING LANE, KEEPING DRIVING LANE OPEN. LEFT TURN LANES SHALL BE PROVIDED FOR ALL SIDE STREETS.

SIDEROADS - ALL SIDEROADS ARE TO REMAIN OPEN.

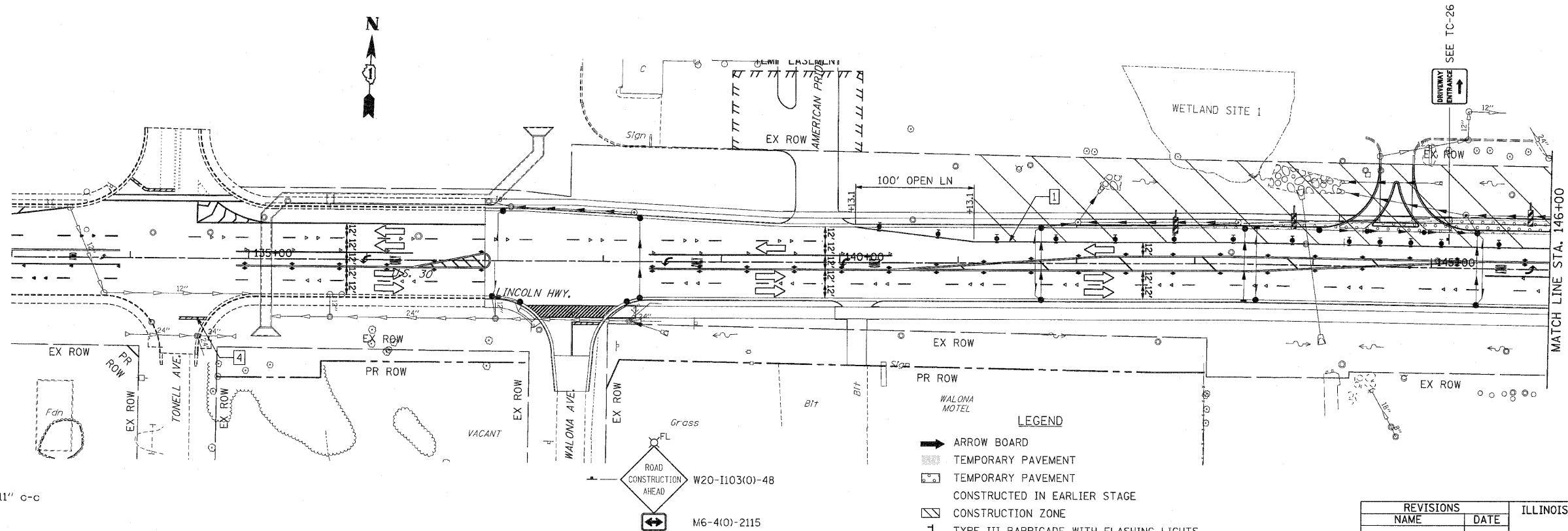

PAVEMENT MARKING KEY

- | | |
|---|-----------------------------|
| 1 | 4" SOLID - WHITE |
| 2 | 12" SOLID - YELLOW |
| 3 | 4" SOLID - YELLOW @ 11" c-c |
| 4 | 24" STOP BAR - WHITE |
| 5 | 12" SOLID - WHITE |
| 6 | 6" SOLID - WHITE |
| 7 | 6"-6'/2' DASH-WHITE |
| 8 | 4" SOLID - YELLOW |
| 9 | 4" 30'/10' DASH WHITE |

- LEGEND**
- ➔ ARROW BOARD
 - ▨ TEMPORARY PAVEMENT
 - ▤ TEMPORARY PAVEMENT CONSTRUCTED IN EARLIER STAGE
 - ▩ CONSTRUCTION ZONE
 - ⊥ TYPE III BARRICADE WITH FLASHING LIGHTS
 - ⊥ TYPE II BARRICADE
 - ⊥ DRUM OR VERTICAL BARRICADE
 - ➔ DIRECTION INDICATOR BARRICADE WITH STEADY BURN MONODIRECTIONAL LIGHT
 - ⊥^{FL} FLASHING LIGHT

REVISIONS		ILLINOIS DEPARTMENT OF TRANSPORTATION MAINTENANCE OF TRAFFIC STAGE 4 U.S. RTE. 30 (LINCOLN HIGHWAY) STA. 133+00 TO STA. 146+00 SCALE : 1" = 50' DATE : / /
NAME	DATE	