

F.A.P. RTE.	SECTION	COUNTY	TOTAL SHEETS	SHEET NO
353	(12&13)WRS-3	WILL	1235	192
STA. 202+00		TO STA. 230+00		
FED. ROAD DIST. NO.	ILLINOIS	FED. AID PROJECT		

CONTRACT NO. 62479

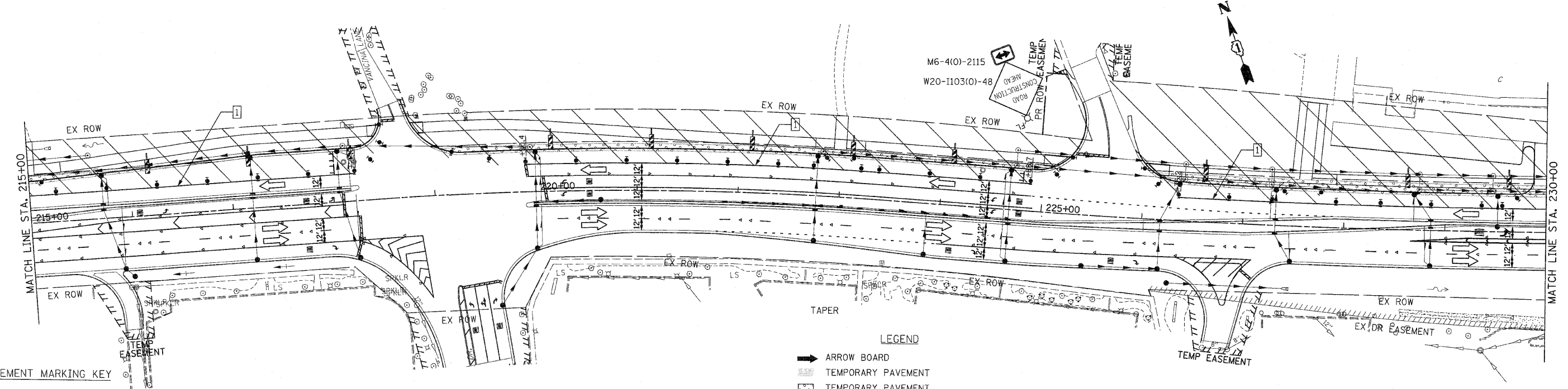
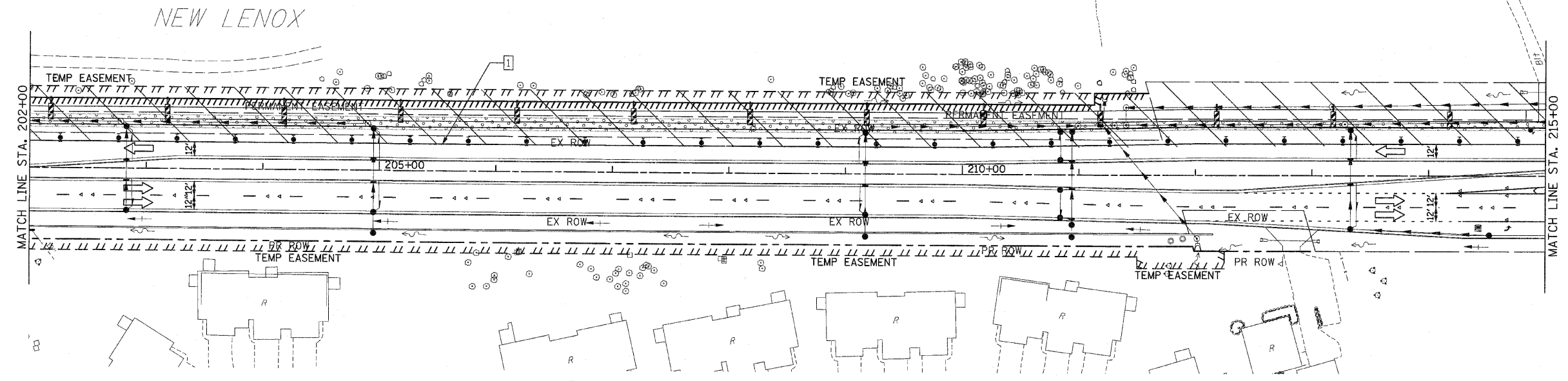

**PAVEMENT MARKING KEY**

1	4" SOLID - WHITE
2	12" SOLID - YELLOW
3	4" SOLID - YELLOW @ 11" C-C
4	24" STOP BAR - WHITE
5	12" SOLID - WHITE
6	6" SOLID - WHITE
7	6"-6'1/2' DASH-WHITE
8	4" SOLID - YELLOW
9	4" 30'/10' DASH WHITE

**LEGEND**

→	ARROW BOARD
▨	TEMPORARY PAVEMENT
▩	TEMPORARY PAVEMENT CONSTRUCTED IN EARLIER STAGE
▧	CONSTRUCTION ZONE
⊥	TYPE III BARRICADE WITH FLASHING LIGHTS
+	TYPE II BARRICADE
⊙	DRUM OR VERTICAL BARRICADE
↔	DIRECTION INDICATOR BARRICADE WITH STEADY BURN MONODIRECTIONAL LIGHT
⊗	FLASHING LIGHT

REVISIONS		ILLINOIS DEPARTMENT OF TRANSPORTATION
NAME	DATE	
		<b>MAINTENANCE OF TRAFFIC</b> STAGE 4 U.S. RTE. 30 (LINCOLN HIGHWAY) STA. 202+00 TO STA. 230+00 SCALE : 1" = 50' DATE : / / DRAWN BY : BAE CHECKED BY : GB