

F.A.P. RTE.	SECTION	COUNTY	TOTAL SHEETS	SHEET NO.
353	(12&13)WRS-3	WILL	1235	211
STA.		TO STA.		
FED. ROAD DIST. NO.	ILLINOIS	FED. AID PROJECT		
CONTRACT NO. 62479				

SIGN LEGEND

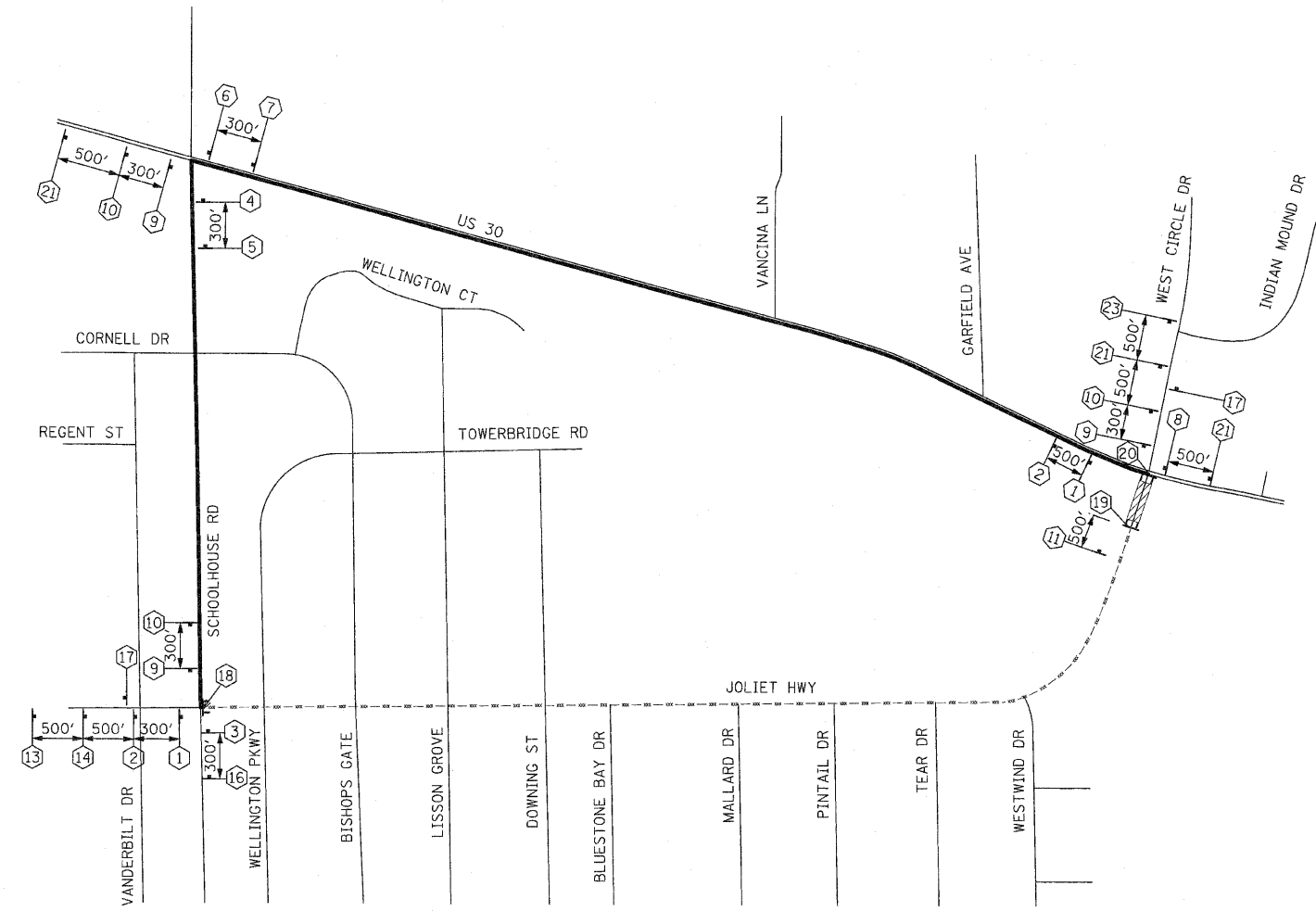

- 1 M4-8-2412
M3-1-2412
SEE DETAIL
M6-1L-2115
- 2 M4-8-2412
M3-1-2412
SEE DETAIL
M5-1L-2115
- 3 M4-8-2412
M3-1-2412
SEE DETAIL
M6-3-2115
- 4 M4-8-2412
M3-1-2412
SEE DETAIL
M6-1R-2115
- 5 M4-8-2412
M3-1-2412
SEE DETAIL
M5-1R-2115
- 6 M4-8-2412
M3-3-2412
SEE DETAIL
M6-1L-2115
- 7 M4-8-2412
M3-3-2412
SEE DETAIL
M5-1L-2115
- 8 M4-8-2412
M3-3-2412
SEE DETAIL
M6-3-2115
- 9 M4-8-2412
M3-3-2412
SEE DETAIL
M6-1R-2115
- 10 M4-8-2412
M3-3-2412
SEE DETAIL
M5-1R-2115
- 11 W20-3-4848
- 12 W20-3-4848
- 13 W20-3-4848
- 14 W20-2-4848
- 15 W20-3-4848
- 16 W20-2-4848
NORTH M3-1-2412
D3-3612 (BLACK ON ORANGE)
SOUTH M3-3-2412
D3-3612 (BLACK ON ORANGE)
- 17 M4-8A-2418
- 18 R11-4-6030
M4-10L-4818
MIN. 5 EACH
TYPE III BARRICADE
- 19 R11-2-4830
MIN. 5 EACH
TYPE III BARRICADE
- 20 R11-4-6030
M4-10R-4818
MIN. 5 EACH
TYPE III BARRICADE
- 21 W20-2-4848
NORTH M3-1-2412
D3-3612 (BLACK ON ORANGE)
SOUTH M3-3-2412
D3-3612 (BLACK ON ORANGE)
- 22 W20-3-4848
NORTH M3-1-2412
D3-3612 (BLACK ON ORANGE)
SOUTH M3-3-2412
D3-3612 (BLACK ON ORANGE)
- 23 W20-3-4848
NORTH M3-1-2412
D3-3612 (BLACK ON ORANGE)
SOUTH M3-3-2412
D3-3612 (BLACK ON ORANGE)

- LEGEND**
- DETOUR ROUTE
 - PARTIALLY CLOSED ROADWAY
 - COMPLETELY CLOSED ROADWAY
 - MAJOR STREET
 - MINOR STREET
 - TYPE A MONODIRECTIONAL FLASHING LIGHT
 - TYPE III BARRICADE
 - SIGN

JOLIET HIGHWAY
4" BLACK LETTERS ON ORANGE
REFLECTIVE BACKGROUND - 30" x 18"
SIGN DETAIL

REVISIONS		ILLINOIS DEPARTMENT OF TRANSPORTATION
NAME	DATE	
		DETOUR PLAN STAGE 2 JOLIET HWY. SCALE : 1" = NTS DRAWN BY : BEC DATE : / / CHECKED BY : GB